

SYSTEM RAMP CLOSED

As part of the Zoo Interchange project, the I-94 West to I-41/894 South system ramp remains closed through summer 2018. This system ramp will remain closed through summer 2018 due to another Wisconsin Department of Transportation project that includes the rehabilitation and restriping of I-41/894. During this closure, motorists are encouraged to utilize regional alternate routes when possible, in addition to the local alternate routes. The suggested alternate routes can be found below.

WESTBOUND TO SOUTHBOUND ALTERNATE ROUTES

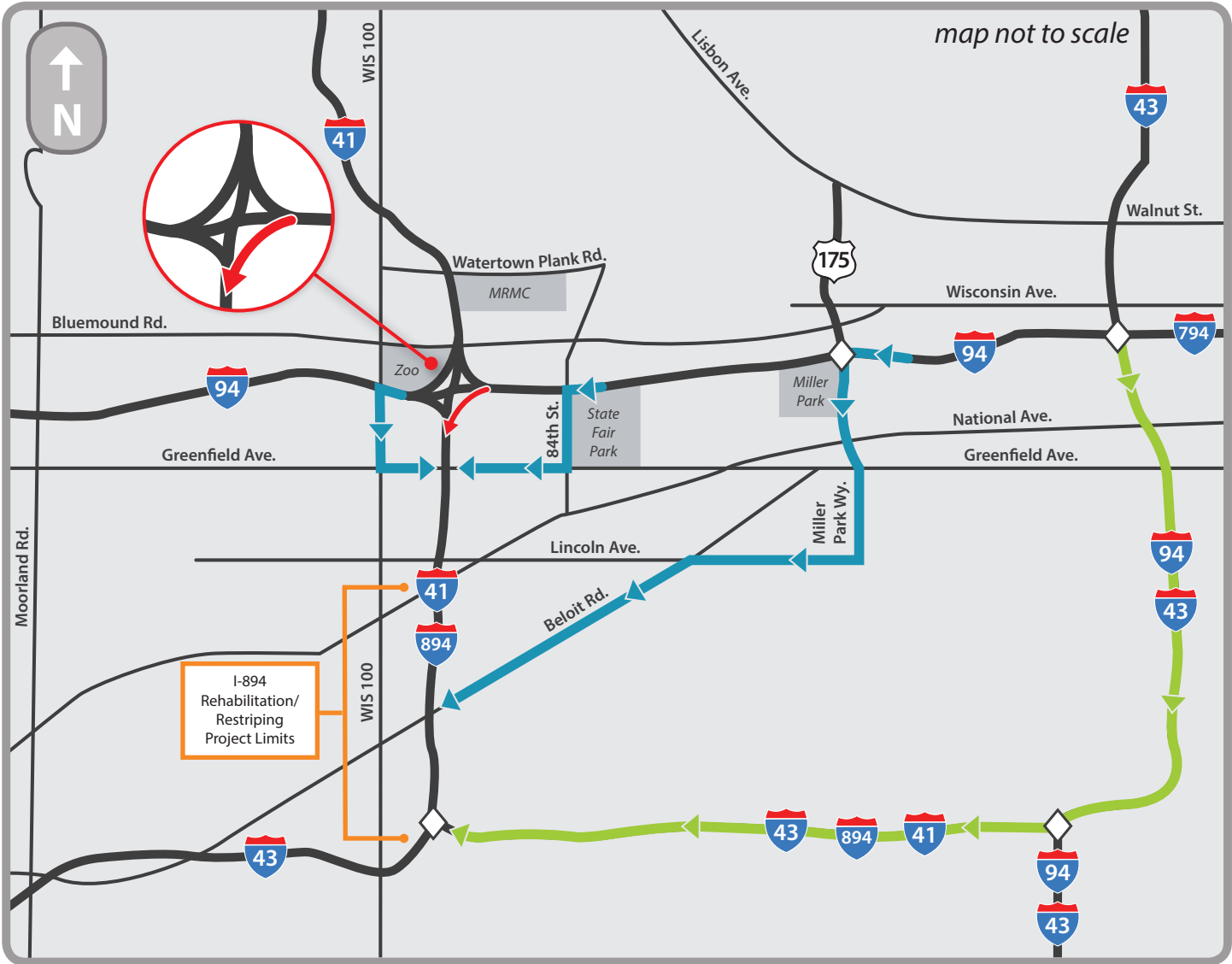

LOCAL ALTERNATE ROUTES

- I-94 West to 84th Street south to Greenfield Avenue west to I-41/894
- I-94 West to Miller Park Way south to Lincoln Avenue west to Beloit Road south west to I-41/894
- I-94 West to WIS 100 south to Greenfield Avenue east to I-41/894 (available beginning November 2017)

REGIONAL ALTERNATE ROUTE

- I-43/94 South to I-41/43/894 West

