



WIS 47

Duquaine Road to

County VV (North Junction)

Menominee County, Wisconsin
Construction Update

March 2021

Update Topics

- Project contacts
- Project location
- Proposed improvements
- Traffic impacts
- Construction schedule
- Native American hiring contact information
- How to stay informed



Project Contacts

- Stacy Hagenbucher– WisDOT Project Manager
 - Stacy.Hagenbucher@dot.wi.gov; 715-365-5770
- Kevin Lohff – Consultant Engineer
 - KevinL@JT-Engineering.com; 920-606-3176
- Prime Contractor
 - Larry Burkhart, James Peterson Sons, Inc.



Project Location

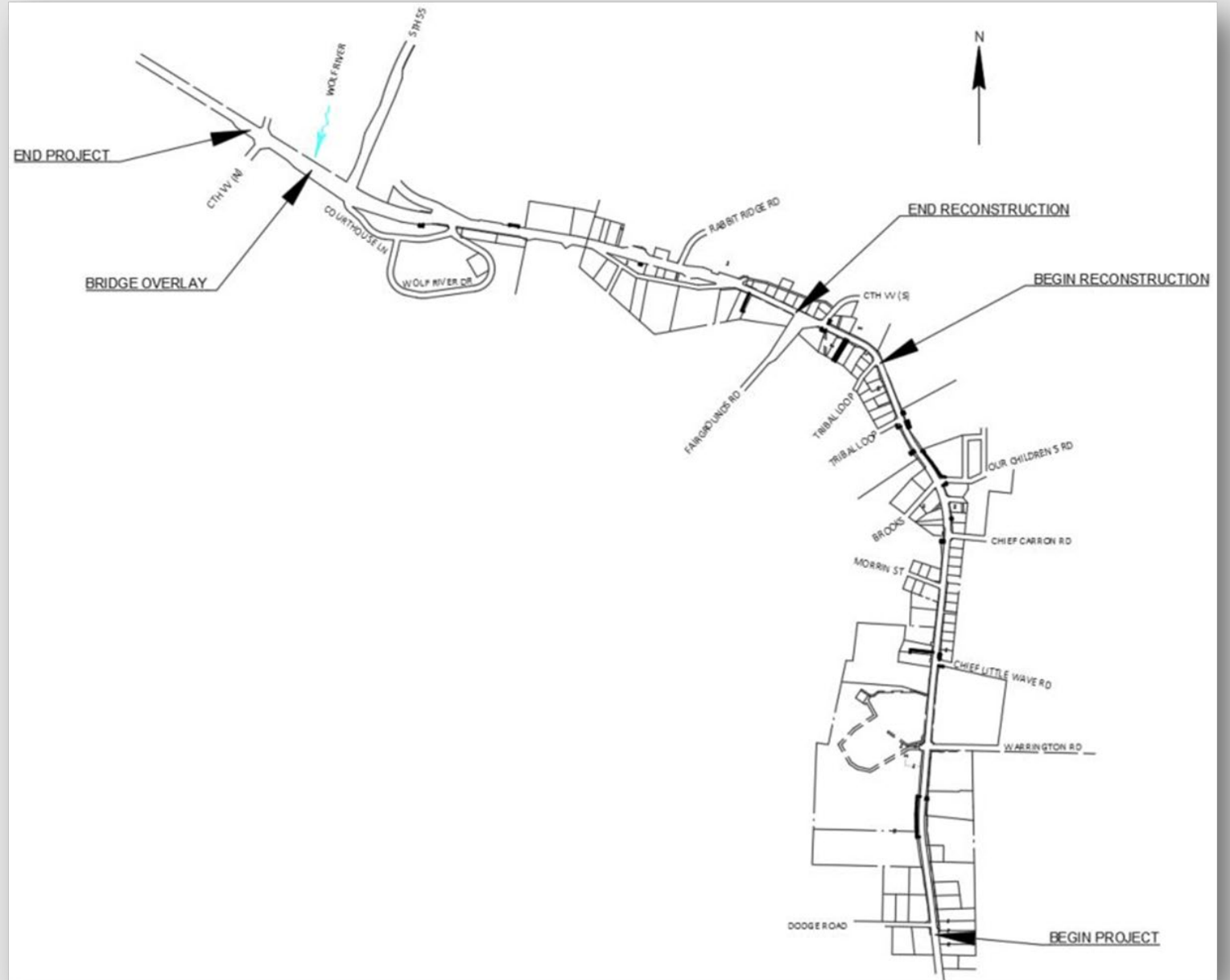

Proposed Improvements

- Scope of work includes:
 - Recondition WIS 47
 - Reconstruct between Tribal Loop (N) to Fairgrounds Road
 - New box culvert near County VV (S) intersection
 - Overlay on Wolf River Bridge
 - Improved turning radius at County VV (south)



Proposed Improvements

- Scope of work, continued:
 - Reconstruct all curb ramps to meet current ADA requirements
 - Curb & Gutter
 - Storm Sewer
 - Culvert Replacement
 - Guard Rail Replacement
 - Bike lanes
 - Sidewalk
 - Both sides from Duquaine Rd to Fairgrounds Rd
 - One side from Fairgrounds Rd to Oshkosh Rd (North Side)



Traffic Impacts

- Stage 1 Completed (2020)
 - County VV intersection & box culvert
- Stage 2 Wolf River Bridge Work
 - WIS 47 one lane open between County VV (N) and Courthouse Lane
 - Temporary traffic signals in use



Stage 2A: Temporary signals in use



Stage 2B: Temporary signals in use



Stage 3A: Flagging operation for culvert installation near Tribal Loop Rd (South Jct)



Stage 3A: Flagging operation for culvert installation near Tribal Loop Rd (South Jct)



Stage 3B Traffic Impacts

- Stage 3B
 - Construct WIS 47 southbound Lanes
 - Dodge Road to County VV (S)
 - WIS 47 NB closed
 - Detour (trucks) WIS 47 to US 45 to WIS 29
 - Detour (local) Go Around Road to County VV
 - WIS 47 Southbound stays open
 - Uses NB lane
 - Dodge Road, Tribal Loop Road (both) – Remain Open
 - Morrin Street & Brooks Lane will close – not at same time
 - High School Entrance remains open (built in halves)



Stage 3B: Local Detour

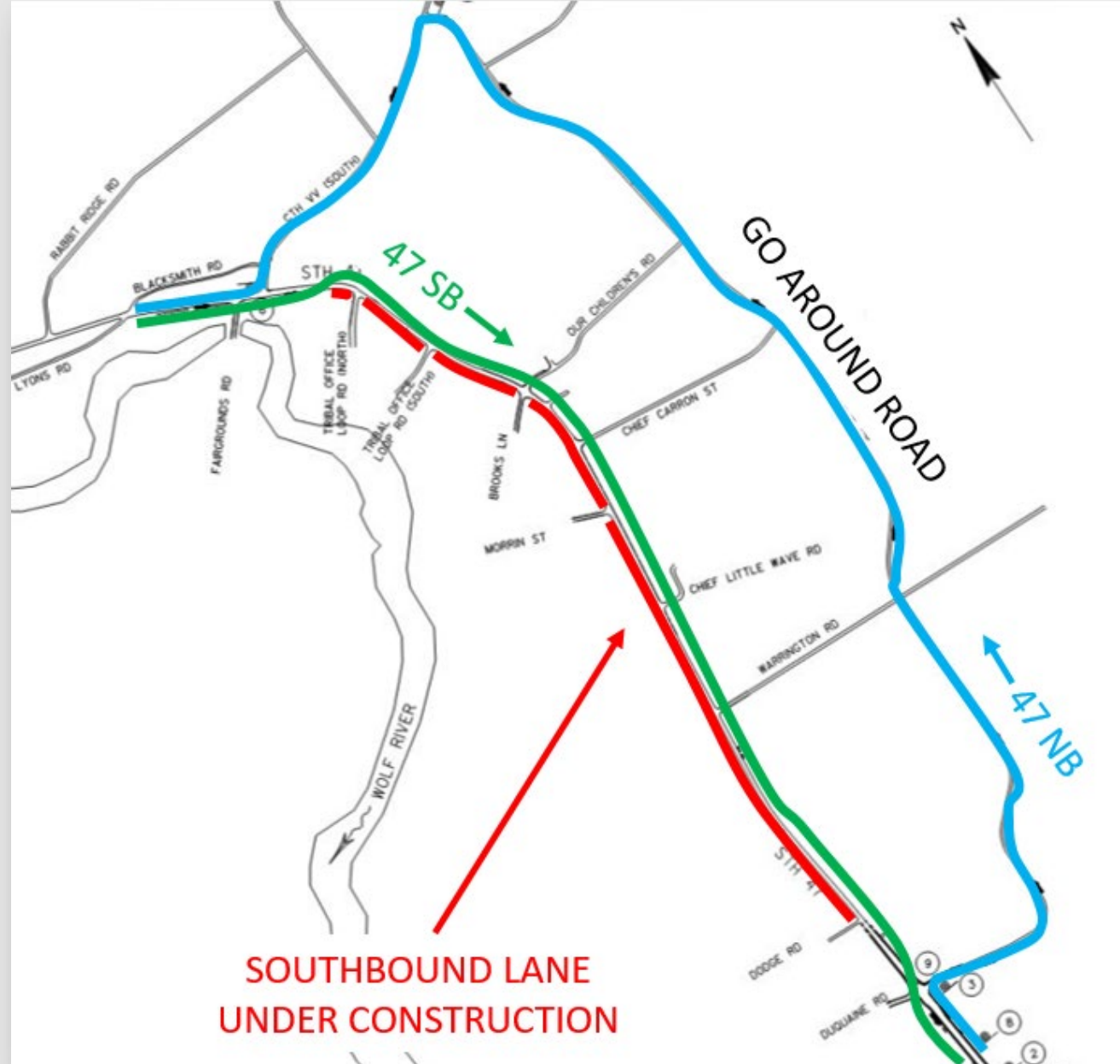

Stage 3B: Truck Detour

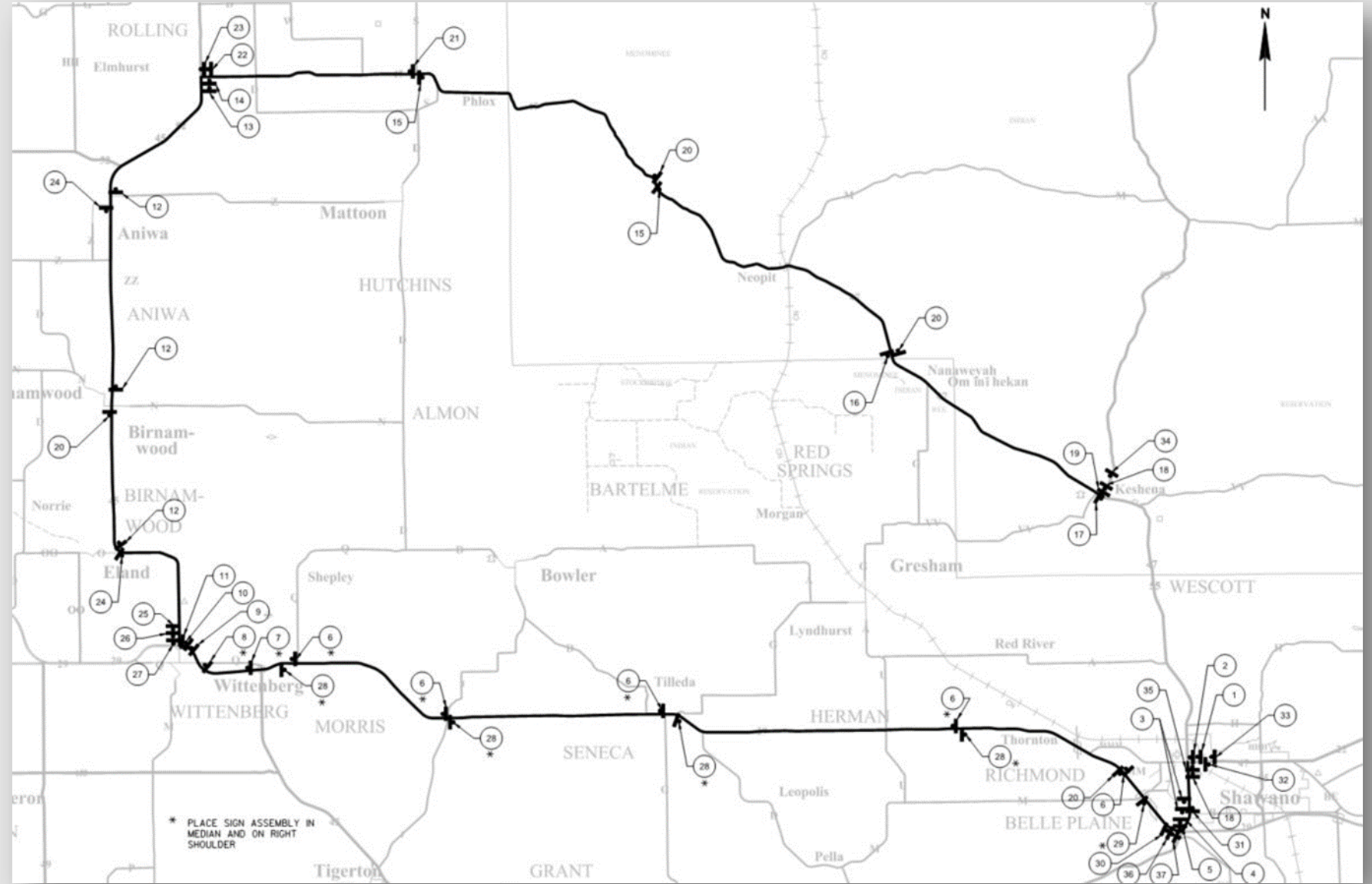

Stage 4 Traffic Impacts

- Stage 4
 - Construct WIS 47 Northbound Lanes
 - Dodge Road to County VV (S)
 - WIS 47 NB remains Closed
 - Detour (trucks) WIS 47 to US 45 to WIS 29
 - Detour (local) Go Around Road to County VV
 - WIS 47 Southbound Stays Open
 - Uses new SB lanes
 - Brief side road closures (not consecutive roads)



Stage 4A: Local Detour



Stage 5A Traffic Impacts

■ Stage 5A

- Three culvert crossings between Rabbit Ridge Road and WIS 55
- Temporary traffic signals in use



Stage 5B Traffic Impacts

■ Stage 5B

- Construct WIS 47 NB lane between County VV (S) and Oshkosh Road
- WIS 47 will remain open to one lane via flagging operations
- County VV (South Junction) & WIS 55 will remain open
- Sideroads closed this stage
 - Blacksmith Road
 - Rabbit Ridge Road
 - Oshkosh Road



Stage 5B Traffic Impacts

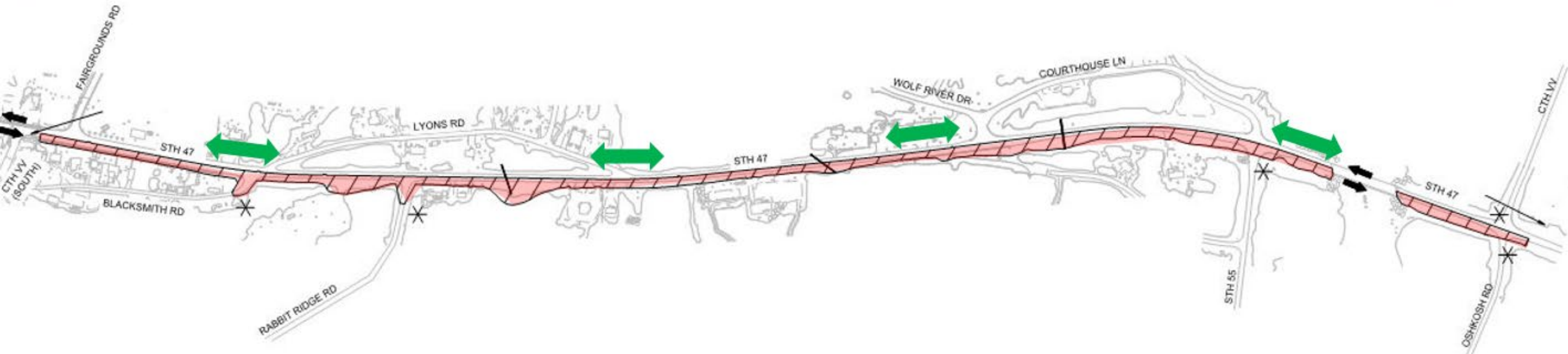

Stage 6 Traffic Impacts

■ Stage 6

- Construct WIS 47 SB lane between County VV (S) and Oshkosh Road
- WIS 47 will remain open to one lane via flagging operations
- County VV (North Junction) will remain open
- Sideroads closed this stage
 - Lyons Road (S) closure will alternate with Lyons Road (N)
 - Courthouse Road closure will alternate with Wolf River Drive



Stage 6

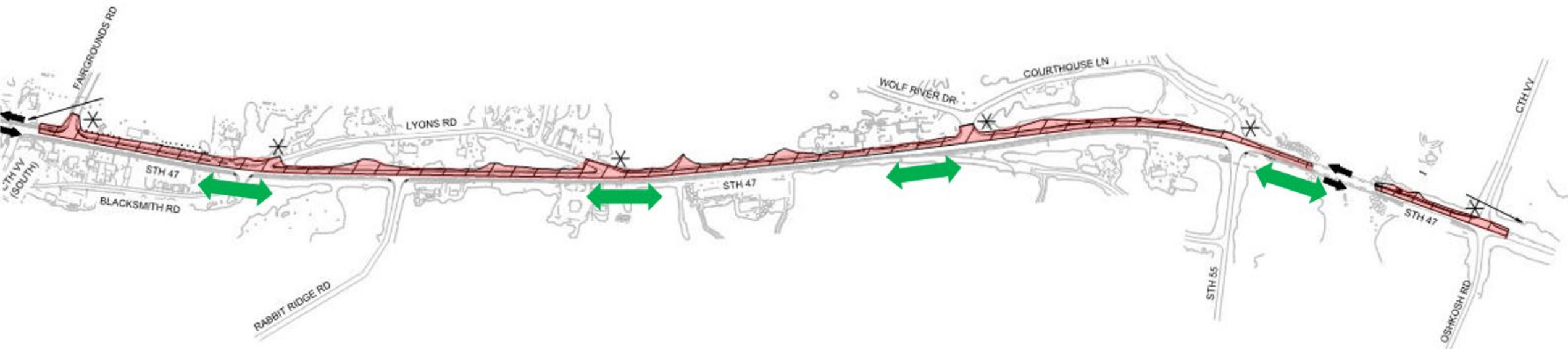

Construction Schedule

Construction Resumes: April 2021

Anticipated Completion: November 2021

Holiday Restrictions (No work/hauling allowed)

- From noon Friday, May 21, 2021 to 6 a.m. Monday, May 24, 2021
 - Veterans Pow-wow
- From noon Friday, May 28, 2021 to 6 a.m. Tuesday, June 1, 2021
 - Memorial Day
- From noon Friday, July 2, 2021 to 6 a.m. Tuesday, July 6, 2021
 - Independence Day
- From noon Friday, August 6, 2021 to 6 a.m. Monday, August 9, 2021
 - Menominee Nation Contest Pow-wow
- From noon Friday, September 3, 2021 to 6 a.m. Tuesday, September 7, 2021
 - Labor Day



Native American Hiring Contact Information

- Menominee Indian Tribe of Wisconsin Labor Office
 - Nicole Fish
 - N559 Library Road, PO Box 910, Keshena, WI 54135
 - Phone: (715) 799-5171
 - Email: nfish@mitw.org



How to stay informed

- **Emails from Project Staff**
 - Contact: Kevin Lohff, Consultant Engineer
 - KevinL@JT-Engineering.com; 920-606-3176
- **Weekly Construction Update**
 - <https://projects.511wi.gov/weeklyupdates-nc/>
 - Released by end of week, every Friday
 - Best source of information regarding changes in Traffic Impacts and Stages
- **Project Website**
 - <https://projects.511wi.gov/wis47menominee/>
 - Updated weekly

