

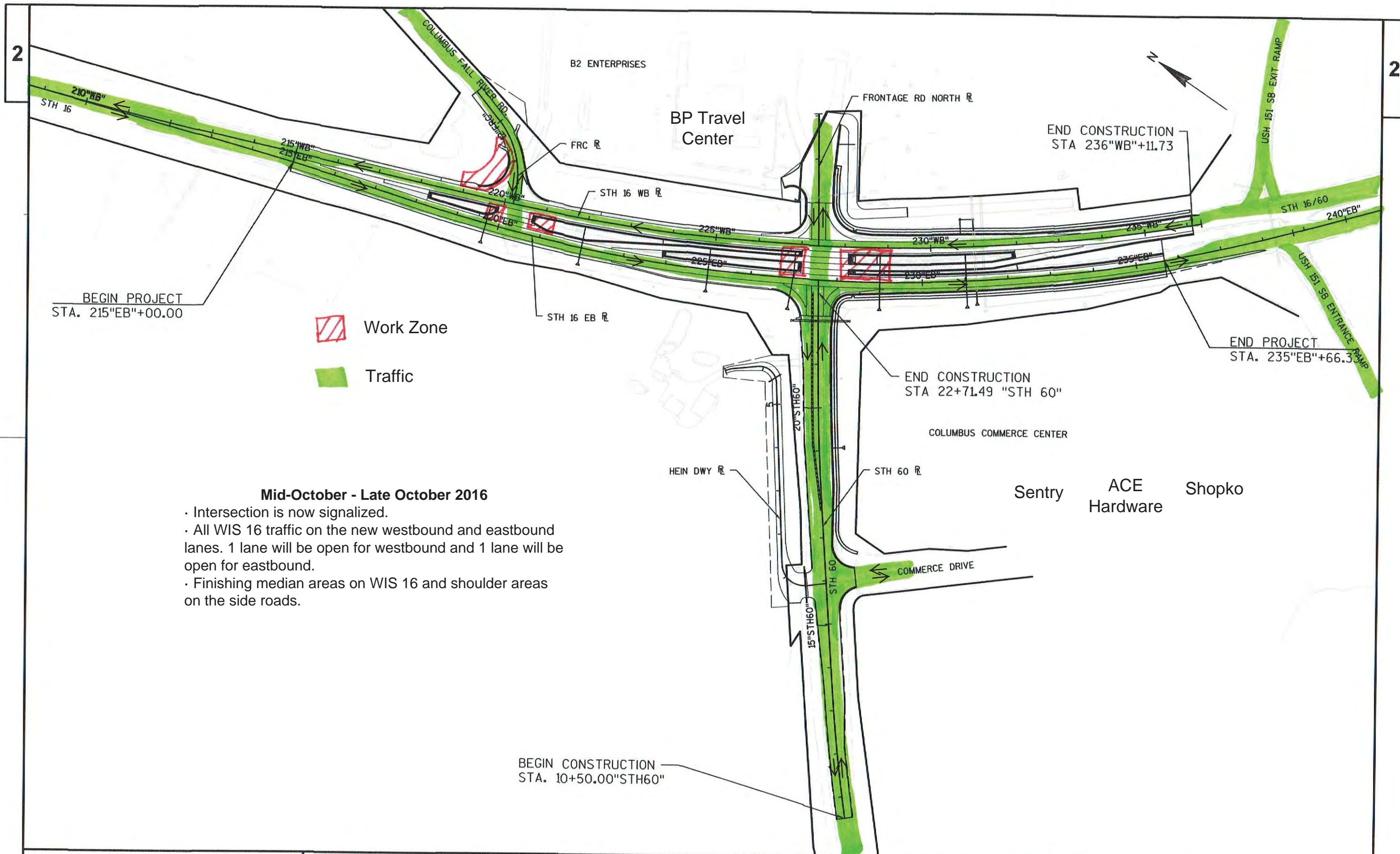

# MID-OCTOBER - LATE OCTOBER 2016



BEGIN PROJECT  
STA. 215"EB"+00.00

 Work Zone  
 Traffic

- Mid-October - Late October 2016**
- Intersection is now signaled.
  - All WIS 16 traffic on the new westbound and eastbound lanes. 1 lane will be open for westbound and 1 lane will be open for eastbound.
  - Finishing median areas on WIS 16 and shoulder areas on the side roads.

BEGIN CONSTRUCTION  
STA. 10+50.00"STH60"