

# EARLY SEPTEMBER - MID-OCTOBER 2016

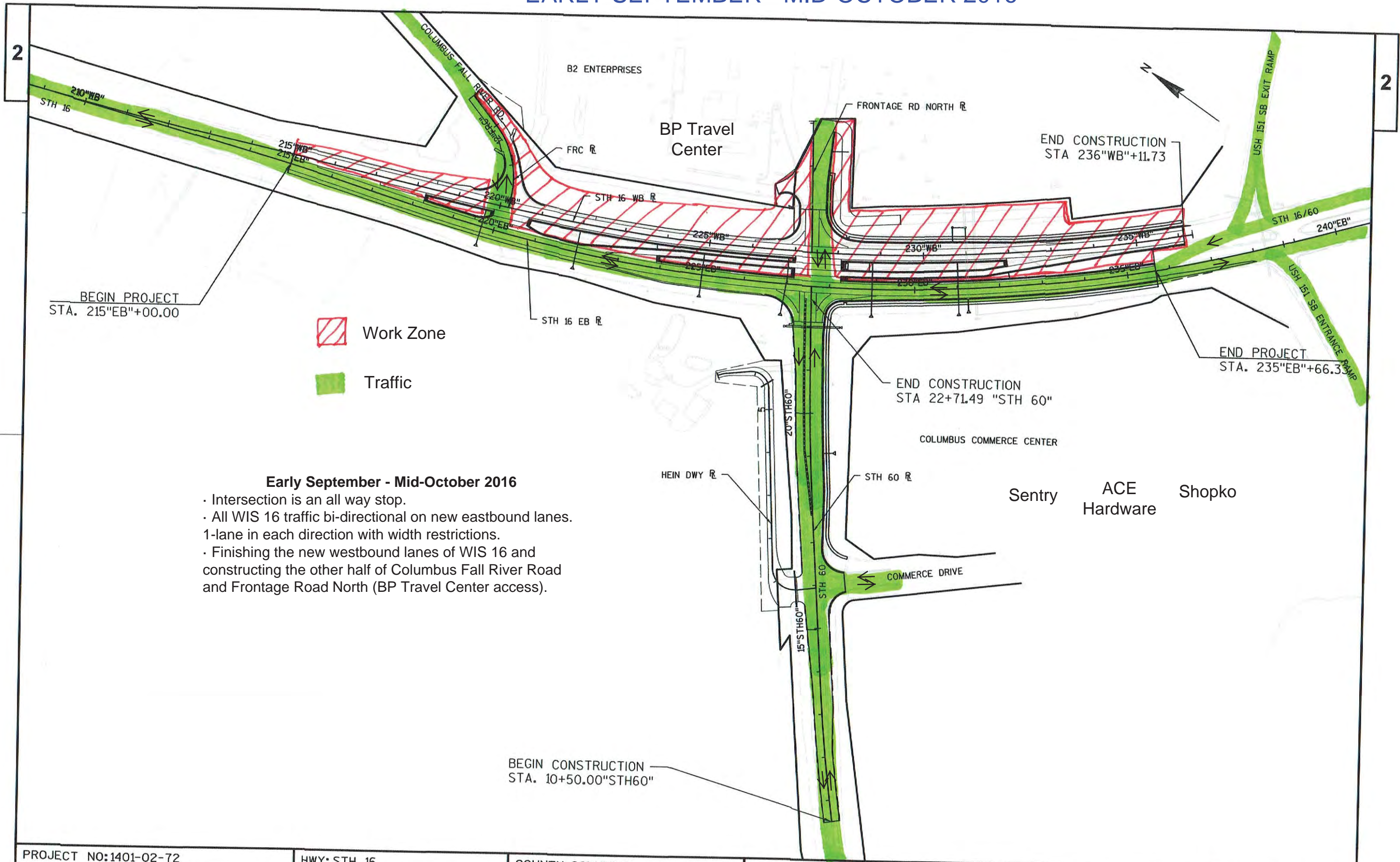

- Work Zone
- Traffic

### Early September - Mid-October 2016

- Intersection is an all way stop.
- All WIS 16 traffic bi-directional on new eastbound lanes. 1-lane in each direction with width restrictions.
- Finishing the new westbound lanes of WIS 16 and constructing the other half of Columbus Fall River Road and Frontage Road North (BP Travel Center access).

BEGIN CONSTRUCTION  
STA. 10+50.00"STH60"

PROJECT NO:1401-02-72

HWY: STH 16

COUNTY: COLUMBIA

PROJECT OVERVIEW

SHEET 3

E

FILE NAME : J:\ACTIVE\SW\1401-02-02\CAD\14010202\SHEETSPLAN\020201\_PO.DWG

PLOT DATE : 10/29/2015 9:29 PM

PLOT BY : KEVIN KEAST

PLOT NAME :

PLOT SCALE : 1" = 200' .XREF

WISDOT/CADD SHEET 42