

EARLY AUGUST - EARLY SEPTEMBER 2016 (5-6 WEEKS)

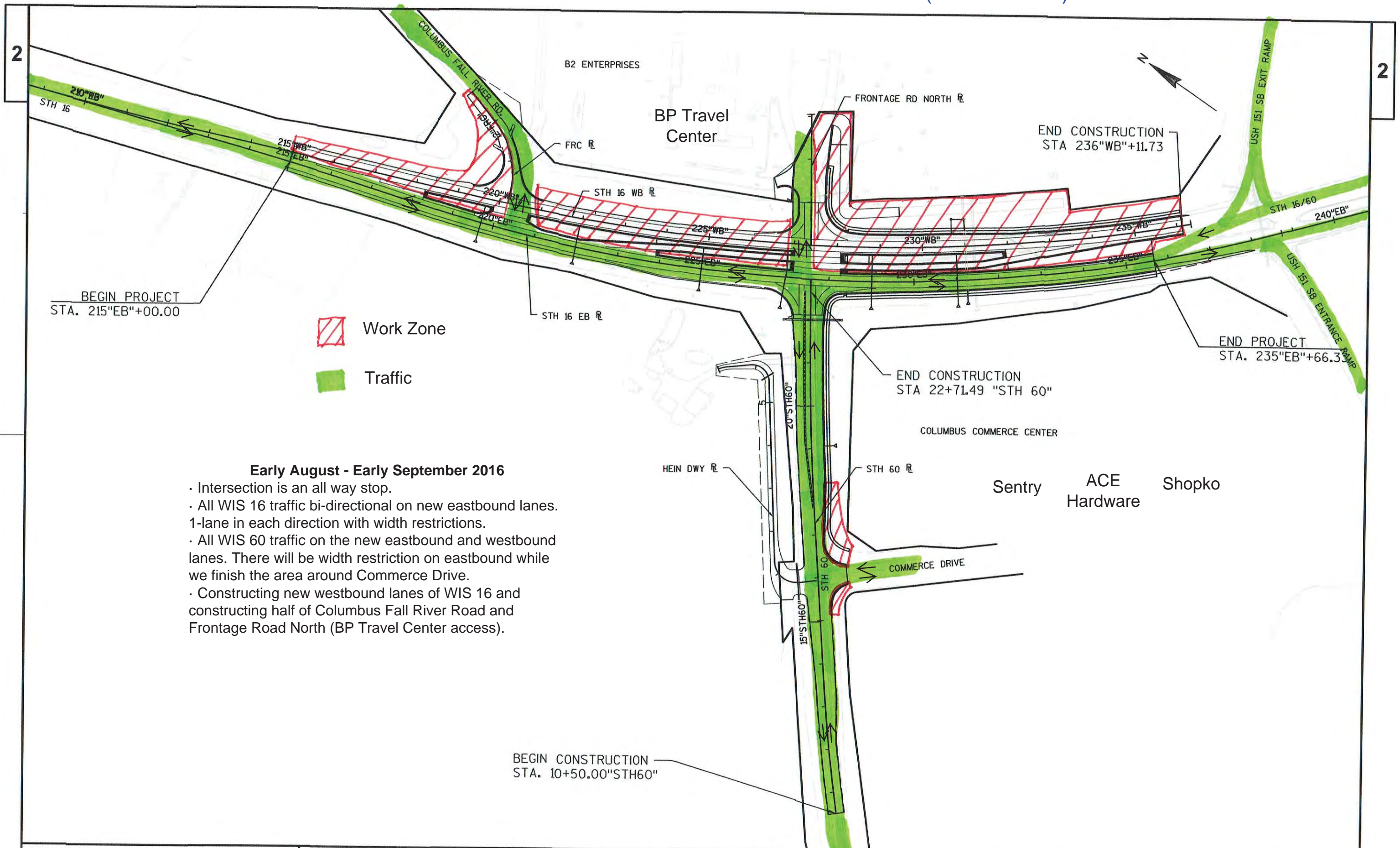

Work Zone
 Traffic

- Early August - Early September 2016**
- Intersection is an all way stop.
 - All WIS 16 traffic bi-directional on new eastbound lanes. 1-lane in each direction with width restrictions.
 - All WIS 60 traffic on the new eastbound and westbound lanes. There will be width restriction on eastbound while we finish the area around Commerce Drive.
 - Constructing new westbound lanes of WIS 16 and constructing half of Columbus Fall River Road and Frontage Road North (BP Travel Center access).