

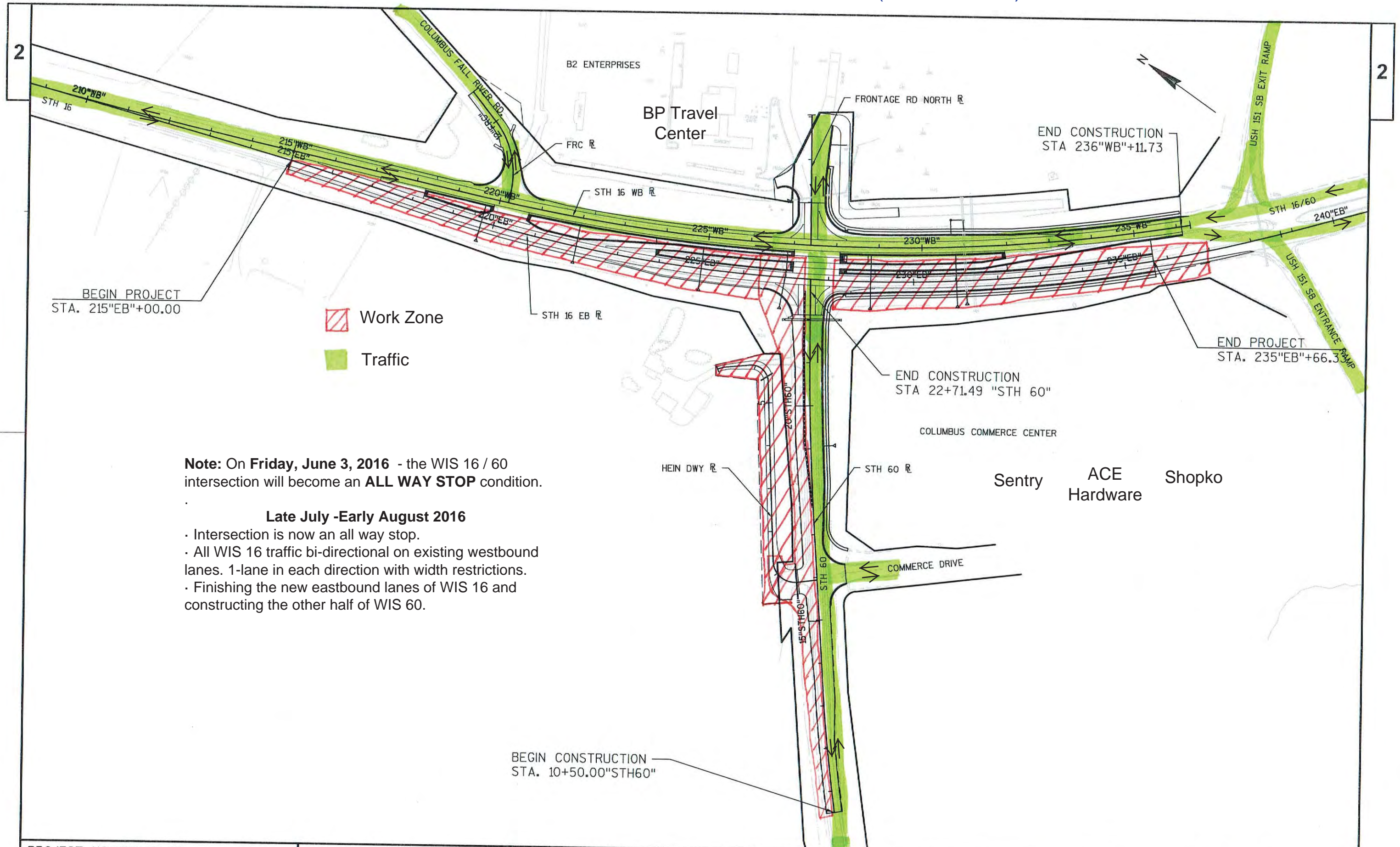

# LATE JULY - EARLY AUGUST 2016 (2-3 WEEKS)



BEGIN PROJECT  
STA. 215"EB"+00.00

 Work Zone  
 Traffic

**Note:** On Friday, June 3, 2016 - the WIS 16 / 60 intersection will become an **ALL WAY STOP** condition.

**Late July -Early August 2016**

- Intersection is now an all way stop.
- All WIS 16 traffic bi-directional on existing westbound lanes. 1-lane in each direction with width restrictions.
- Finishing the new eastbound lanes of WIS 16 and constructing the other half of WIS 60.

BEGIN CONSTRUCTION  
STA. 10+50.00"STH60"

PROJECT NO:1401-02-72

HWY: STH 16

COUNTY: COLUMBIA

PROJECT OVERVIEW

SHEET

E

FILE NAME : J:\ACTIVE\SW\1401-02-02\CAD\14010202\SHEETS\PLAN\020201\_PO.DWG

PLOT DATE : 10/29/2015 9:29 PM

PLOT BY : KEVIN KEAST

PLOT NAME :

PLOT SCALE : 1" = 200' XREF

WISDOT/CADDS SHEET 42