

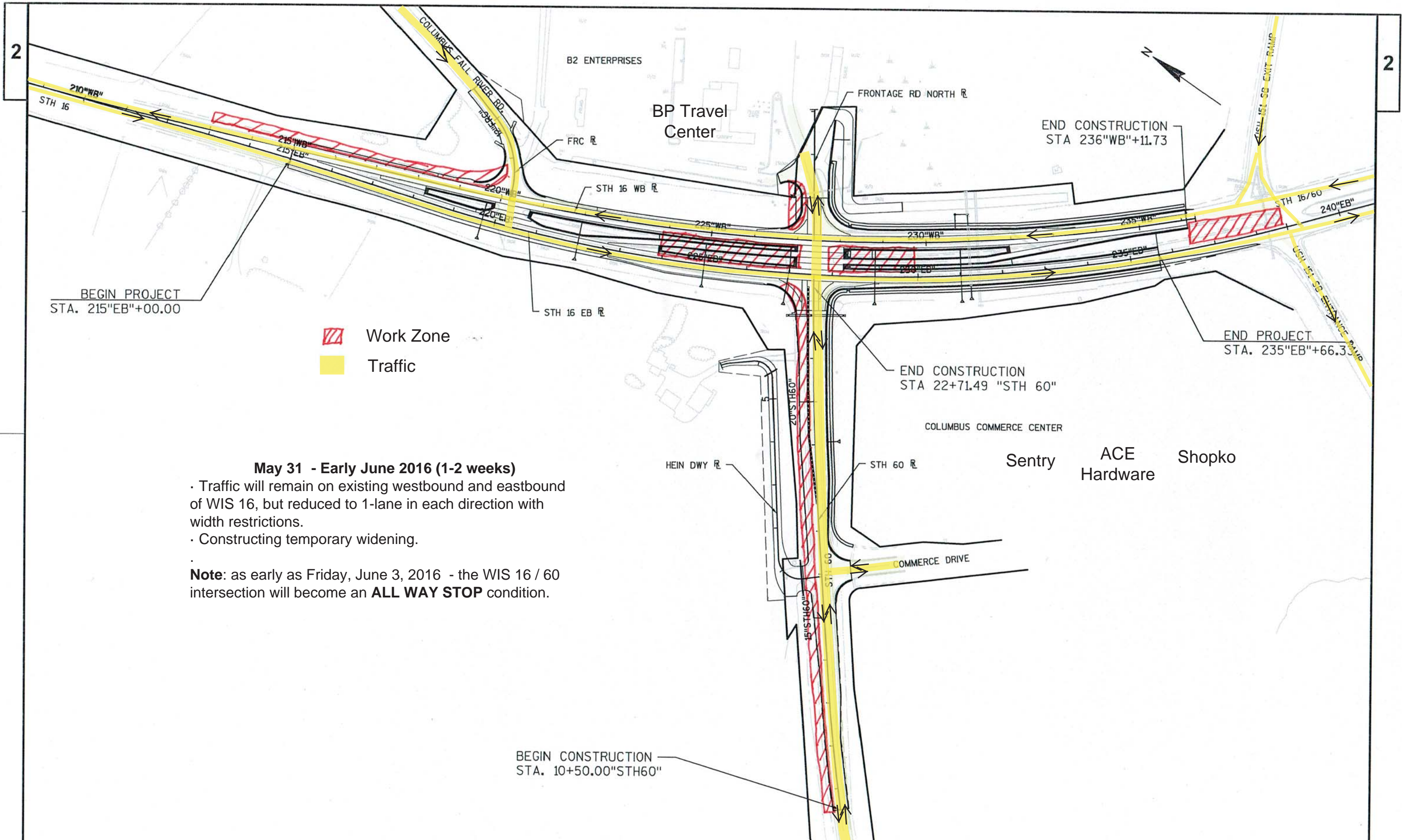

MAY 31 - EARLY JUNE 2016 (1-2 WEEKS)



BEGIN PROJECT
STA. 215"EB"+00.00

 Work Zone
 Traffic

May 31 - Early June 2016 (1-2 weeks)

- Traffic will remain on existing westbound and eastbound of WIS 16, but reduced to 1-lane in each direction with width restrictions.
- Constructing temporary widening.

Note: as early as Friday, June 3, 2016 - the WIS 16 / 60 intersection will become an **ALL WAY STOP** condition.

BEGIN CONSTRUCTION
STA. 10+50.00"STH60"