

# USH 12 ROUNDABOUT PLANTING CONCEPTS

## WIS 136 - Concept A Plan

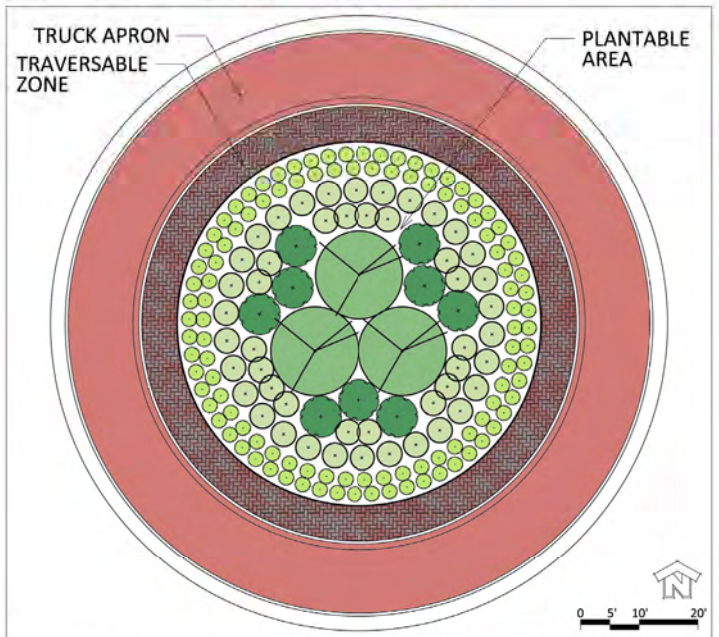

- LEGEND**
- Multi-stem Tree
  - Large Shrub
  - Medium Shrub
  - Small Shrub

**PLANT PALETTE**

Common Name	Scientific Name	Mature Size	Description
<b>Multi-stemmed Ornamental Trees</b>			
Sensibility, Princess Diana (Multi-stem)	<i>Amelanchier x grandiflora 'Princess Diana'</i>	20-25' ht x 15-20' sp	Graceful, spreading habit; prolific white flowers; purple fruit; brilliant red fall color
Hawthorn, Winter King (Multi-stem)	<i>Crataegus viridis 'Winter King'</i>	25-30' ht x 25-30' sp	Rounded, vase shaped habit; white flowers; reddish purple fall color; red fruit
Cornusop, Donald Wyman (Multi-stem)	<i>Malus 'Donald Wyman'</i>	15-20' ht x 15-20' sp	White flowers; single red fruit
Amur Chokeberry (Multi-stem)	<i>Prunus maackii</i>	20-30' ht x 18-25' sp	Graceful, open habit; exfoliating copper bark; fragrant white flowers; yellow fall color
<b>Evergreen Shrubs</b>			
Juniper, bush	<i>Juniperus chinensis 'Sova'</i>	8-10' ht x 4-5' sp	Upright, informal (loose branching) habit with coarse blue-green foliage
Juniper, 'Kallay's Compact'	<i>Juniperus x pfitzeriana 'Kallay's Compact'</i>	2-3' ht x 1-4' sp	Dwarf juniper with horizontally spreading branches and a somewhat flat top
<b>Tall Ornamental Shrubs</b>			
Burning Bush, 'Chicago Fire'	<i>Euonymus alatus 'Timber Creek'</i>	8-10' ht x 8-10' sp	Excellent dense branching and upright form; bright red fall color
Viburnum Arrowwood, Indian Summer	<i>Viburnum dentatum 'Indian Summer'</i>	8-12' ht x 8-12' sp	Rounded, open form; white flowers; blue fruit; red-orange-burgundy fall color
<b>Intermediate Ornamental Shrubs</b>			
Chokeberry, Glossy Black, Autumn Magic	<i>Aronia melanocarpa 'Autumn Magic'</i>	3-5' ht x 1-4' sp	Upright, compact form; white flowers; bright red fruit; bright red fall color
Mockorange, Bouquet Blanc	<i>Philadelphus x cymosus 'Bouquet Blanc'</i>	5-6' ht x 1-4' sp	Upright, arching branches with large white flowers in spring
<b>Small Ornamental Shrubs</b>			
Spiraea, Bitchief	<i>Spiraea betulifolia 'Tor'</i>	2' ht x 2' sp	Compact form; white flowers; bright red fruit; red to copper fall color
St. John's Wort, Kater's	<i>Hypericum 'Kalmianum Amel'</i>	2-3' ht x 1-3' sp	Compact form; yellow flowers; brown seed capsules
<b>Ornamental Grasses</b>			
Feather Reed Grass, Karl Foerster	<i>Calamagrostis acutiflora 'Karl Foerster'</i>	30-40" ht x 18-24" sp	Upright ornamental grass with buff colored vertical seedheads in summer/fall
Switchgrass, Heavy Metal	<i>Panicum virgatum 'Heavy Metal'</i>	48-60" ht x 12-24" sp	Upright grass with metallic blue foliage and strong, upright habit; foliage turns yellow to tan in fall/winter; seedheads are attractive to birds
Switchgrass, Shenandoah	<i>Panicum virgatum 'Shenandoah'</i>	24-30" ht x 24-30" sp	Columnar ornamental grass with burgundy color foliage turns beige in winter
Little Bluestem, The Blues	<i>Schizachyrium scoparium 'The Blues'</i>	24-30" ht x 18"-24" sp	Upright native bluestem with foliage color range accented blues and purples



## WIS 136 - Concept A Elevation

## WIS 136 - Concept B Plan

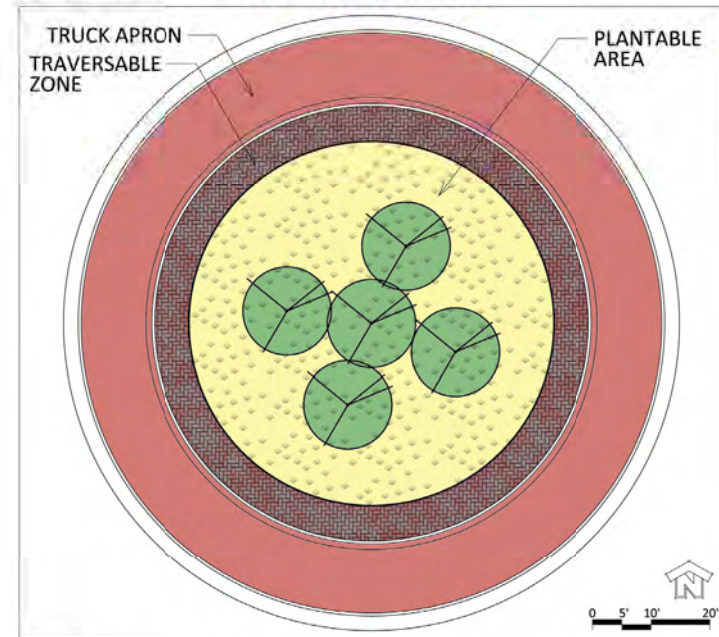

- LEGEND**
- Multi-stem Tree
  - Grass Groundcover

**PLANT PALETTE**

Common Name	Scientific Name	Mature Size	Description
<b>Multi-stemmed Ornamental Trees</b>			
Hawthorn, Winter King (Multi-stem)	<i>Crataegus viridis 'Winter King'</i>	25-30' ht x 25-35' sp	Rounded, vase-shaped habit; white flowers; reddish purple fall color; red fruit
Cornusop, Donald Wyman (Multi-stem)	<i>Malus 'Donald Wyman'</i>	15-20' ht x 15-20' sp	White flowers; bright red fruit
<b>Native Grasses</b>			
Little Bluestem	<i>Schizachyrium scoparium</i>	24-30" ht x 18"-24" sp	Upright native bluestem with foliage color range accented oranges and reds in fall



## WIS 136 - Concept B Elevation



# USH 12 ROUNDABOUT PLANTING CONCEPTS

## CTH W - Concept A Plan

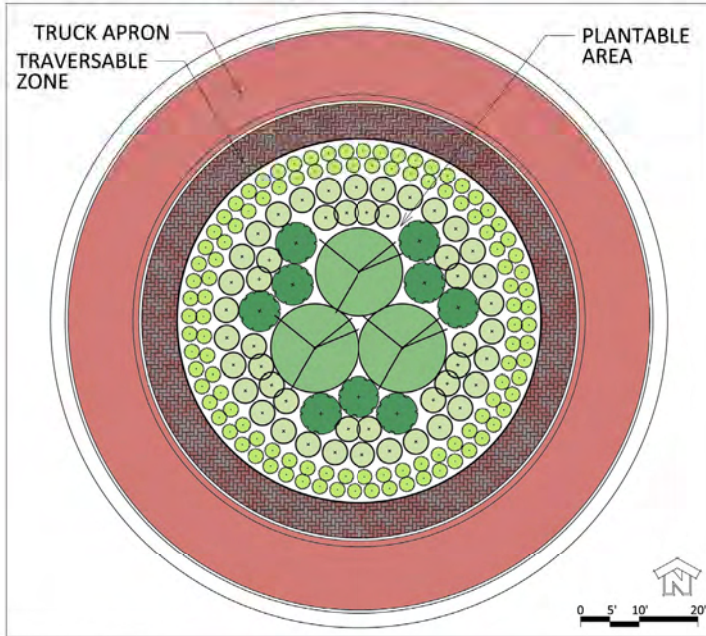

- LEGEND**
- Multi-stem Tree
  - Large Shrub
  - Medium Shrub
  - Small Shrub

**PLANT PALETTE**

Common Name	Scientific Name	Mature Size	Description
<b>Multi-Stemmed Ornamental Trees</b>			
Hawthorn, Cockspur (Multistem)	<i>Crataegus crus-galli</i> var. <i>inermis</i>	20-30' H x 20-30' sp	White flower, bright red fruit
Crabapple, Prairiefire (Multistem)	<i>Malus Prairiefire</i>	20' H x 20' sp	Coral-red flowers, red-purple fruit
Viburnum, Blackhaw (Multistem)	<i>Viburnum prunifolium</i>	12-15' H x 8-12' sp	Broad form, white clusters of flowers, bluish-black fruit, purple-red fall color
<b>Evergreen Shrubs</b>			
Juniper, Sora	<i>Juniperus chinensis 'Sora'</i>	8-10' H x 4-5' sp	Upright, informal (loose branching) habit with coarse blue-green foliage
Juniper, Kallay's Compact	<i>Juniperus x pfitzeriana 'Kallay's Compact'</i>	2-3' H x 3-6' sp	Dwarf juniper with horizontally spreading branches and a somewhat flat top
<b>Tall Ornamental Shrubs</b>			
Amur Maple, Compact	<i>Acer ginnala 'Compactum'</i>	6-10' H x 6-10' sp	Dense and compact with orange to red fall color
Ninebark, Double	<i>Physocarpus opulifolius 'Morton'</i>	10' H x 8' sp	Purple-leaved selection, pink buds and white flowers
<b>Intermediate Ornamental Shrubs</b>			
Ninebark, Common	<i>Physocarpus opulifolius</i>	6-8' H x 6-8' sp	Upright, spreading shrub, large white flowers, reddish green fall color
Chokeberry, Glossy Black 'Autumn Magic'	<i>Aronia melanocarpa 'Autumn Magic'</i>	3-5' H x 3-4' sp	Upright, compact form, white flowers, bright red fruit, bright red fall color
<b>Small Ornamental Shrubs</b>			
Burns, Dinky Fragrant	<i>Rhus aromatica 'Glo-low'</i>	2-3' H x 5-6' sp	Compact form, white flower, bright red fruit, red fall color
Chokeberry, Gloss Black 'Morton'	<i>Aronia melanocarpa 'Innocent Beauty'</i>	2-3' H x 2-3' sp	Compact form, white flower, bright red fruit, red fall color
<b>Ornamental Grasses</b>			
Bluegrass, Shemenoosh	<i>Panicum virgatum 'Shemenoosh'</i>	24-30" H x 24-30" sp	Columnar ornamental grass with burgandy color, foliage turns beige in winter
Lite Bluestem, The Blues	<i>Schizachyium scoparium 'The Blues'</i>	24-30" H x 18"-24" sp	Upright native bluestem with foliage color range accenting blues and purples



## CTH W - Concept A Elevation

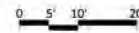

## CTH W - Concept B Plan

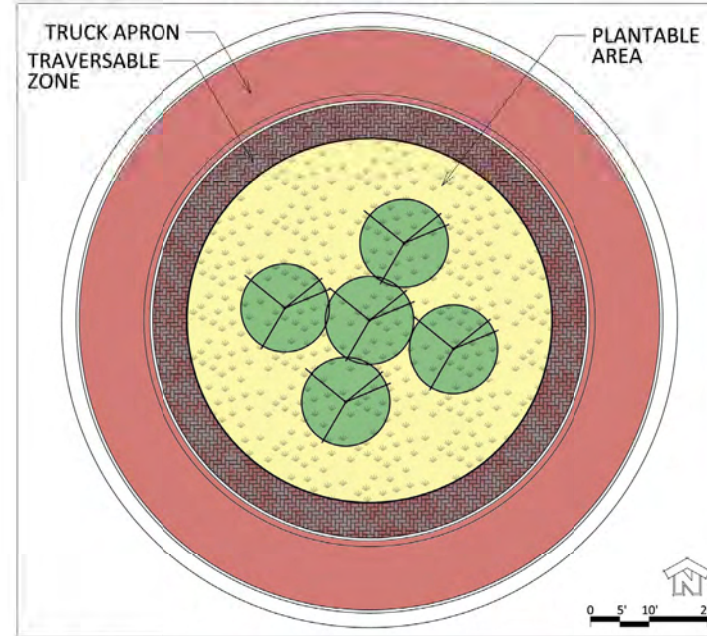

- LEGEND**
- Multi-stem Tree
  - Grass Groundcover

**PLANT PALETTE**

Common Name	Scientific Name	Mature Size	Description
<b>Multi-Stemmed Ornamental Trees</b>			
Hawthorn, Cockspur (Multistem)	<i>Crataegus crus-galli</i> var. <i>inermis</i>	20-30' H x 20-30' sp	White flower, bright red fruit
Crabapple, Prairiefire (Multistem)	<i>Malus Prairiefire</i>	20' H x 20' sp	Coral-red flowers, red-purple fruit
Viburnum, Blackhaw (Multistem)	<i>Viburnum prunifolium</i>	12-15' H x 8-12' sp	Broad form, white clusters of flowers, bluish-black fruit, purple-red fall color
<b>Native Grass Groundcover</b>			
Sideoats Grass	<i>Bouteloua curtipendula</i>	24-36" H x 12"-18" sp	Native grass with oat-like seed spikes, golden brown to reddish in fall

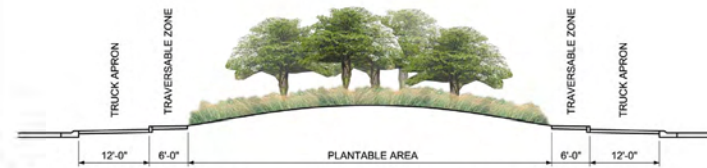

## CTH W - Concept B Elevation

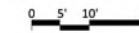



# USH 12 LEHMAN FRONTAGE ROAD BERM PLANTING

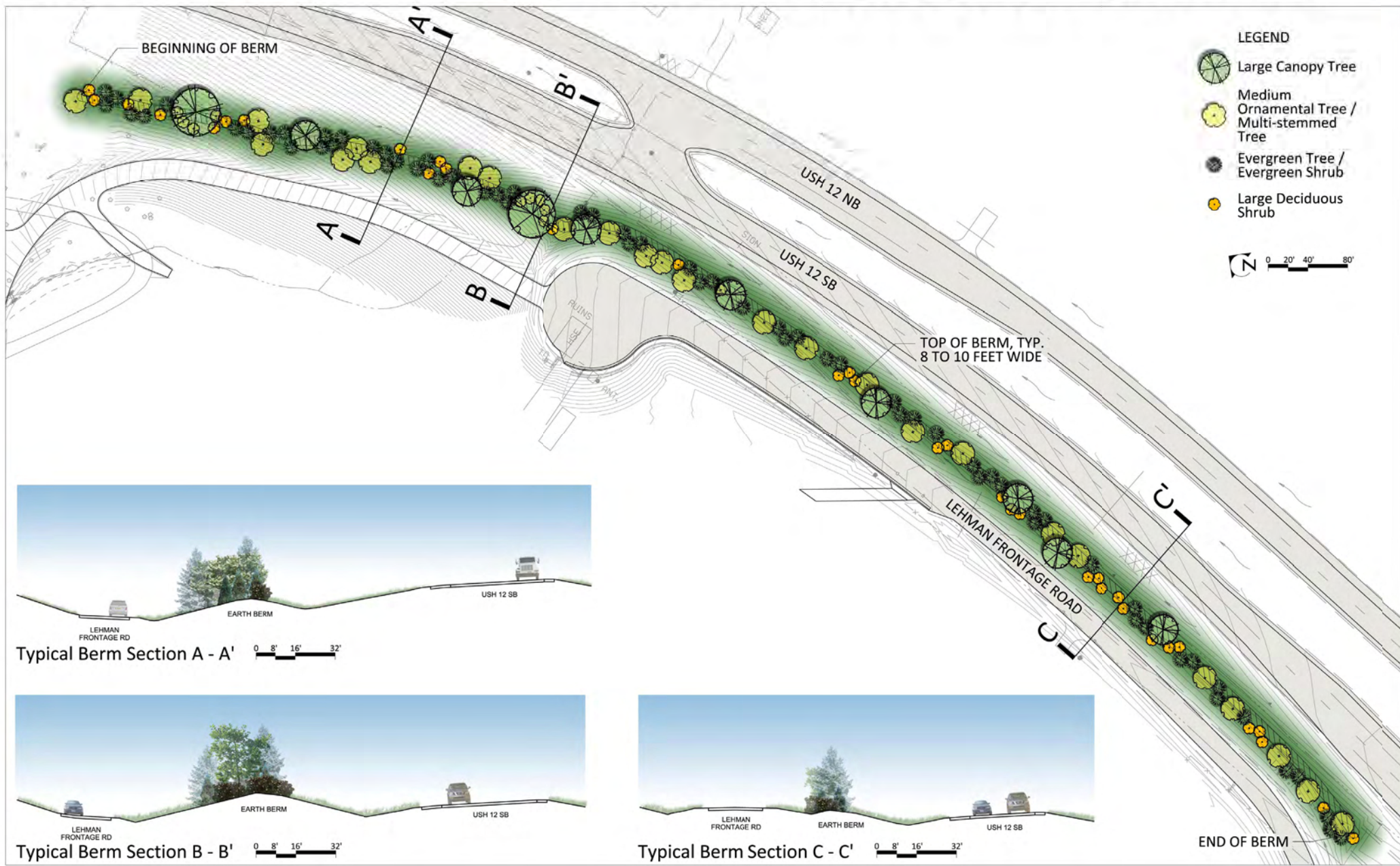



# USH 12 CUL-DE-SAC AND SWALE PLANTING

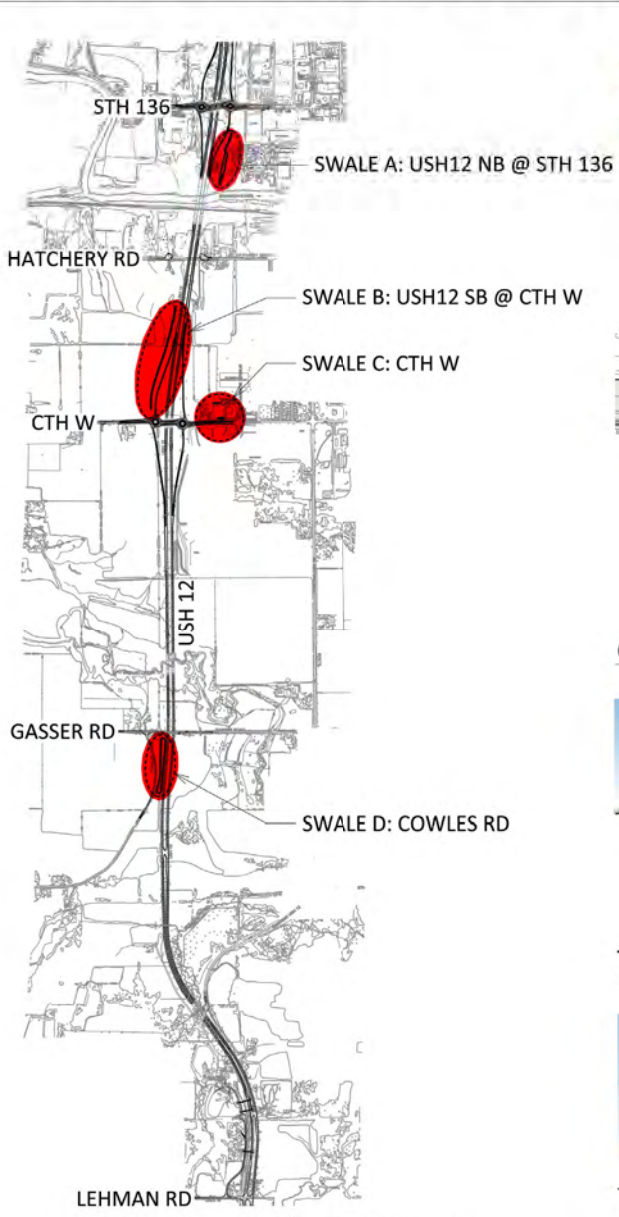

Swale Location Map

- LEGEND**
- Large Canopy Tree
  - Medium Ornamental Tree / Multi-stemmed Tree
  - Evergreen Tree / Evergreen Shrub
  - Large Deciduous Shrub



Cul-de-sac Planting Concept



0 20' 40' 80'

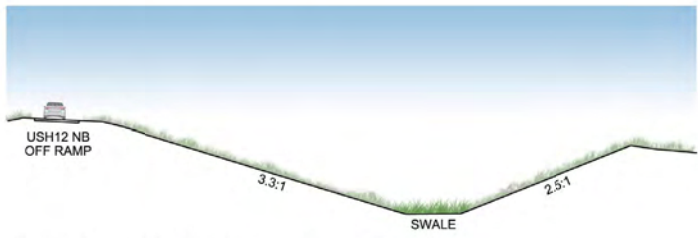

Typical Swale Section A 0 10' 20' 40'

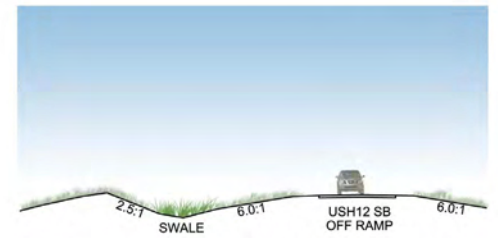

Typical Swale Section B 0 10' 20' 40'

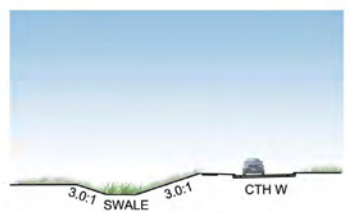

Typical Swale Section C 0 10' 20' 40'

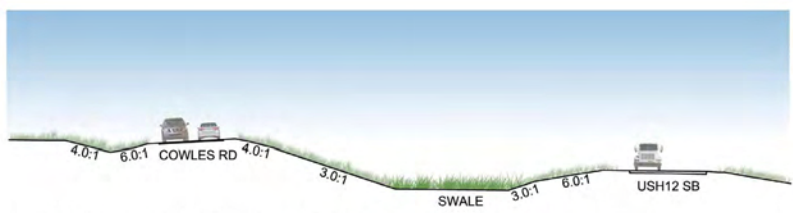

Typical Swale Section D 0 10' 20' 40'