



94 NORTH-SOUTH FREEWAY PROJECT

Late Summer - Fall 2018

GET AROUND GUIDE

> INTRODUCTION

The Wisconsin Department of Transportation (WisDOT) is accelerating work of the **I-94 North-South corridor in southeast Wisconsin**. This is the fastest-paced Mega Project in WisDOT history. A team is in place to build 18.5 miles of freeway and reopen all lanes of traffic by Memorial Day 2020. The project limits for this work run from College Avenue to WIS 142, broken into three segments (North, Central and South).

The project will reconstruct, expand and modernize the freeway. We're adding a fourth lane in each direction, rebuilding five interchanges and building a new interchange at Elm Road.

> IMPORTANCE

I-94 North-South is a vital economic corridor linking the Milwaukee and Chicago metro areas. Commuters, tourists and businesses use the freeway every day to reach destinations in southeastern Wisconsin and beyond.

The federal and state governments are committed to addressing transportation infrastructure needs in this area.

> SCHEDULE

This Get Around Guide provides a schedule for the I-94 North-South project for late summer through fall 2018. You can view a complete project schedule on-line at:

projects.511wi.gov.

> SOUTH SEGMENT OVERVIEW

- Construction began in mid-June 2018 and is scheduled to be completed in November 2019.
- 6.5 miles of mainline reconstruction from WIS 142 to WIS 20.
- Freeway will be expanded to four lanes in each direction.
- The work zone staging currently looks as follows:



> CENTRAL SEGMENT OVERVIEW

- Construction began in mid-July 2018 and is scheduled to be completed in December 2019.
- 4.5 miles of mainline reconstruction from WIS 20 to County G.
- Freeway will be expanded to four lanes in each direction.
- The work zone staging currently looks as follows:



> NORTH SEGMENT OVERVIEW

- Construction is scheduled to begin in August 2018 and be completed in May 2020.
- 7.5 miles of mainline reconstruction from County G to College Avenue.
- Freeway will be expanded to four lanes in each direction.
- A new interchange will be constructed at Elm Road.
- 27th Street will be reconstructed, with permanent closure of entrance/exit ramps.
- Beginning mid-August, the work zone staging will look as follows:

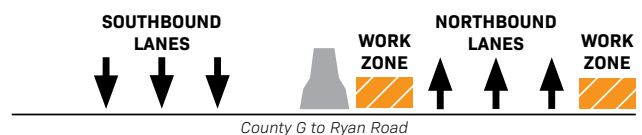
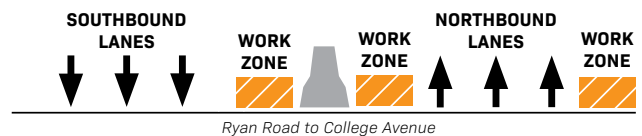

LATE SUMMER - FALL 2018

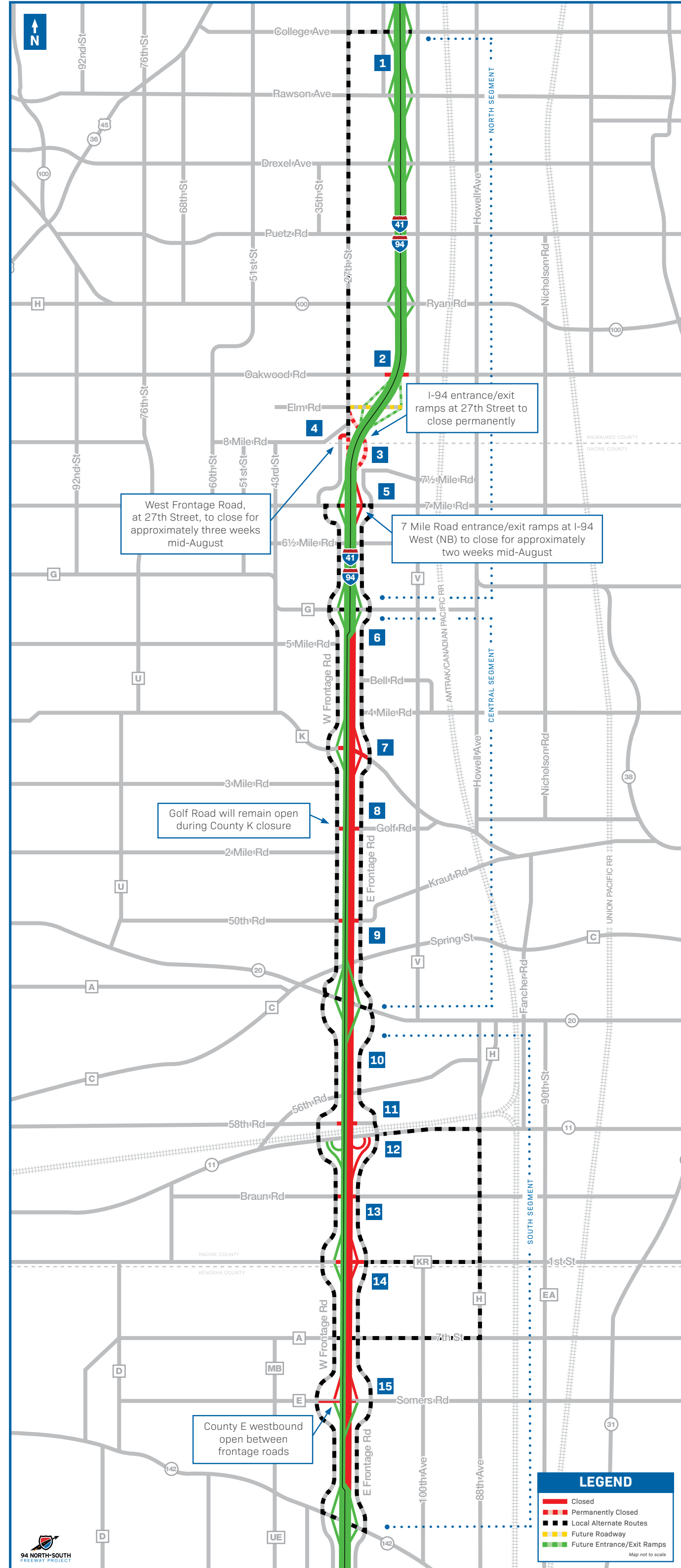

1 I-94 NORTH-SOUTH (COUNTY G - COLLEGE AVE.)

- Work zone prep on I-94 West (NB) shoulders mid-August through late 2018
- Storm sewer work on I-94 East (SB) median shoulder, between College Avenue and Ryan Road, mid-August through late 2018
- Three lanes of traffic in each direction to be open during daytime hours mid-August through late 2018

2 OAKWOOD ROAD

- Oakwood Road, under I-94, closed mid-August through late 2019

3 27TH STREET

- 27th Street entrance ramp to I-94 East (SB) closed permanently mid-August 2018
- I-94 West (NB) exit ramp to 27th Street closed permanently mid-August 2018

4 WEST FRONTAGE ROAD

- West Frontage Road, at 27th Street, closed for approximately three weeks mid-August

5 7 MILE ROAD

- 7 Mile Road, under I-94, closed mid-August through late 2018
- 7 Mile Road entrance ramp to I-94 West (NB) closed for approximately two weeks mid-August
- I-94 West (NB) exit ramp to 7 Mile Road closed for approximately two weeks mid-August

6 I-94 NORTH-SOUTH (WIS 20 - COUNTY G)

- I-94 West (NB), between WIS 20 and County G, to be reconstructed through late 2018
- Two lanes of traffic in each direction to be open during daytime hours through late 2018

7 COUNTY K

- County K, between I-94 East (SB) entrance/exit ramps and East Frontage Road, closed mid-August through early fall 2018
- County K entrance ramp to I-94 West (NB) closed through late 2018
- I-94 West (NB) exit ramp to County K closed through late 2018

8 GOLF ROAD

- Golf Road, under I-94, closed through late 2019 (except during County K long-term closures)

9 KRAUT ROAD

- Kraut Road, under I-94, closed through late 2018 and spring 2019 through late 2019

10 I-94 NORTH-SOUTH (WIS 142 - WIS 20)

- I-94 West (NB), between WIS 142 and WIS 20, to be reconstructed through late 2018
- Two lanes of traffic in each direction to be open during daytime hours through late 2018

11 58TH ROAD

- 58th Road, under I-94, closed through late 2019

12 WIS 11

- WIS 11, under I-94, open to one lane of traffic in each direction through late 2019
- WIS 11 entrance ramp to I-94 West (NB) closed through winter 2018/2019
- I-94 West (NB) exit ramp to WIS 11 closed through late 2018

13 BRAUN ROAD

- Braun Road, under I-94, closed through late 2019

14 COUNTY KR

- County KR, under I-94, closed through summer 2019
- County KR entrance ramp to I-94 West (NB) closed through late 2018
- I-94 West (NB) exit ramp to County KR closed through late 2018

15 COUNTY E

- County E eastbound, under I-94, closed between West Frontage Road and northbound ramps through late 2019
- County E entrance ramp to I-94 West (NB) closed through late 2019
- I-94 East (SB) exit ramp to County E closed through spring 2019

LOCAL ALTERNATE ROUTES

- **North Segment:** Motorists are encouraged to use County G, College Avenue, 27th Street, and the frontage roads to get around the crossroad closures
- **Central Segment:** Motorists are encouraged to use WIS 20, County G, and the frontage roads to get around the ramp and crossroad closures
- **South Segment:** Motorists are encouraged to use WIS 142, WIS 20, and the frontage roads to get around the ramp and crossroad closures

*View Regional Alternate routes on-line at projects.511wi.gov

> HOW DO I GET AROUND THE PROJECT?

PARK & RIDE: The following Park & Ride lots are located along the I-94 North-South project corridor:

- > I-43/894 and Loomis Road
- > I-43/94 and Holt Avenue
- > I-94 and College Avenue
- > I-94 and Ryan Road (*Closed through fall 2018*)
- > I-94 and WIS 20
- > I-94 and WIS 11 (*Currently closed*)
- > Renaissance Boulevard and E. Exploration Court (Sturtevant Train Station)
- > 5413 13th Avenue (Kenosha Metra Train Station)
- > WIS 165 and Terwall Terrace

AIRPORT CONNECTION: Transportation service linking Milwaukee's General Mitchell Airport, as well as Chicago's O'Hare and Midway Airports, with all of Southeastern Wisconsin. goriteway.com

AMTRAK HIAWATHA: With seven round-trips daily between Milwaukee and Chicago, you can just sit back and relax and avoid the traffic. amtrakhiawatha.com

MILWAUKEE COUNTY TRANSIT SYSTEM: The Milwaukee County Transit system connects 40 million riders a year with jobs, school, shopping, healthcare and recreation in Milwaukee County. ridemcts.com

RYDE: The Belle Urban System is now RYDE, connecting you to work, school, entertainment and much more throughout Racine. cityofracine.org/Racine-Transit/

WISCONSIN COACH LINES: Regional transportation provider with service from downtown Milwaukee to many southeast Wisconsin cities, General Mitchell Airport, and O'Hare airport in Chicago. coachusa.com

> OUR MISSION

We're creating a better I-94

Our top priorities are to:

- Build I-94 safely with our contractors.
- Maximize mobility so you can plan ahead to get to your destination.
- Demonstrate Wisconsin excellence with an experienced local project team.



> FOLLOW US



projects.511wi.gov



twitter.com/WisconsinPlan94



facebook.com/WisconsinPlan94

If you would like to be added to the I-94 North-South distribution list to receive future project updates, contact:

Michael Pyritz

WisDOT SER Communications Manager

(262) 521-5373

Michael.Pyritz@dot.wi.gov

You can also sign up to receive project updates and find additional project information on-line at:

projects.511wi.gov