

# WISCONN VALLEY DEVELOPMENT ROADS

NEWS & UPDATES

May 6, 2020



## WIS 11 Traffic Switch to Occur

The Wisconsin Department of Transportation (WisDOT) began reconstruction of the WIS 11 and County H intersection in early April. The following upcoming work is scheduled for the next phase of the project.

### Morning of Monday, May 11:

- › Eastbound and westbound traffic is scheduled to be shifted south on WIS 11 as crews work to reconstruct the new westbound lanes.

Access to residents and businesses will be maintained.

Please note that all work is weather dependent and subject to change.

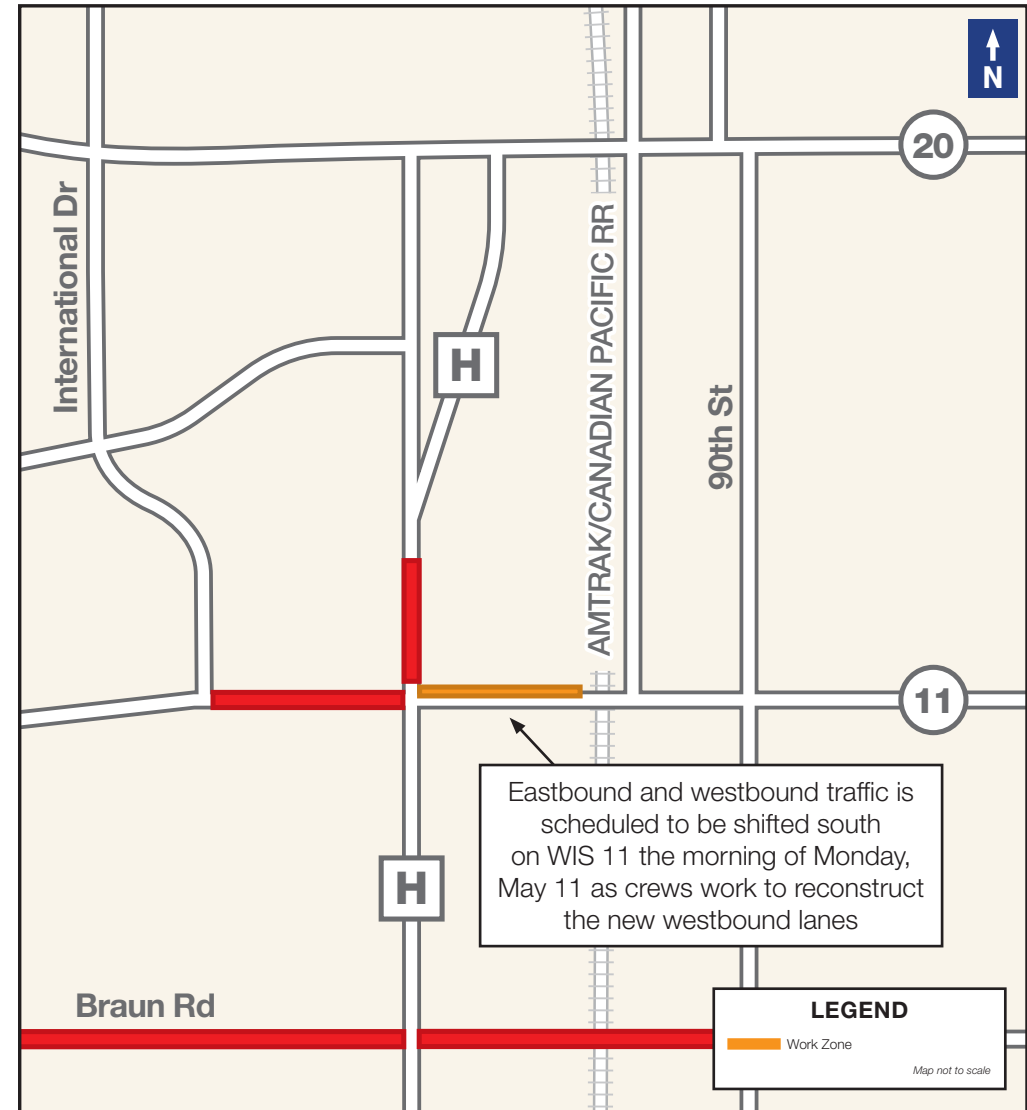

Find us online at:  
[projects.511wi.gov/fdr](https://projects.511wi.gov/fdr)

Athena Lorono | Construction Public Involvement Lead | [Athena@devorpr.com](mailto:Athena@devorpr.com) | (262) 933-0467

Project Contact: