

WIS 23

Fond du Lac – Urban Area
(US 151 – 7 Hills Road)
Fond du Lac County

Public Involvement Meeting
UW – Fond du Lac
August 19, 2019



Purpose of the Meeting

- Discuss elements of the project that have been updated or changed since the last public involvement meeting
- Preview the construction staging
- Present upcoming project activities



Project Location Map

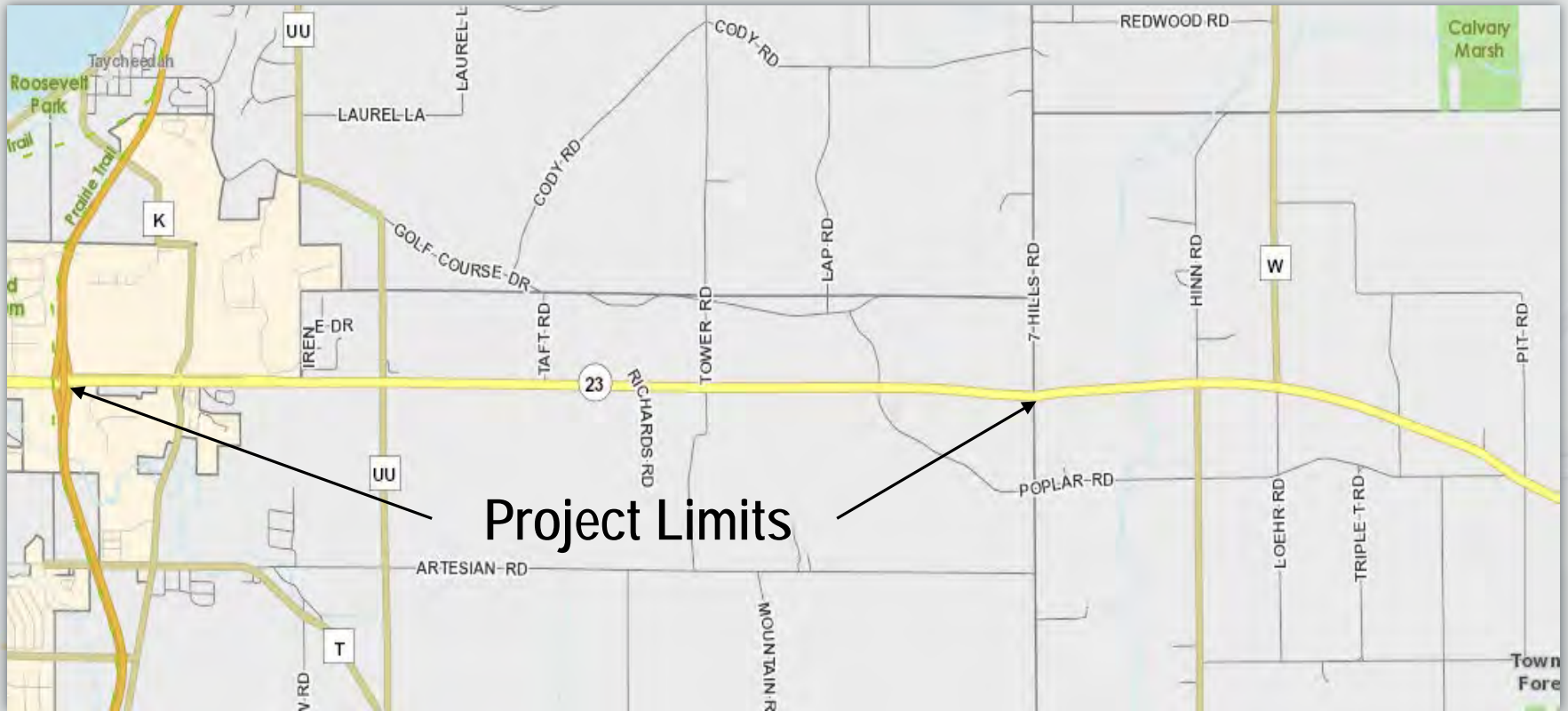

Displays

- Proposed Changes
- Proposed Design
- Construction Staging

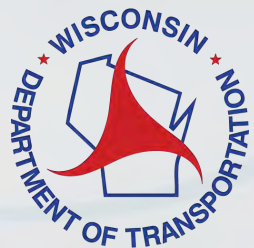

Proposed Changes

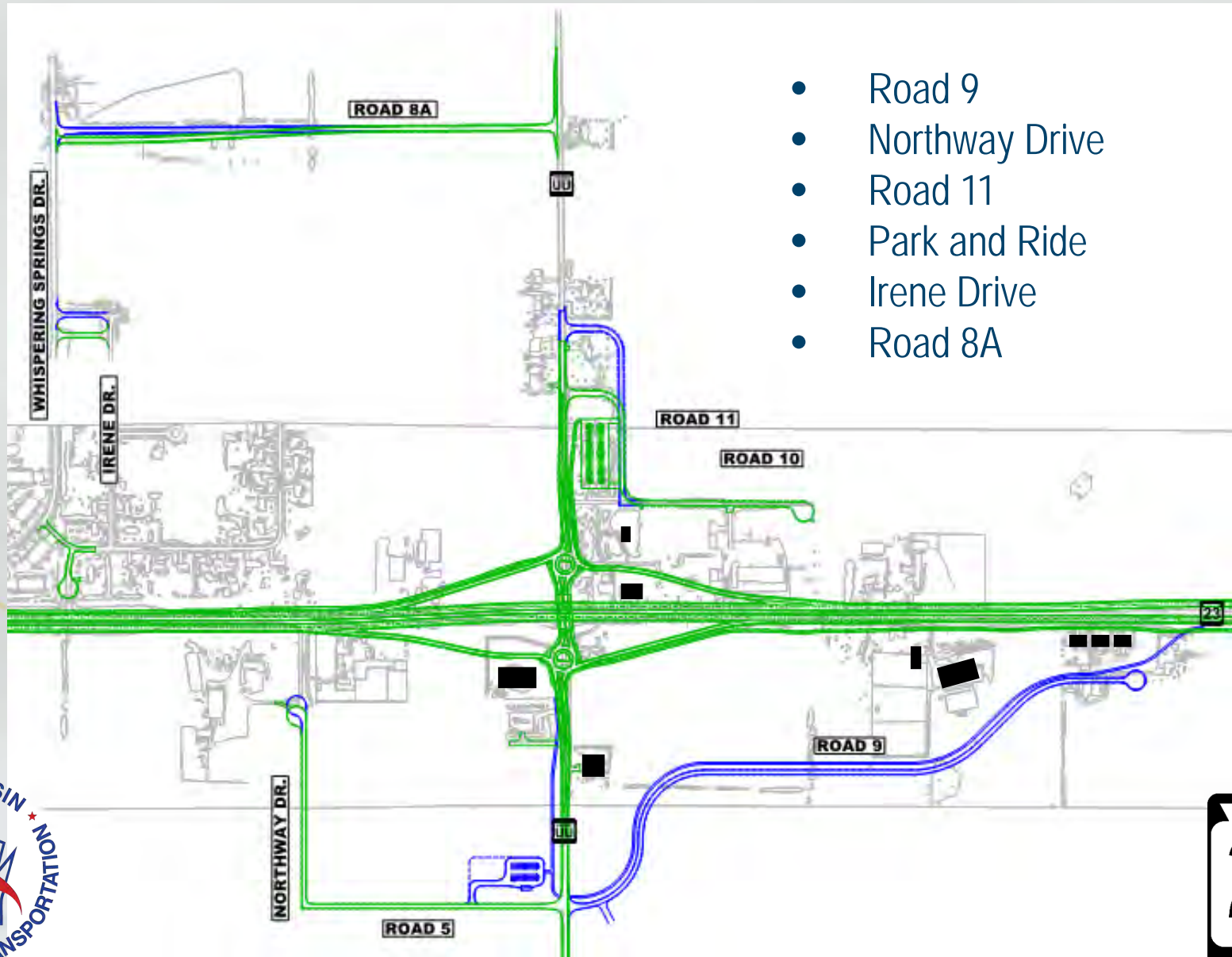

- Road 9
- Northway Drive
- Road 11
- Park and Ride
- Irene Drive
- Road 8A

Proposed Changes

WIS 23 speed limit and profile changes between County K and UU

- Speed limit increased from 45 MPH to 55 MPH
- Concrete barrier wall added between Old Plank Trail and WIS 23

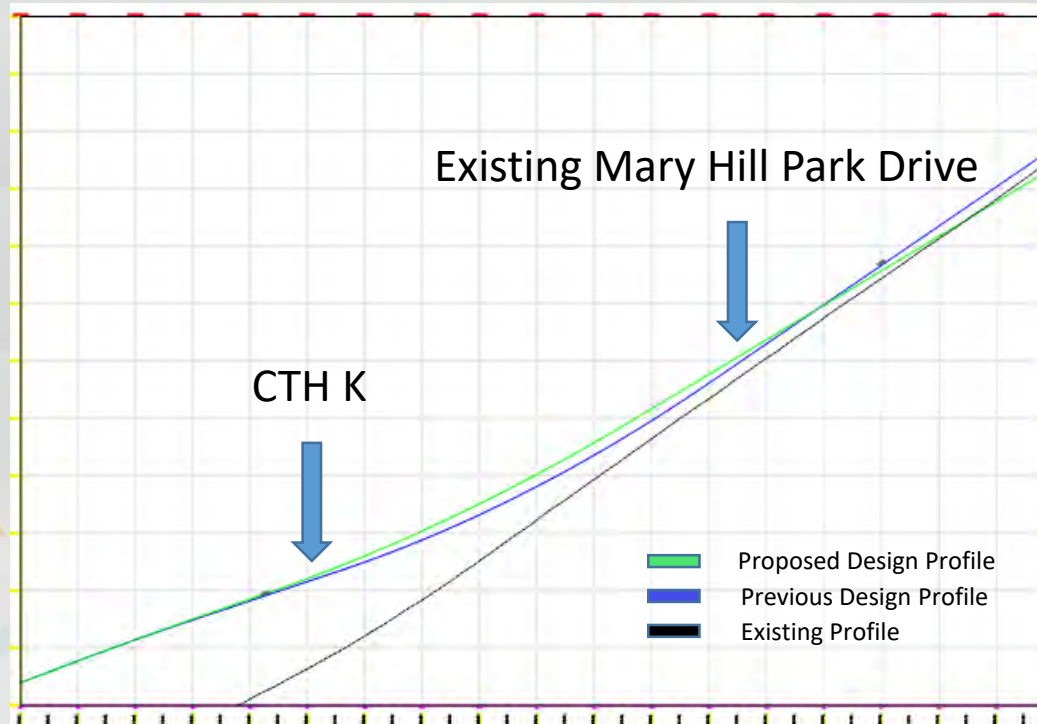

Proposed Changes

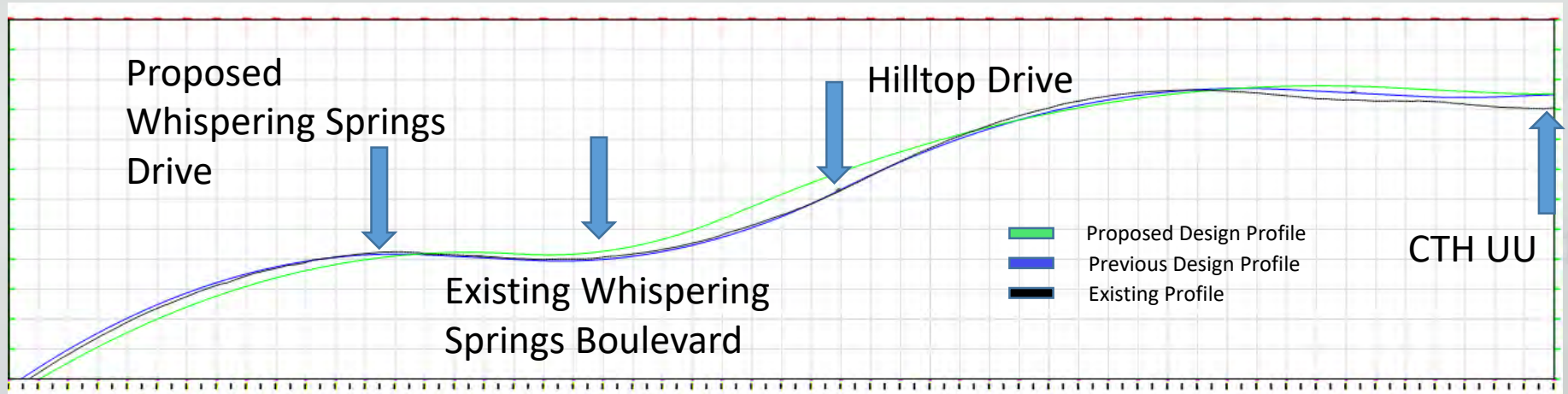

Proposed Design

WIS 23

- Expand the existing two lanes to four lanes from Whispering Springs Boulevard to 7 Hills Road
- Restricted Crossing U-Turn Intersections (RCUT)
 - Tower Road
 - 7 Hills Road

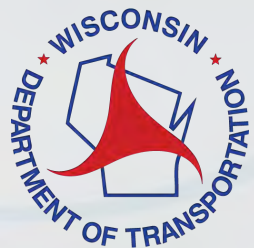

Improve the existing four lane portion of WIS 23

US 151 to Whispering Springs Boulevard

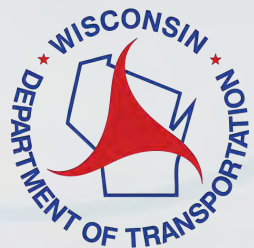
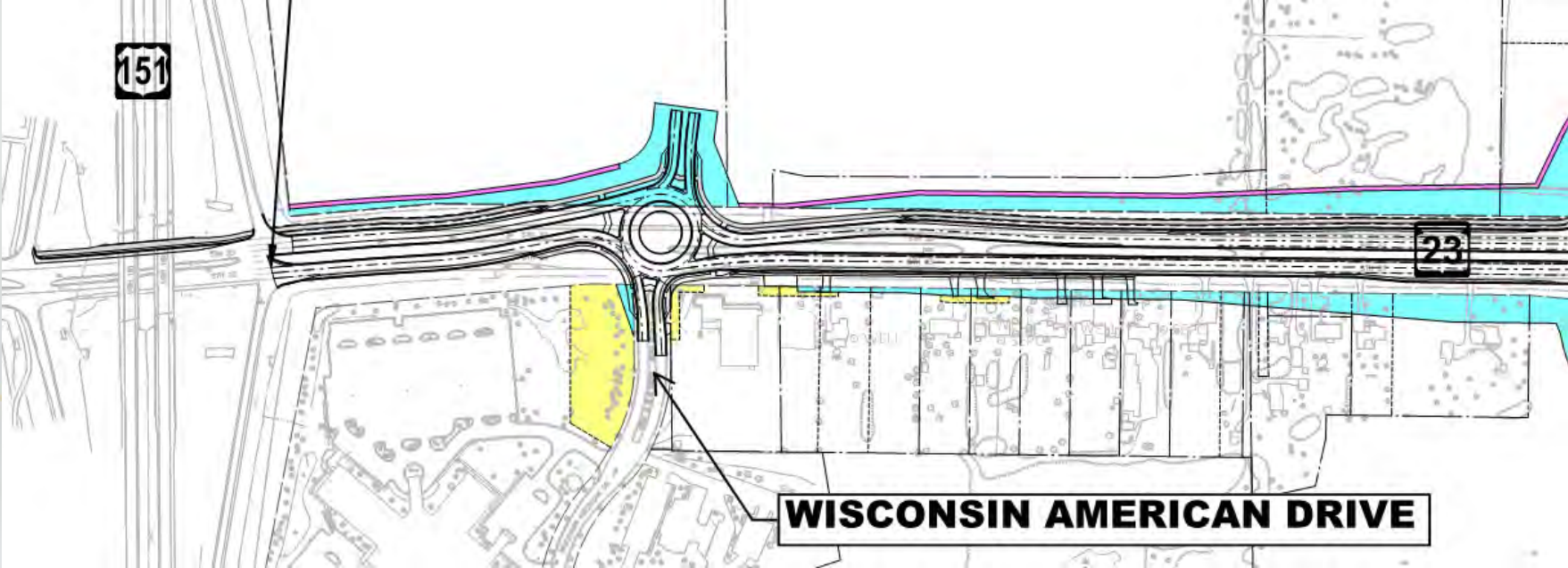

County K Interchange

- Roundabout at the ramp exits and entrances
- Urban roadway section on County K
- Access for Mary Hill Park Drive and Hillside Circle

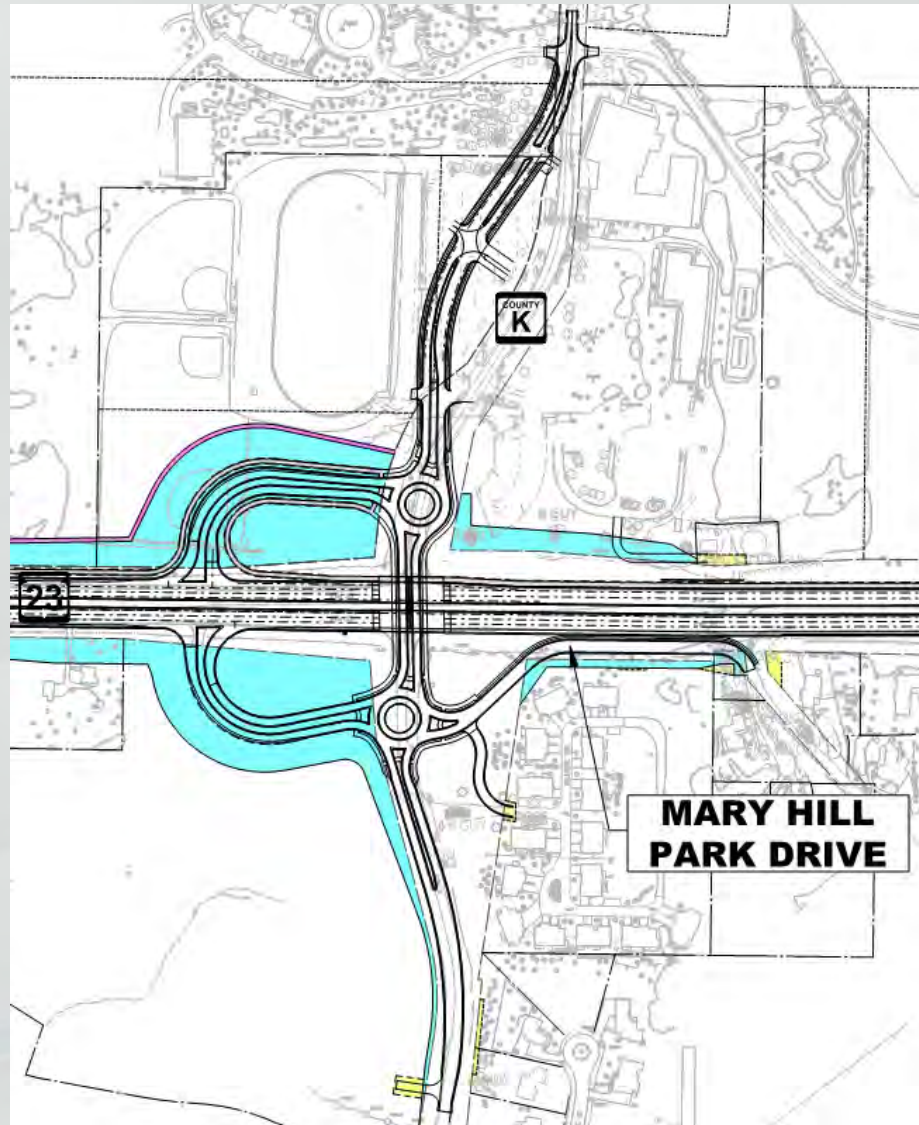

Improve the existing four lane portion of WIS 23

Whispering Springs Boulevard to 7 Hills Road

- Whispering Springs connection
- Hilltop Drive connection

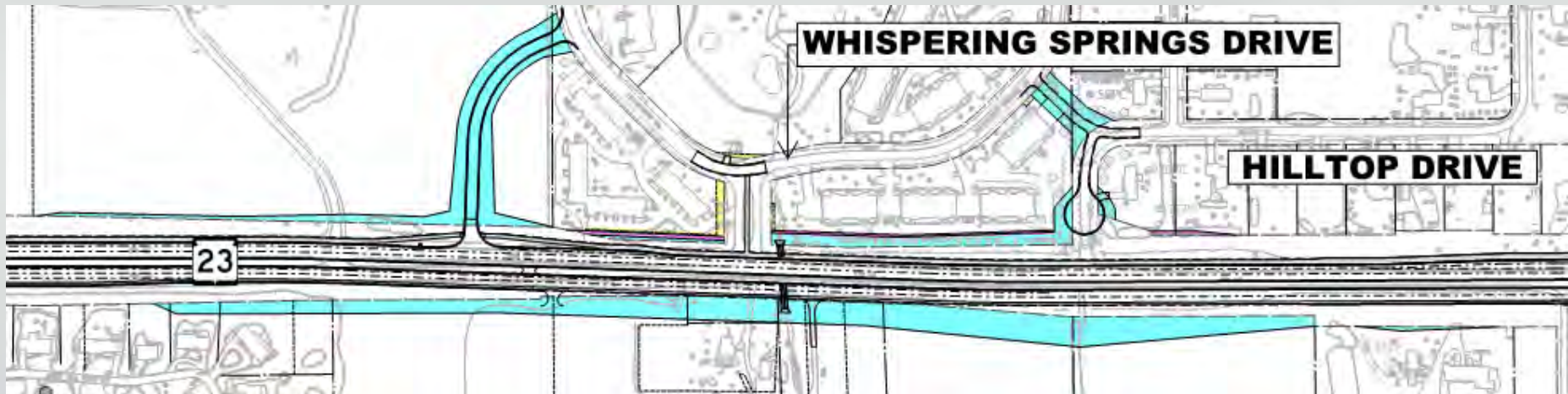

Improve the existing four lane portion of WIS 23

County UU Interchange

- Roundabout at the ramp exits and entrances
- Urban roadway section on County UU
- Road 10 and 11
- Park and Ride

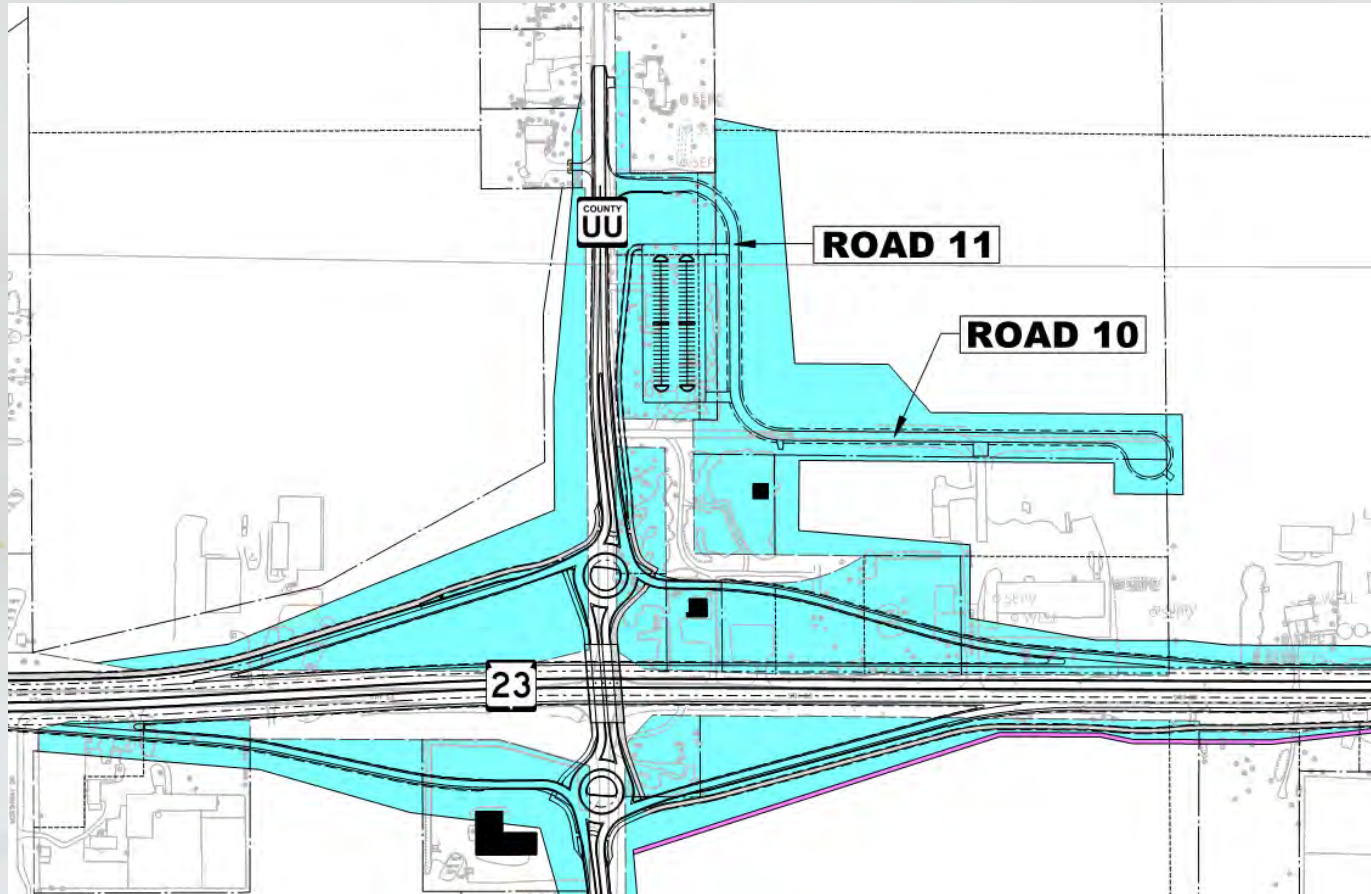

Expand the existing two lanes to four lanes from Whispering Springs Boulevard to 7 Hills Road

- Taft Road - right in/right out

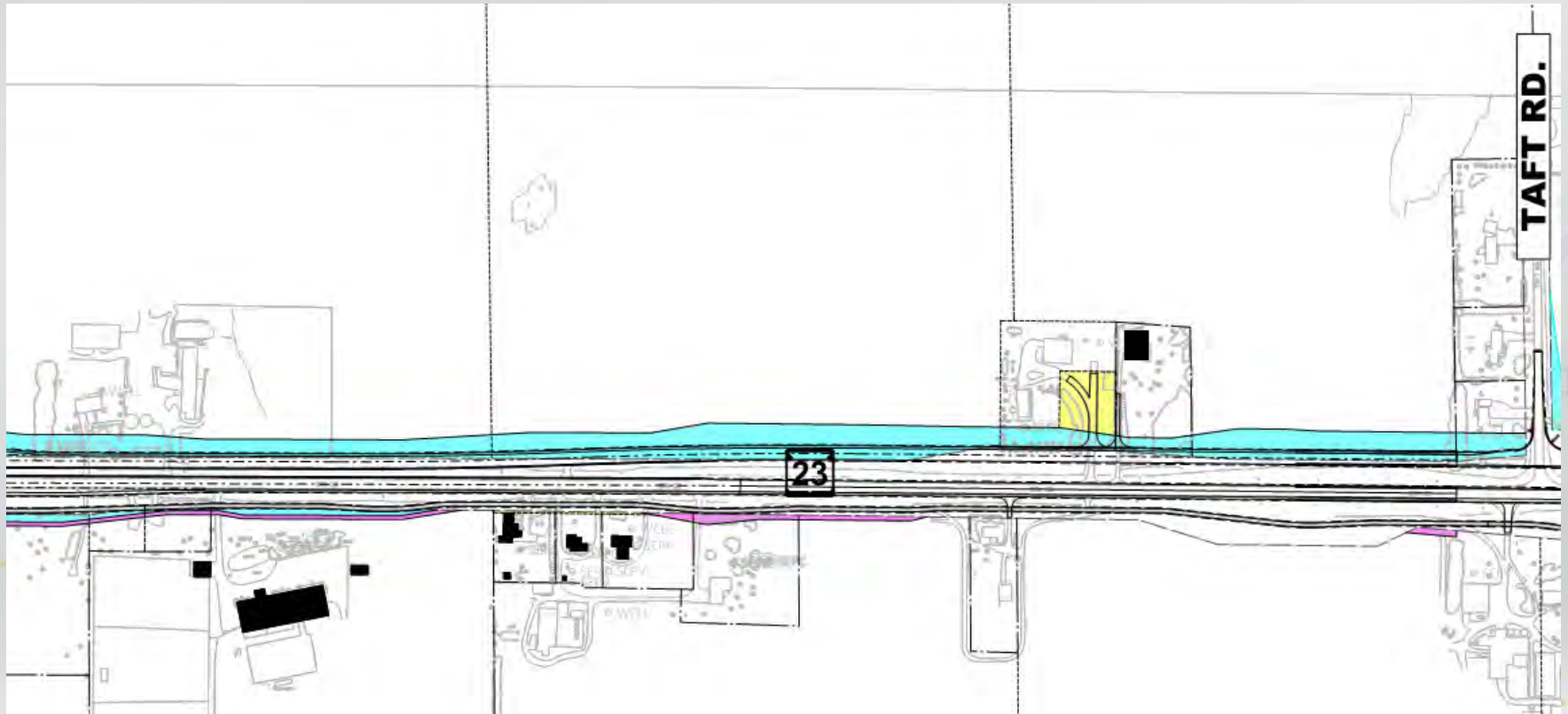

Expand the existing two lanes to four lanes from Whispering Springs Boulevard to 7 Hills Road

- Richards Road - full access
- Tower Road eastbound - RCUT (Restricted Crossing U-Turn Intersections)

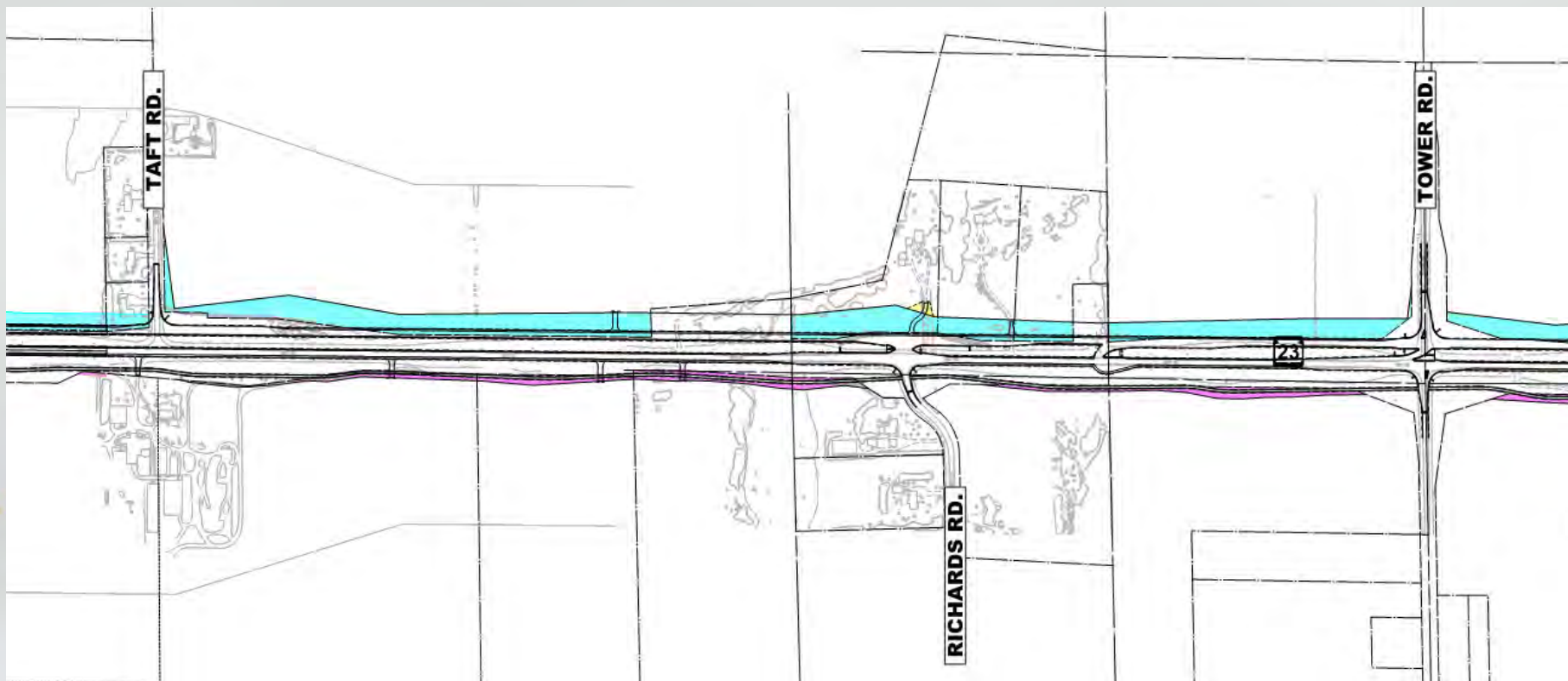

Expand the existing two lanes to four lanes from Whispering Springs Boulevard to 7 Hills Road

- Poplar Road – right in/right out

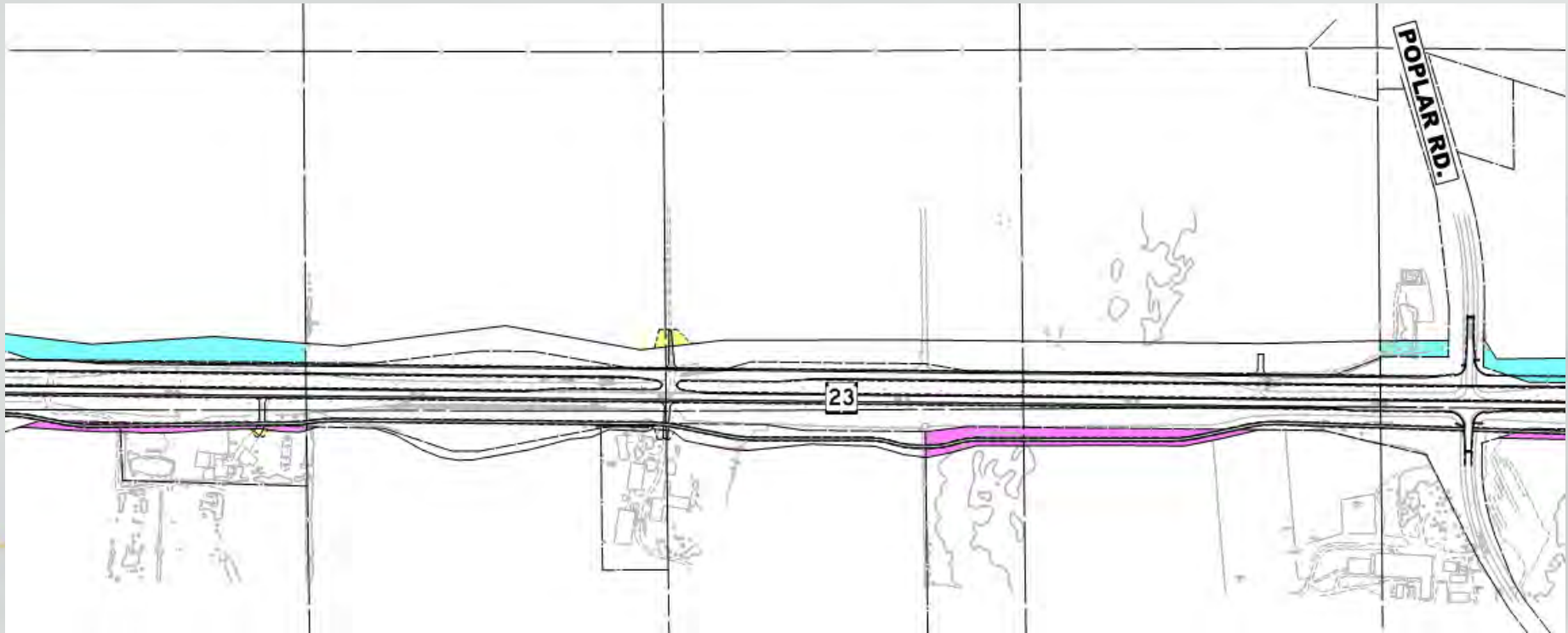

Expand the existing two lanes to four lanes from Whispering Springs Boulevard to 7 Hills Road

- 7 Hills Road – RCUT

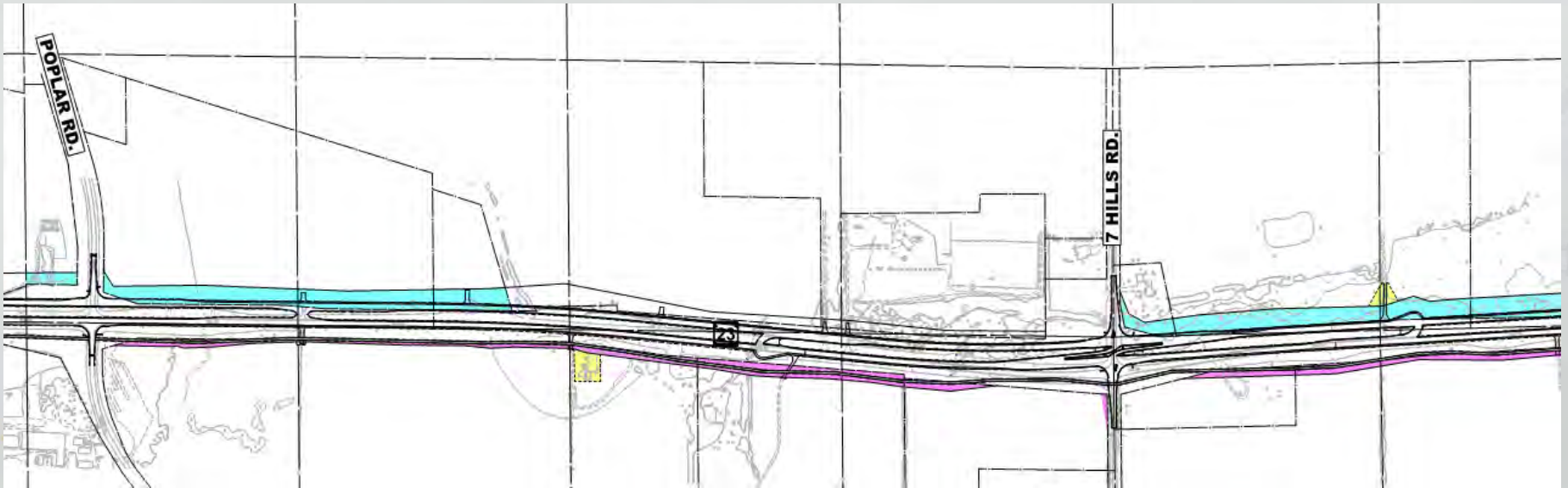

Construction Staging

- Safety
- Emergency access
- Side road access
- Private access



Stage 1

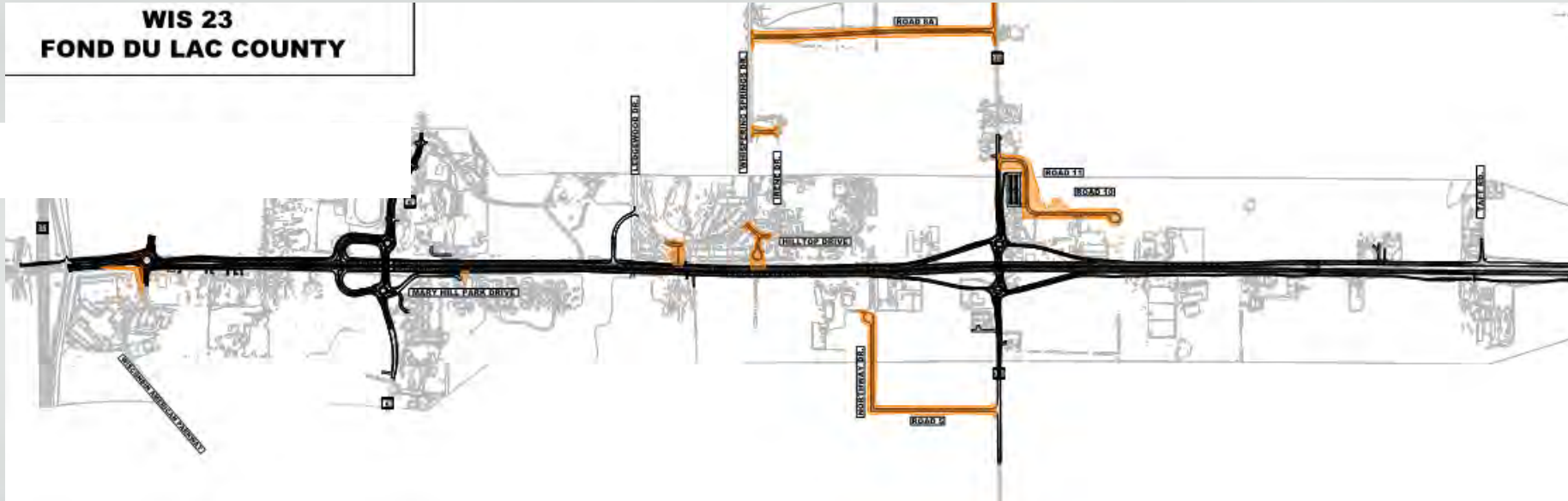

Irene Drive

Road 8a

Northway Road

Road 10

Road 5

Road 11



Stage 2

- Construction of WIS 23 eastbound lanes from US 151 to County UU
- WIS 23 westbound lanes from County UU to 7 Hills Road
- Wisconsin American Drive Roundabout
- County K Interchange

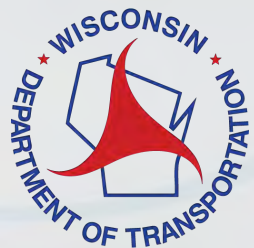

Stage 2

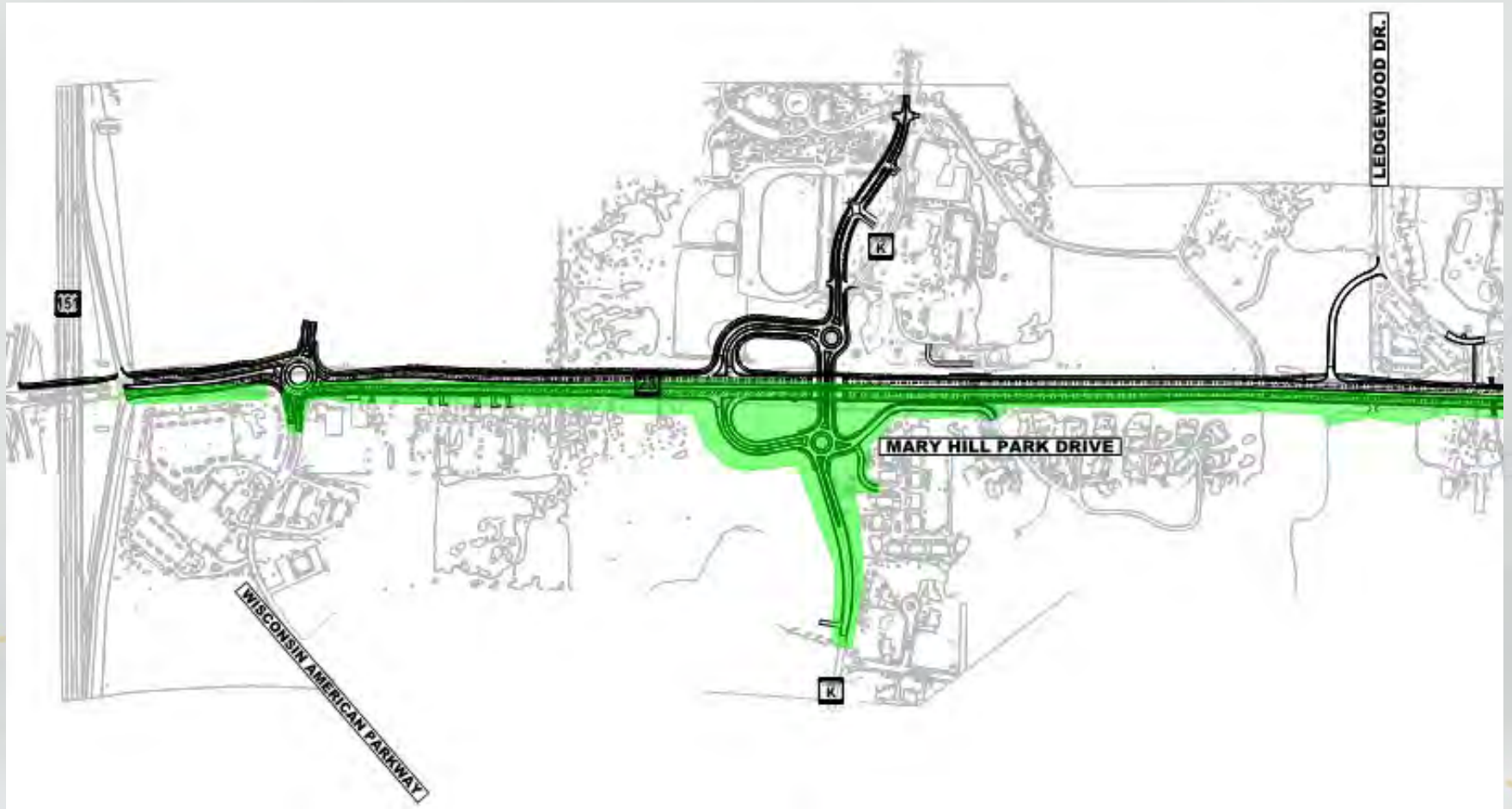

Stage 2

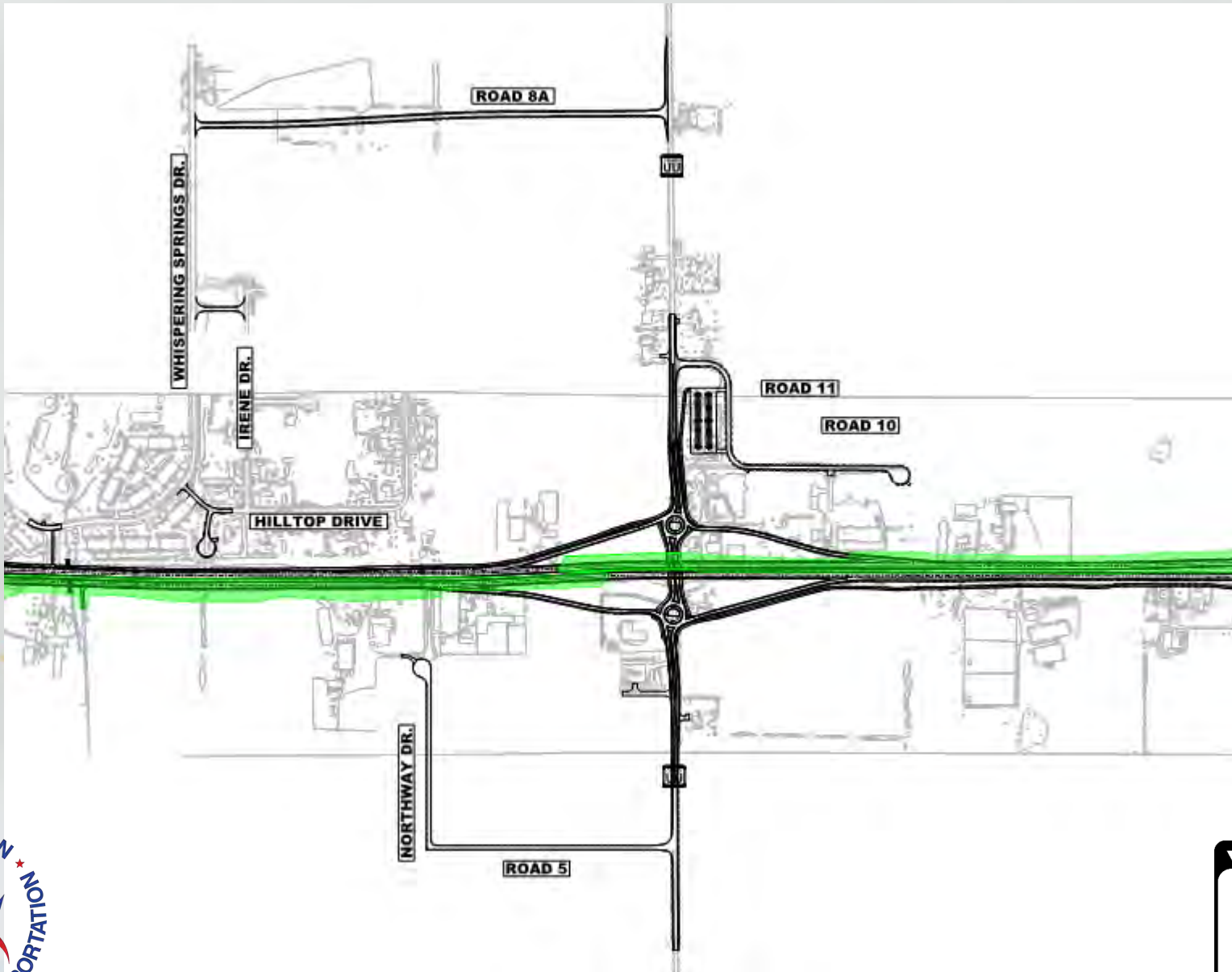

Stage 2

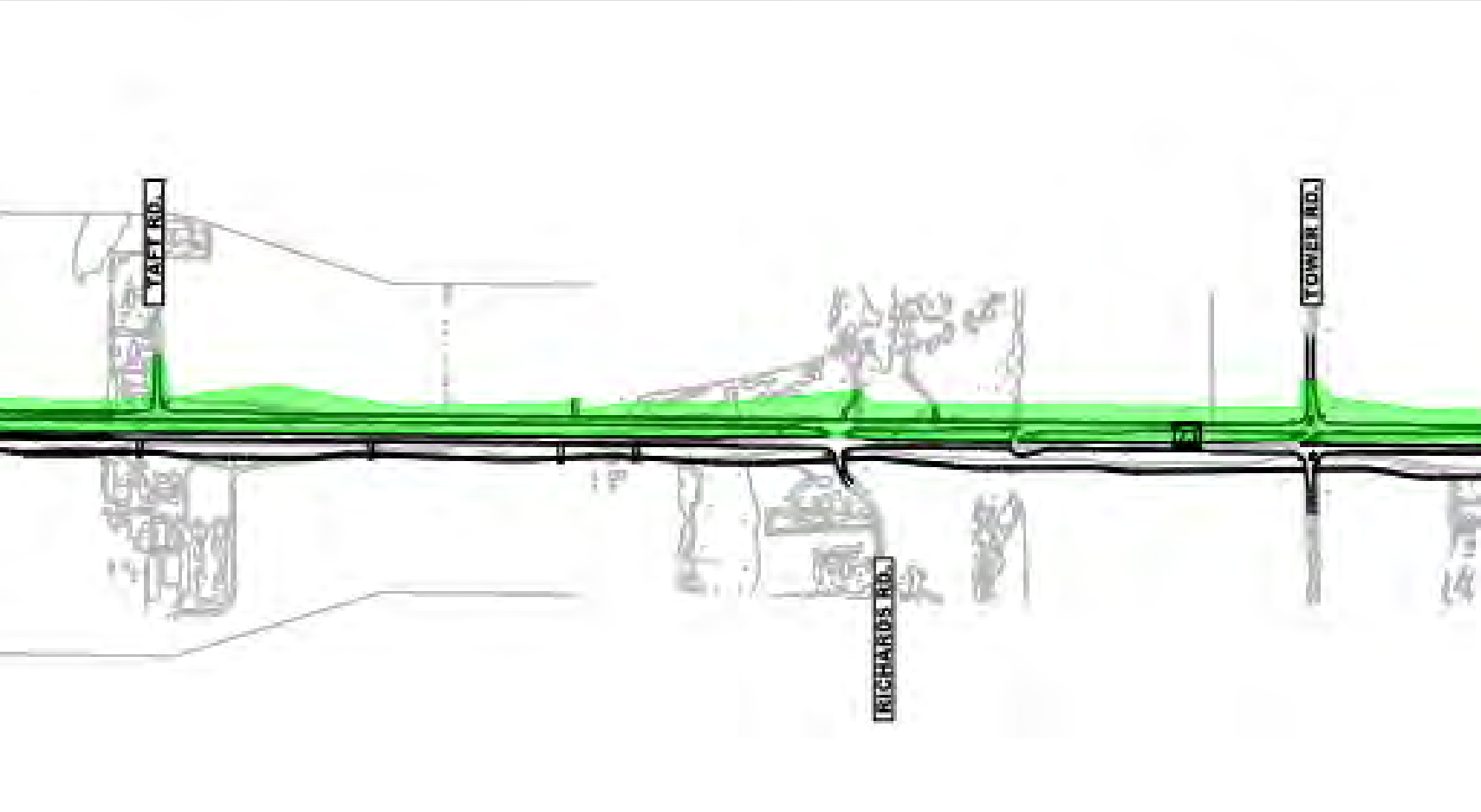

Stage 2

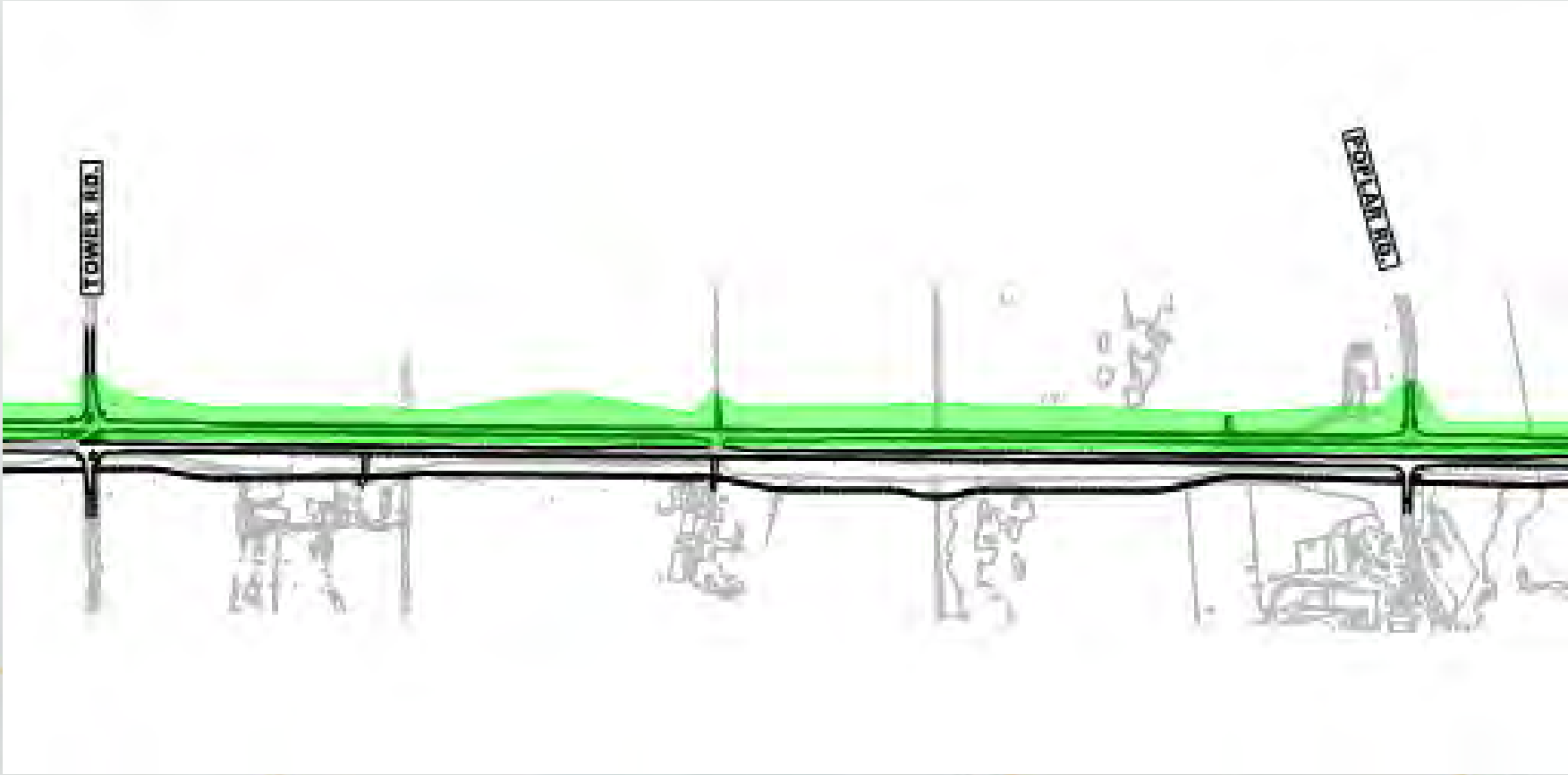

Stage 2



Stage 3

- Construction of WIS 23 westbound lanes from US 151 to County UU
- WIS 23 eastbound lanes from County UU to 7 Hills Road
- Wisconsin American Drive Roundabout
- County K and County UU Interchanges



Stage 3

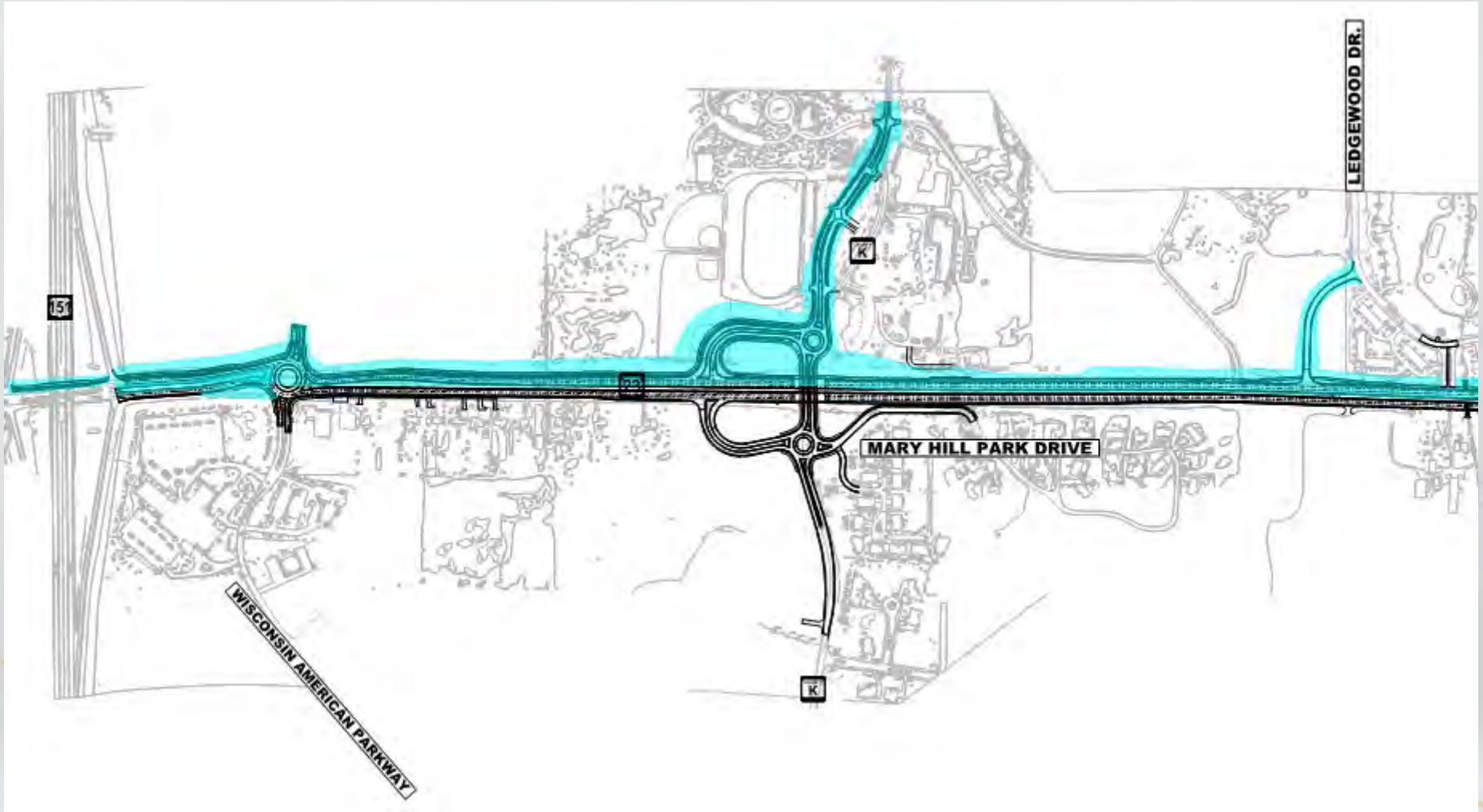

Stage 3

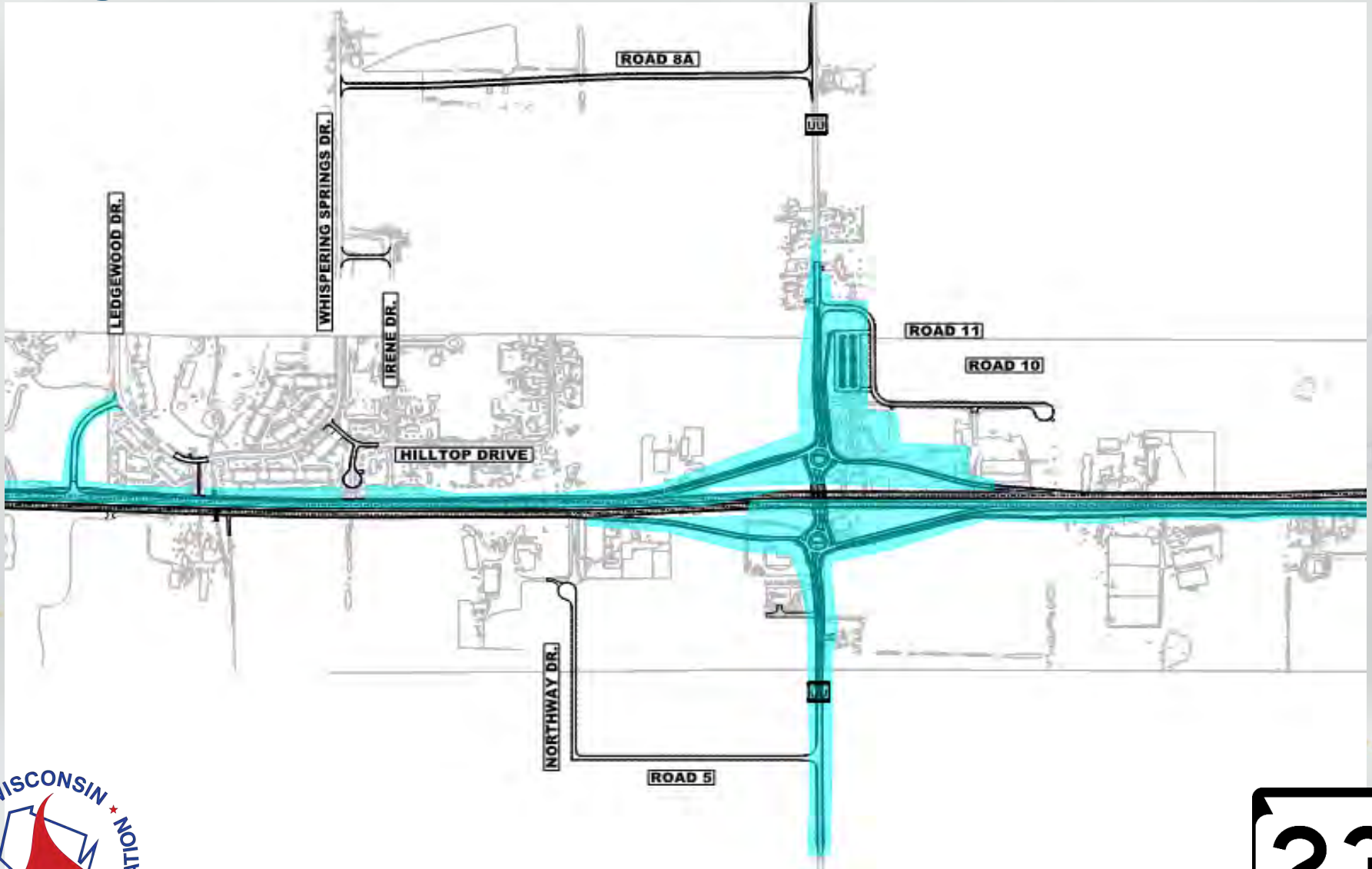

Stage 3

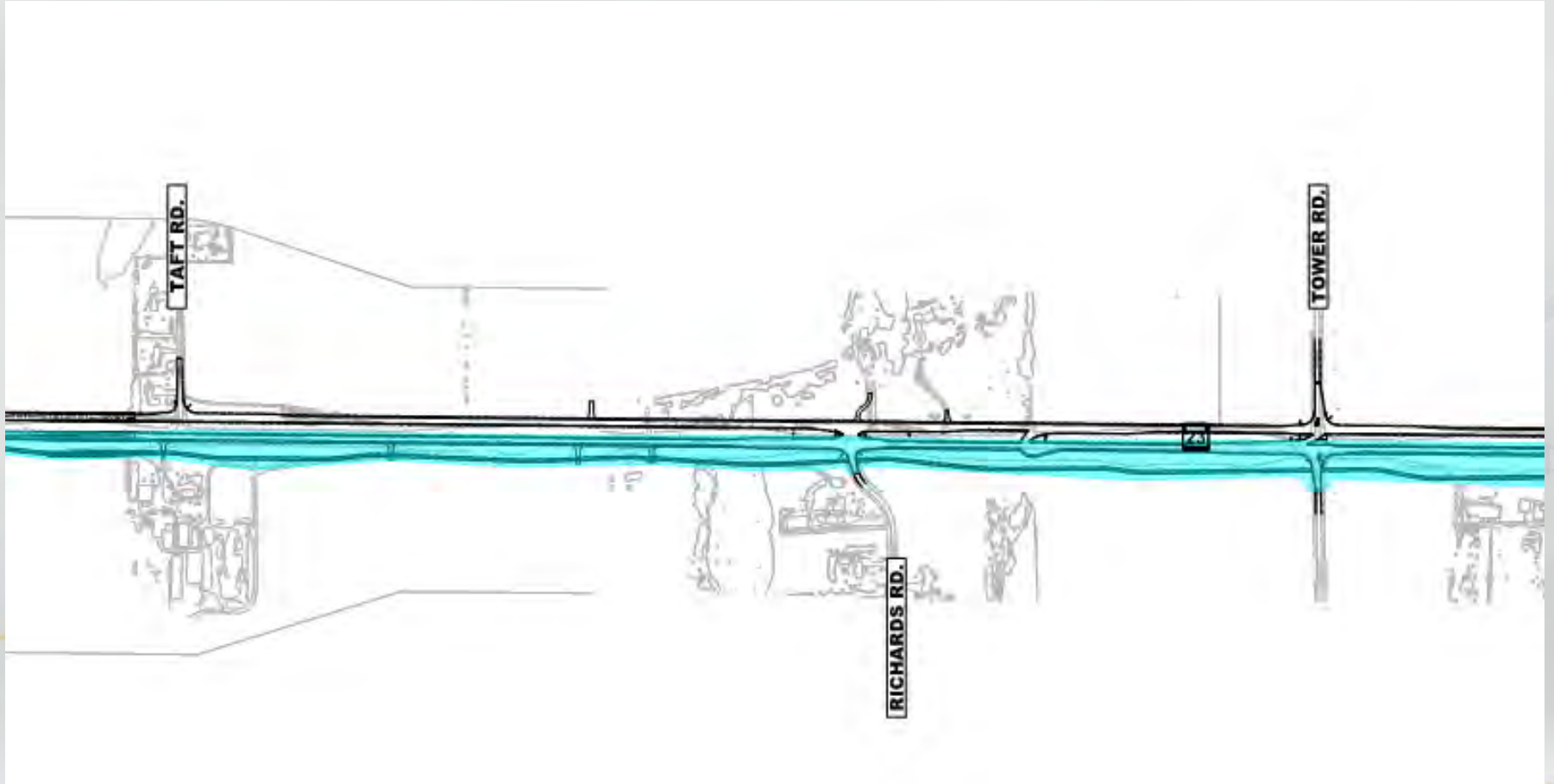

Stage 3

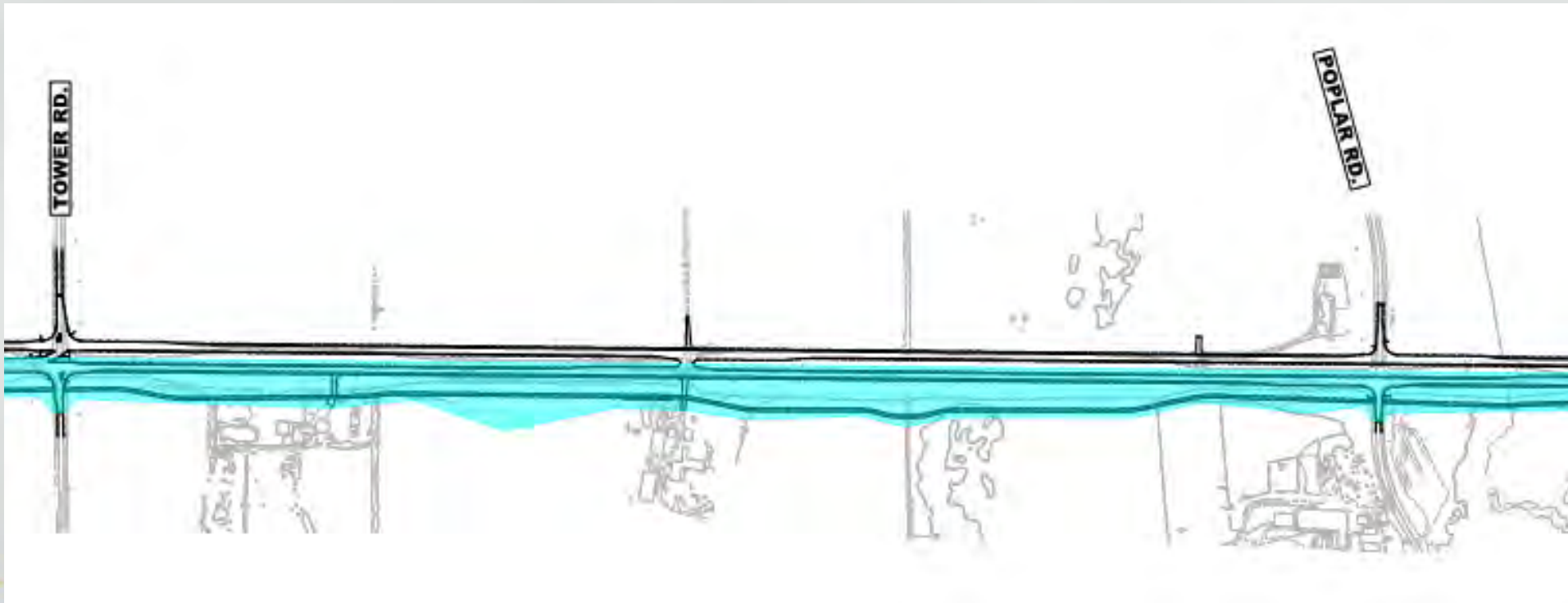

Stage 3

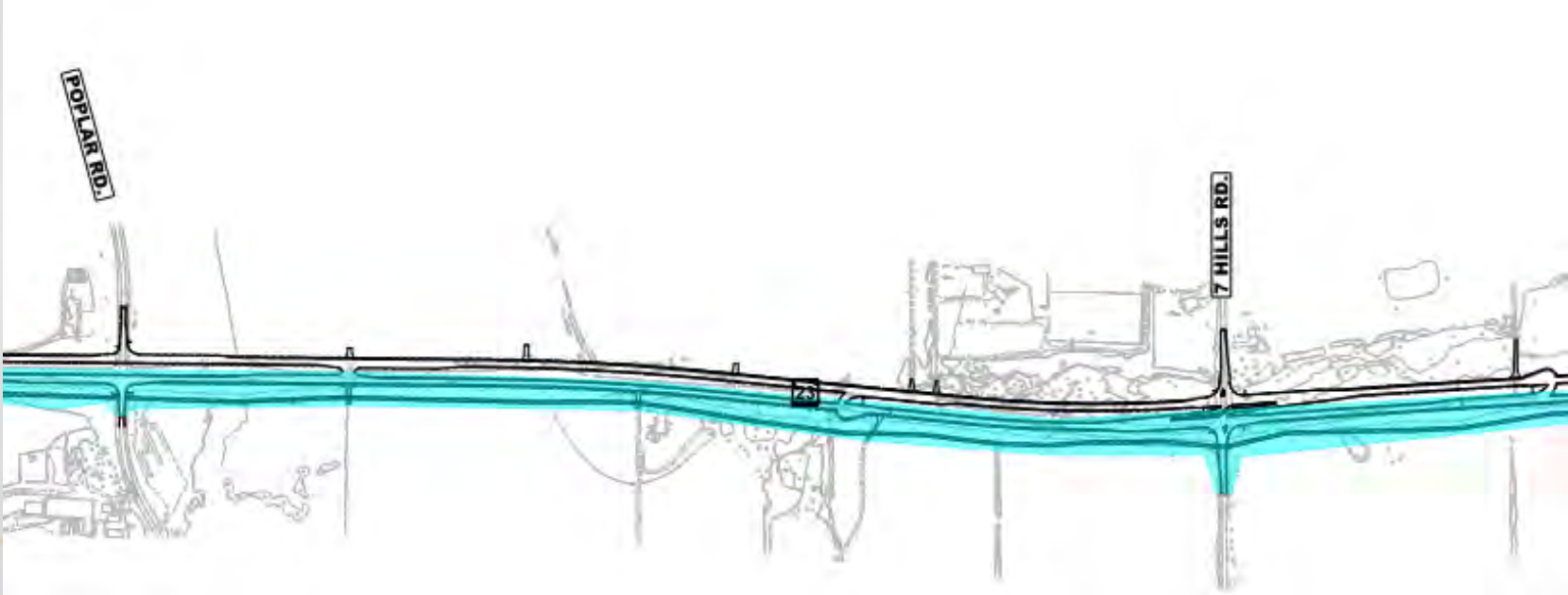

Project Schedule

WIS 23 (US 151 to Seven Hill Road)	2018	2019	2020	2021	2022
Refinement/Final Design	█				
Real Estate Acquisition		█			
Utility Relocation		█			
Construction				█	



QUESTIONS?



WIS 23 Contacts

Bryan Learst, P.E., Project Manager
WisDOT NE Region
944 Vanderperren Way
Green Bay, WI 54304
Phone: (920) 366-5639
Email: byran.learst@dot.wi.gov

Eric Danke, P.E., Design Leader
WisDOT NE Region
944 Vanderperren Way
Green Bay, WI 54304
Phone: (920) 492-5647
Email: eric.danke@dot.wi.gov

Mark Kantola
WisDOT NE Region Communication Manager
944 Vanderperren Way
Green Bay, WI 54304
Phone: (920) 492-4153
Email: mark.kantola@dot.wi.gov



WIS 23 CONSTRUCTION SCHEDULE

FOND DU LAC COUNTY
USH 151 - SEVEN HILLS ROAD
GRADING, PAVING, & STRUCTURES
CONSTRUCTION YEAR 2021 & 2022

FOND DU LAC COUNTY
SEVEN HILLS ROAD - EAST COUNTY LINE
GRADING, PAVING, & STRUCTURES
CONSTRUCTION YEAR 2020 & 2021

SHEBOYGAN COUNTY
WEST COUNTY LINE - CTH P
GRADING & STRUCTURES
CONSTRUCTION YEAR 2019
PAVING
CONSTRUCTION YEAR 2020

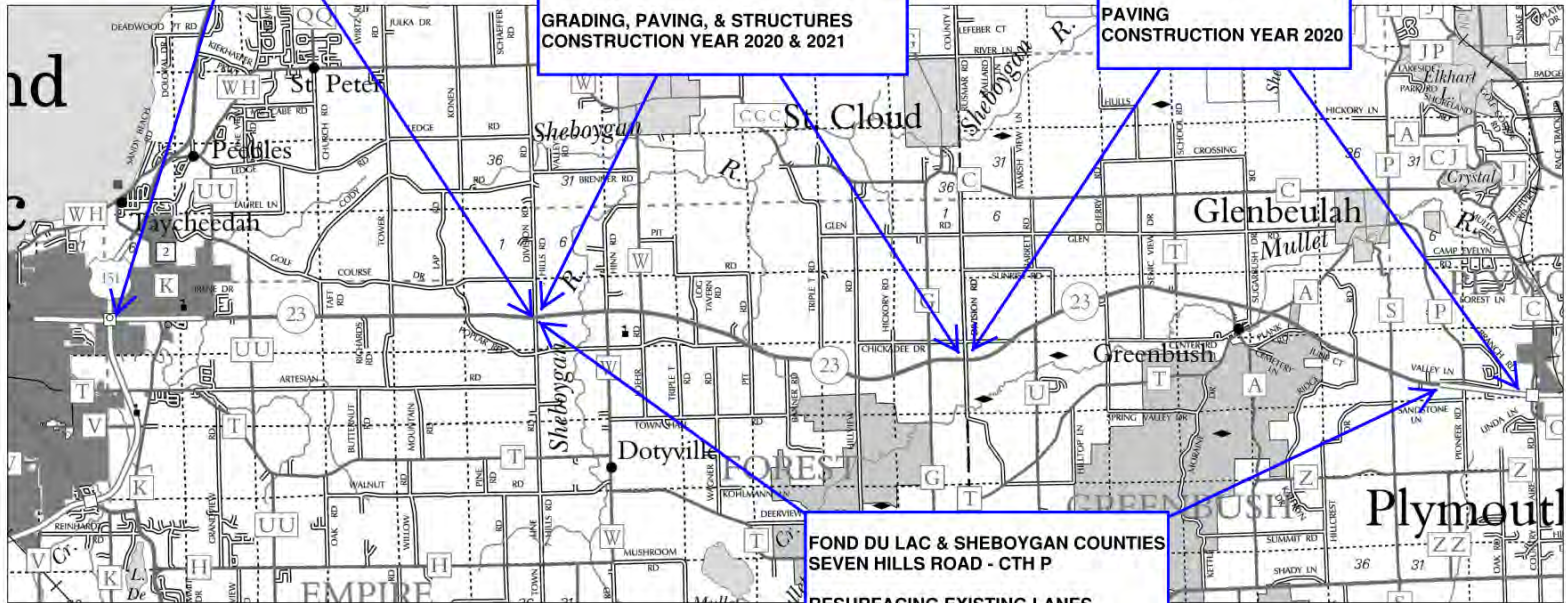

FOND DU LAC & SHEBOYGAN COUNTIES
SEVEN HILLS ROAD - CTH P
RESURFACING EXISTING LANES
CONSTRUCTION YEAR 2022



42 Total Conflict Points

- 24 Crossing
- ▲ 10 Merge
- 8 Diverge

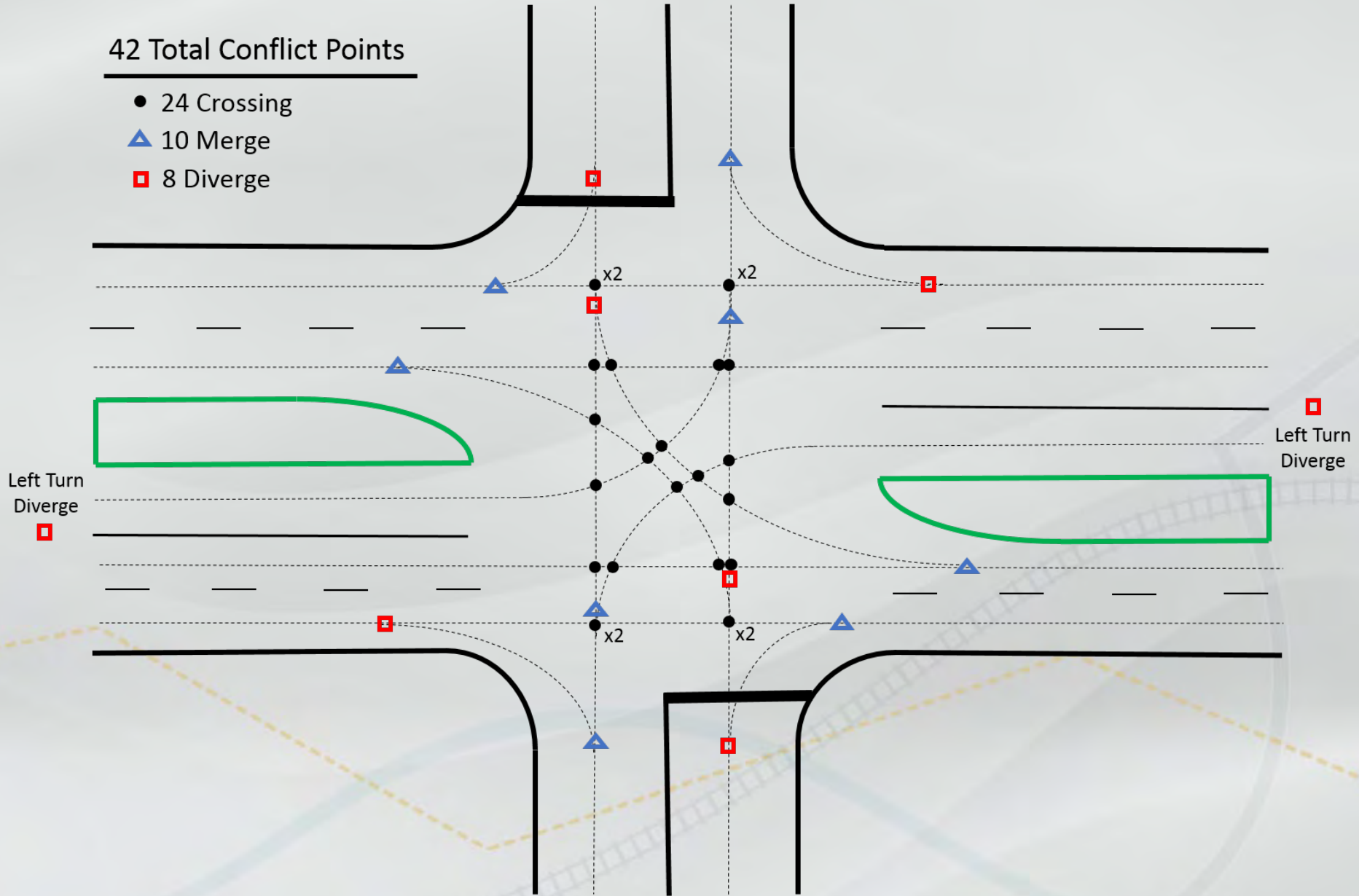

24 Total Conflict Points

- 4 Crossing
- ▲ 10 Merge
- ◻ 10 Diverge

