



WIS 28/County EE Roundabout Project

Sheboygan County

Spring 2021

The Wisconsin Department of Transportation (WisDOT) will be starting stage 2 of the WIS 28/County EE roundabout project in the spring of 2021. Previous grading work at this intersection was completed in the fall of 2020.

Stage 2 Work Details

- Detour set up
- Roundabout excavation and grading including base aggregate placement
- Curb & gutter and asphalt pavement
- Beam guard installation
- WIS 28 bridge wingwall replacement and polymer overlay
- Pavement marking, signing, lighting, and final restoration

Project Location

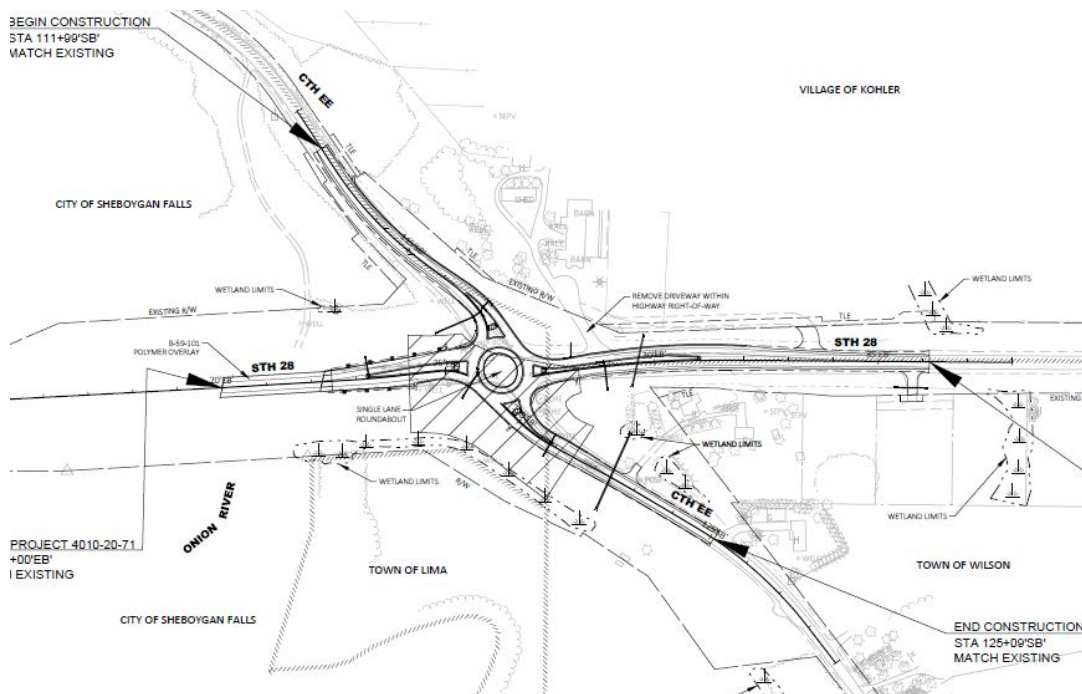

2021 Project Schedule:

April 1: Detour set up and WIS 28/County EE intersection closed

April: Excavation and storm sewer installation

Late April/May: Structure wingwall repair, approach slab, and polymer overlay

May: Concrete curb & gutter and other ancillary concrete work

Early June: Asphalt paving

June: Signing, pavement marking, final restoration, and lighting

June 23: Project complete, open to traffic

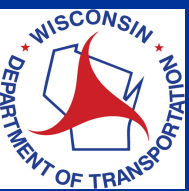

WIS 28/County EE Roundabout Project

Sheboygan County

Spring 2021

Traffic Impacts

Intersection of WIS 28 and County EE will close to through traffic at the start of stage 2. Detour route will be set up utilizing WIS 32, County V and Interstate 43.

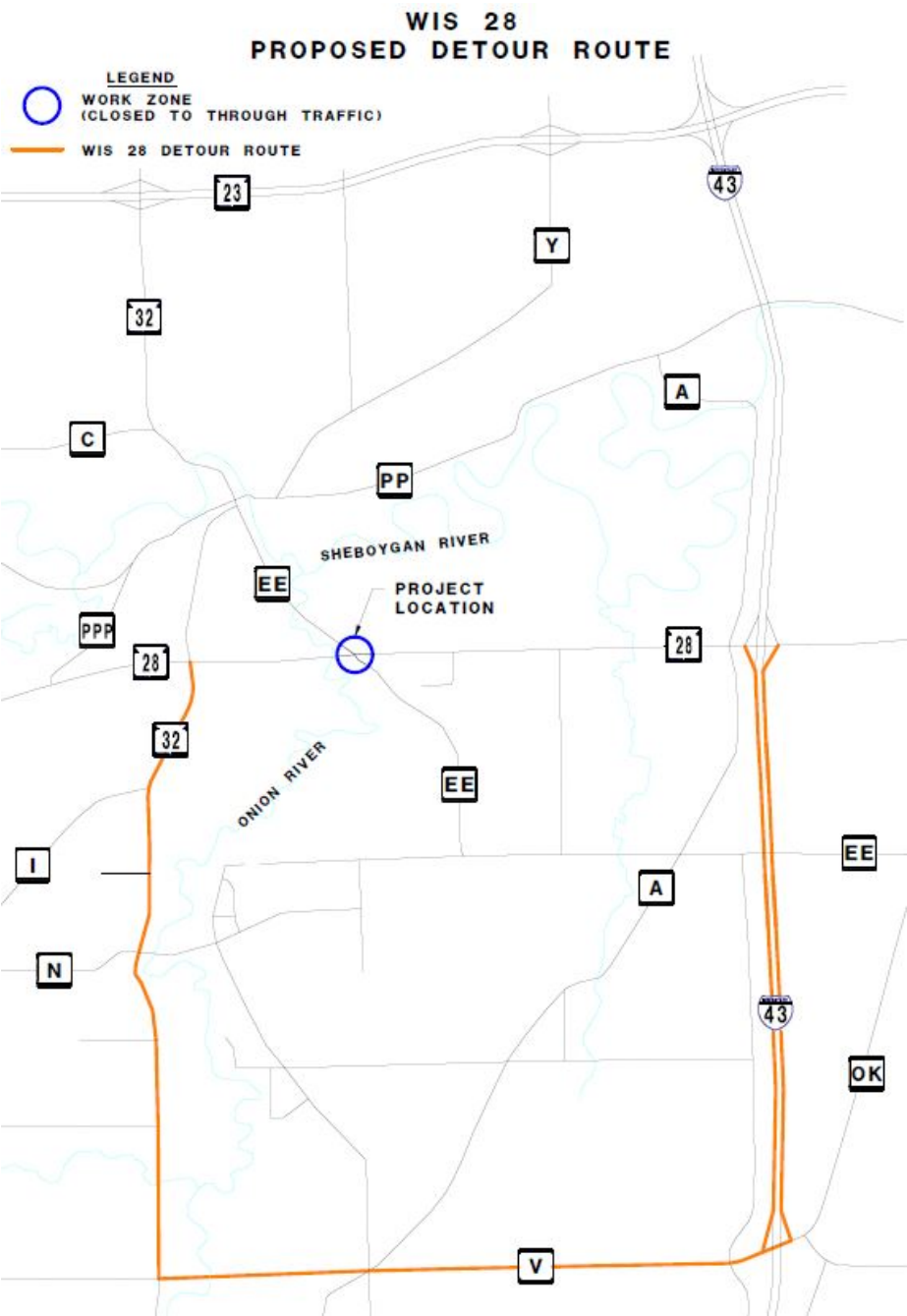

Contact information:

Kyle Trembl, P.E.
Project Manager
(920) 360-7029
Kyle.trembl@dot.wi.gov

Josh Frewerd, P.E.
Project Engineer
(920) 680-1340
JFrewerd@mcmgrp.com

