

I-94 North-South Traffic Switch (South Segment)

The Wisconsin Department of Transportation (WisDOT) is reconstructing I-94 North-South (South Segment) from WIS 20 in Racine County south to WIS 142 in Kenosha County.

As the next phase of the project, traffic will be decoupled and shifted to their respective sides of the freeway by 5 a.m. on Friday, November 8. Three lanes of traffic will remain open in each direction. Work will continue in the median through late 2019.

Thursday, November 7:

- I-94 EAST (SB) between WIS 20 and WIS 142, is scheduled to close to traffic between the hours of 10 p.m. and 5 a.m. as crews work to perform a traffic switch.

Detour route: Motorists are encouraged to use WIS 20, WIS 142, and the frontage roads to get around the overnight freeway closure.

Friday, November 8:

- 58th Road, under I-94, is scheduled to reopen by 6 a.m.
- I-94 EAST (SB) entrance/exit ramps at WIS 11 are scheduled to reopen by 6 a.m.
- Braun Road, under I-94, is scheduled to reopen by 6 a.m.
- I-94 EAST (SB) entrance/exit ramps at County KR are scheduled to reopen by 6 a.m.
- County E entrance ramp to I-94 EAST (SB) is scheduled to reopen by 6 a.m.

The County E entrance ramp to I-94 WEST (NB) will remain closed through late 2019.

The speed limit will remain 60 mph between WIS 20 and WIS 142.

Additional overnight closures may occur along the I-94 North-South Freeway Corridor that are unrelated to this update. To view all closures on I-94, visit: projects.511wi.gov/i94nouthsouth

Please note that all closures are weather dependent and subject to change.

To learn more about the upcoming construction or to receive project updates, please contact:

Rachel Andreoli
Construction Public Involvement Lead
Email: Rachel@devopr.com | Phone: (262) 977-0234

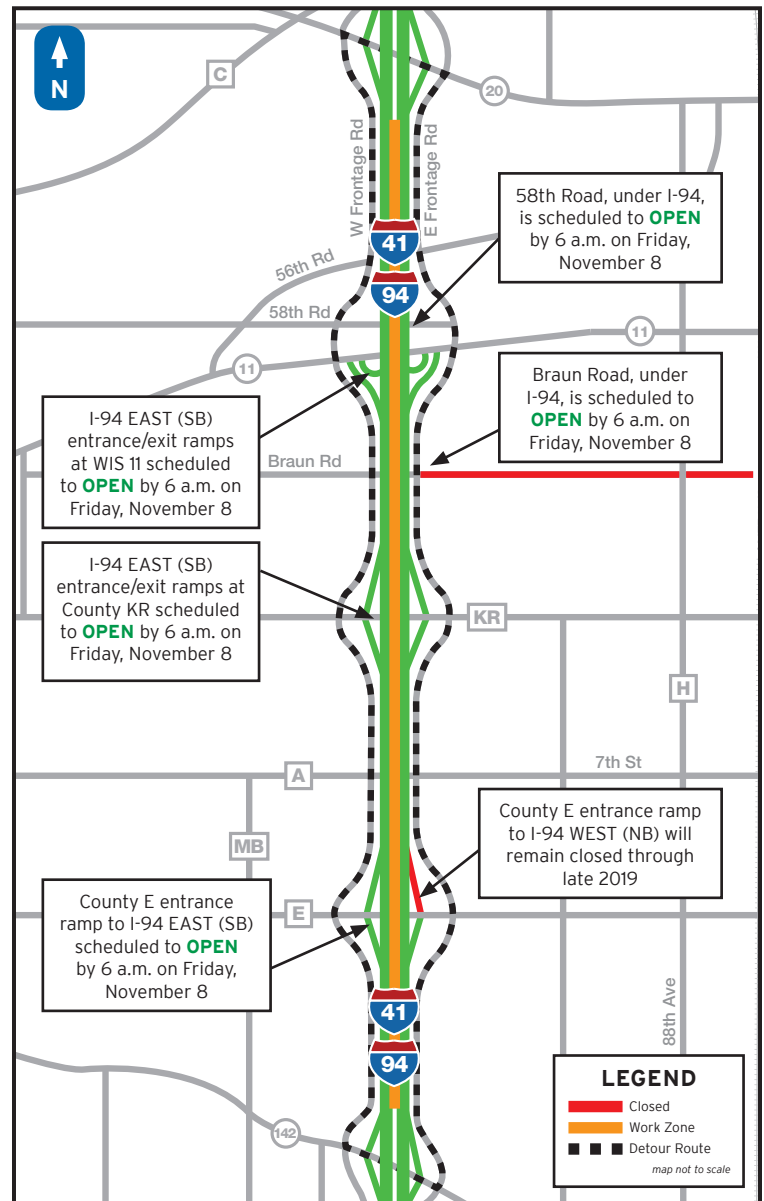

The project team thanks you for your patience and cooperation throughout this project!



Find us online at:
projects.511wi.gov



Find us on Facebook at:
Wisconsin Plan 94



Find us on Twitter at:
@WisDOTsoutheast



Plan Ahead, Drive Safely, Move Forward