

FREEWAY TRAFFIC MANAGEMENT PLAN

NORTH SEGMENT

OCTOBER 2019

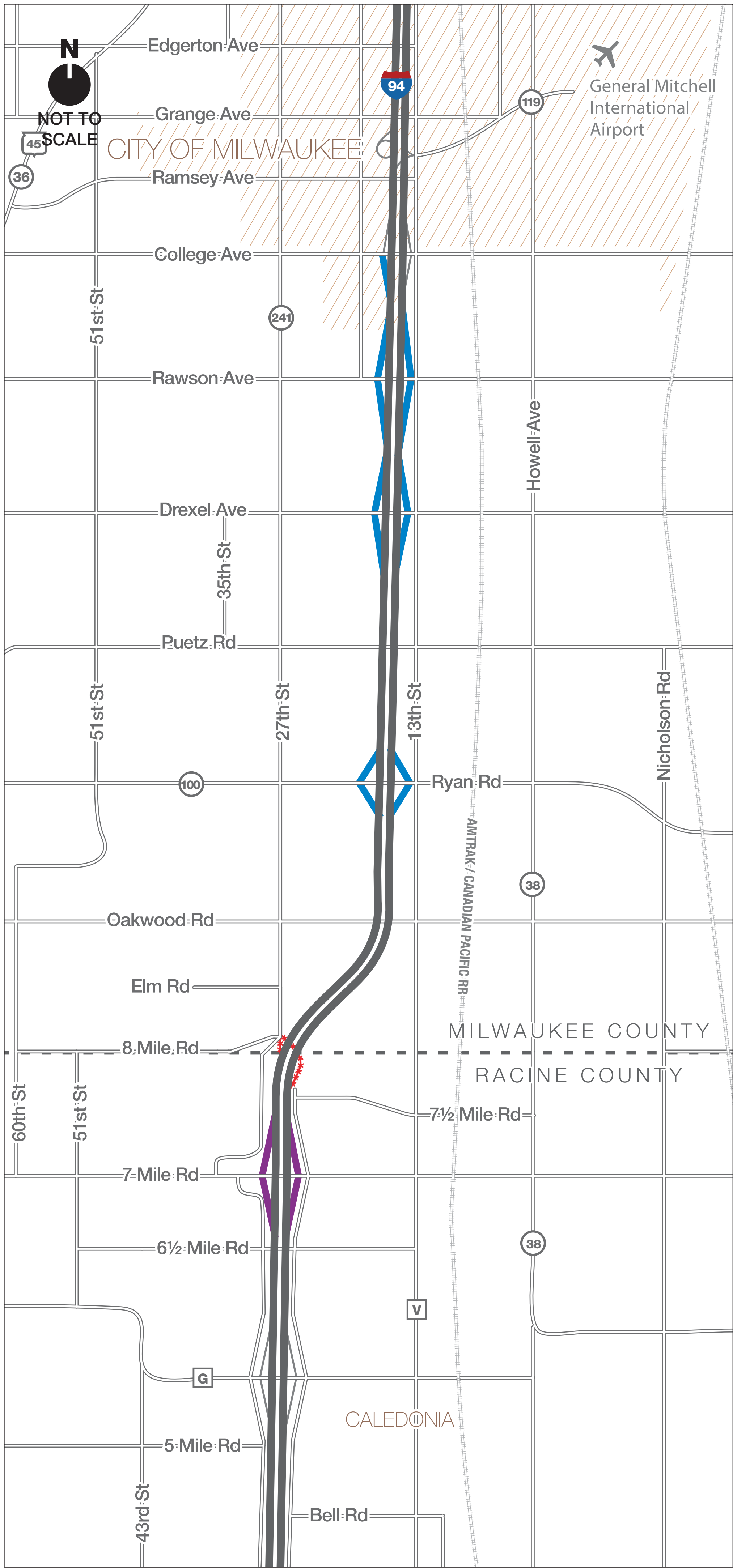

Ramp closures

2018/19 2019

- **COLLEGE AVENUE** to south for one month summer 2019
- **RAWSON AVENUE** while respective side of mainline is constructed
- **DREXEL AVENUE** while respective side of mainline is constructed for 30 days
- **RYAN ROAD** while respective side of mainline is constructed for less than one month
- **27TH STREET** closed permanently
- **SEVEN MILE ROAD** to/from north for 14 days fall 2018 and while respective side of mainline is constructed

Freeway construction staging

Late September through mid-December 2018

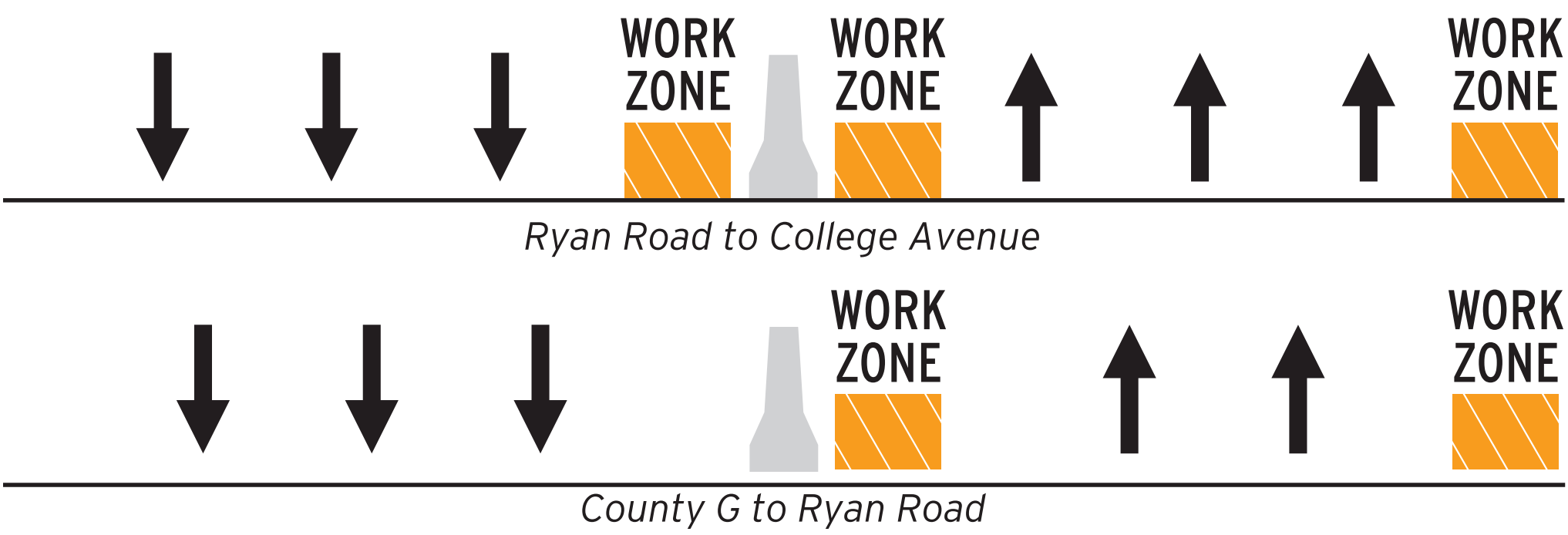

February 2019 through mid-April 2019

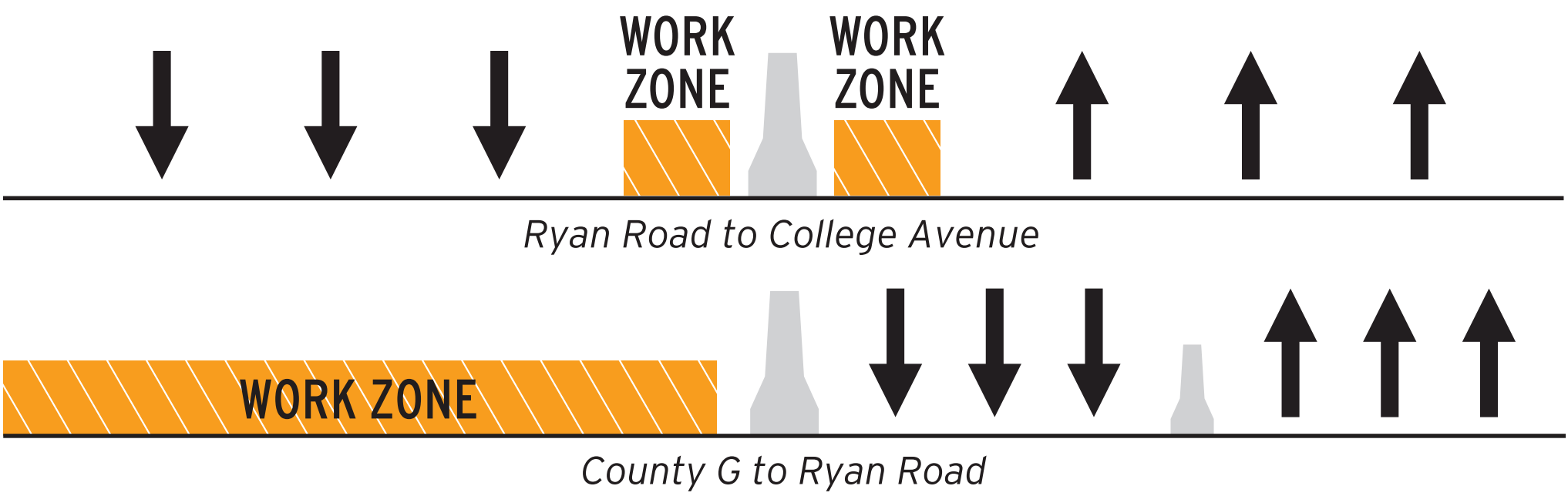

Mid-April through Summer 2019



Mid-Summer 2019



Early Fall through Late 2019



Late 2019 through June 2020



projects.511wi.gov

