

Project BRIEF

April 9, 2020

I-94 North-South Freeway/WIS 20 Project Information

WIS 20, Between County C/Spring Street and West Frontage Road, to Close Long-Term

The Wisconsin Department of Transportation (WisDOT) is underway with reconstructing the I-94 North-South Freeway. As part of this project, WIS 20, between County C/Spring Street and International Drive, is scheduled to be reconstructed.

Monday, April 13:

- Long-term westbound lane closure on WIS 20, between International Drive and East Frontage Road, is scheduled to occur at 6 a.m.

Wednesday, April 15:

- WIS 20, between County C/Spring Street and West Frontage Road, is scheduled to close at 6 a.m. through fall 2020.

Detour route: Motorists should utilize County C/Spring Street and County V to get around the WIS 20 closure.

Access to businesses and residences between County C/Spring Street and West Frontage Road will be maintained via Greenmonte Drive.

Access to businesses located on Spokes Circle will be maintained via West Frontage Road.

Access to businesses located at the WIS 20 interchange will remain open from the east.

Please note that all work is weather dependent and subject to change.

To learn more about the upcoming construction or to receive project updates, please contact:

Rachel Andreoli

Construction Public Involvement Lead

Email: Rachel@devorpr.com

Phone: (262) 977-0234

The project team thanks you for your patience and cooperation throughout this project!

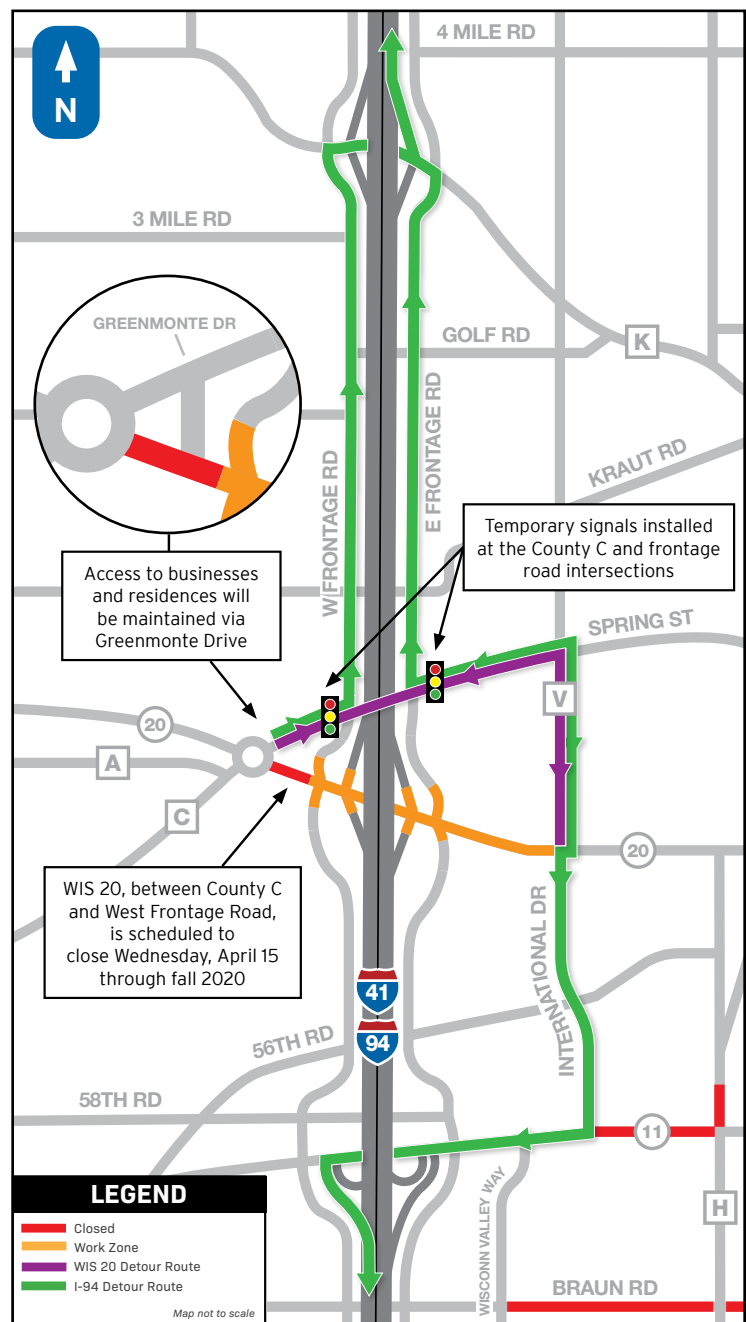

Find us online at:
projects.511wi.gov



Find us on Facebook at:
Wisconsin Plan 94



Find us on Twitter at:
[@WisDOTsoutheast](https://twitter.com/WisDOTsoutheast)



Plan Ahead, Drive Safely, Move Forward