

September 2019

GET AROUND GUIDE

> INTRODUCTION

The Wisconsin Department of Transportation (WisDOT) is well underway with work on the **I-94 North-South corridor in southeast Wisconsin**. This is the fastest-paced Mega Project in WisDOT history. The team is in place to reconstruct 18.5 miles of freeway.

The project limits for this work run from College Avenue to WIS 142, broken into three segments (North, Central and South). The project is reconstructing, expanding and modernizing the freeway. We're adding a fourth lane in each direction, rebuilding five interchanges and building a new interchange at Elm Road.

> IMPORTANCE

I-94 North-South is a vital economic corridor linking the Milwaukee and Chicago metro areas. Commuters, tourists and businesses use the freeway every day to reach destinations in southeastern Wisconsin and beyond.

The federal and state governments are committed to addressing transportation infrastructure needs in this corridor.

> SCHEDULE

This Get Around Guide provides a schedule for the I-94 North-South project for September 2019.

You can view a complete project schedule on-line at: projects.511wi.gov/i94northsouth.

> NORTH SEGMENT OVERVIEW

- Work zone staging to begin late August 2019:

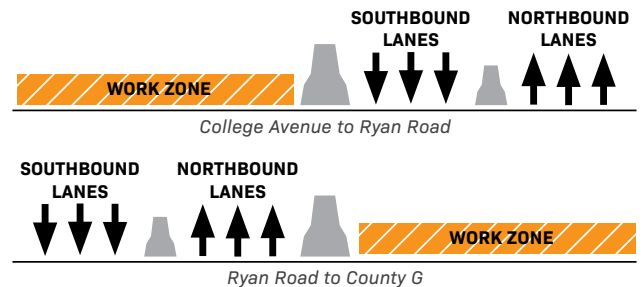

- Mainline reconstruction from County G to College Avenue.
- Freeway is being expanded to four lanes in each direction.
- A new interchange is being constructed at Elm Road.
- 27th Street has been reconstructed, with permanent closure of entrance/exit ramps at I-94.
- Construction is scheduled to be completed in June 2020.

> CENTRAL SEGMENT OVERVIEW

- Work zone staging began June 2019:



- Mainline reconstruction from WIS 20 to County G.
- Freeway is being expanded to four lanes in each direction.
- Construction is scheduled to be completed in late 2019.

> SOUTH SEGMENT OVERVIEW

- Work zone staging began June 2019:



- Mainline reconstruction from WIS 142 to WIS 20.
- Freeway is being expanded to four lanes in each direction.
- Construction is scheduled to be completed in late 2019.

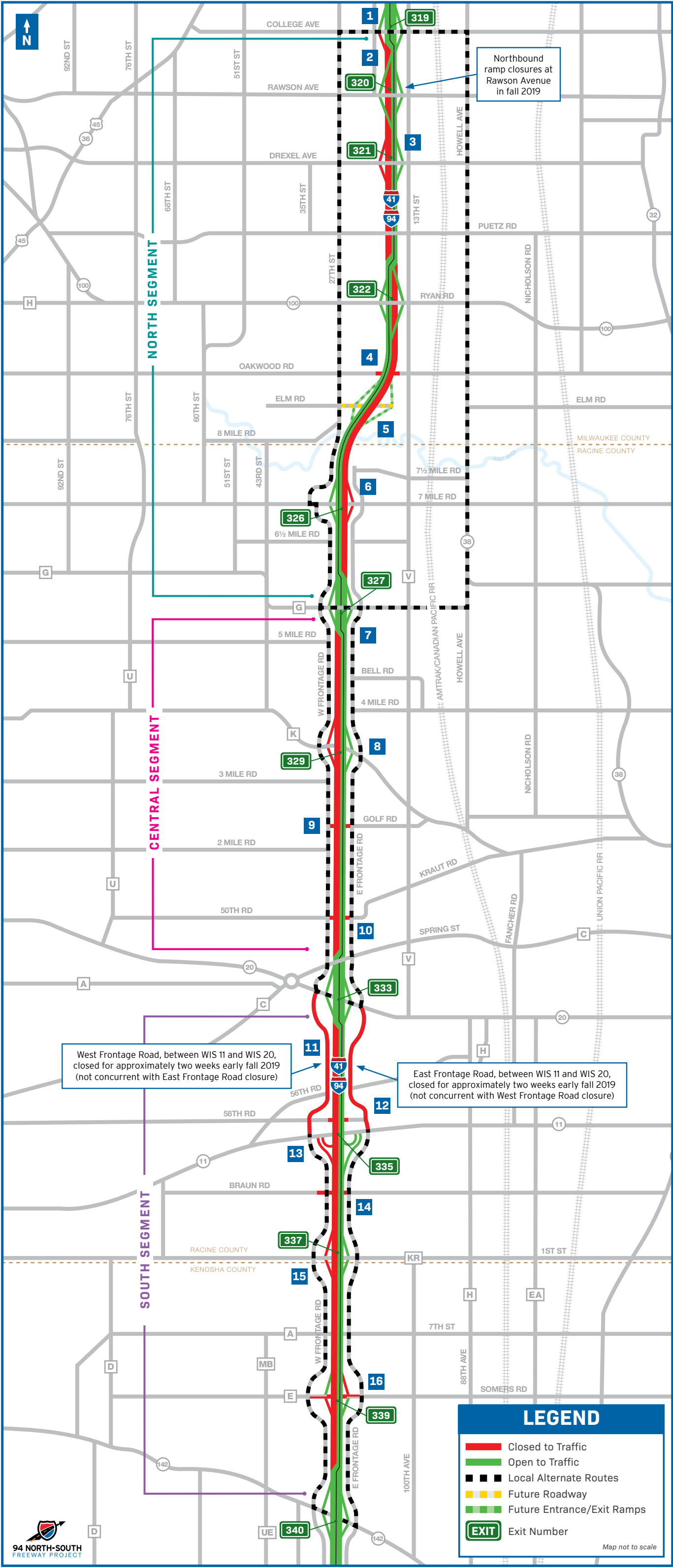

SEPTEMBER 2019

1 I-94 NORTH-SOUTH (COUNTY G-COLLEGE AVENUE)

- I-94 EAST (SB), between College Avenue and Ryan Road, to be reconstructed by fall 2019
- I-94 WEST (NB), between Ryan Road and County G, to be reconstructed by late 2019
- Three lanes of traffic in each direction to be open during daytime hours through late 2019

2 COLLEGE AVENUE 319

- College Avenue entrance ramp to I-94 EAST (SB) closed late summer for approximately one month

3 DREXEL AVENUE 321

- I-94 EAST (SB) exit ramp to Drexel Avenue closed late summer 2019 for approximately one month
- Drexel Avenue entrance ramp to I-94 EAST (SB) closed late summer 2019 for approximately one month

4 OAKWOOD ROAD

- Oakwood Road, under I-94, closed through late 2019

5 ELM ROAD

- Elm Road interchange is currently under construction and is scheduled to open to traffic late spring 2020

6 SEVEN MILE ROAD 326

- I-94 WEST (NB) exit ramp to Seven Mile Road closed late summer through late 2019
- Seven Mile Road entrance ramp to I-94 WEST (NB) closed late summer through late 2019
- Multiple short-term closures of Seven Mile Road, under I-94, late summer and late fall 2019

7 I-94 NORTH-SOUTH (WIS 20-COUNTY G)

- I-94 EAST (SB), between WIS 20 and County G, to be reconstructed by late 2019
- Three lanes of traffic in each direction to be open during daytime hours through late 2019

8 COUNTY K 329

- County K, under I-94, open to one lane of traffic in each direction through late 2019
- I-94 EAST (SB) exit ramp to County K closed through fall 2019
- County K entrance ramp to I-94 EAST (SB) closed through fall 2019

9 GOLF ROAD

- Golf Road, under I-94, closed through fall 2019

10 KRAUT ROAD

- Kraut Road, under I-94, closed through fall 2019

11 I-94 NORTH-SOUTH (WIS 142-WIS 20)

- I-94 EAST (SB), between WIS 142 and WIS 20, to be reconstructed by late 2019
- Three lanes of traffic in each direction to be open during daytime hours through late 2019

12 58TH ROAD

- 58th Road, under I-94, closed through fall 2019

13 WIS 11 335

- WIS 11, under I-94, open to one lane of traffic in each direction through late 2019
- I-94 EAST (SB) exit ramp to WIS 11 closed through fall 2019
- WIS 11 entrance ramp to I-94 EAST (SB) closed through fall 2019
- East Frontage Road and West Frontage Road, between WIS 11 and WIS 20, closed for approximately two weeks early fall 2019 (not concurrent with each other)

14 BRAUN ROAD

- Braun Road, under I-94, closed through fall 2019
- Braun Road, west of West Frontage Road, closed mid-summer through early fall 2019

15 COUNTY KR 337

- County KR, under I-94, open to one lane of traffic in each direction through late 2019
- I-94 EAST (SB) exit ramp to County KR closed through fall 2019
- County KR entrance ramp to I-94 EAST (SB) closed through fall 2019

16 COUNTY E 339

- County E, under I-94, closed through early fall 2019
- County E entrance ramp to I-94 EAST (SB) closed through fall 2019
- County E entrance ramp to I-94 WEST (NB) closed through late 2019

LOCAL ALTERNATE ROUTES

- North Segment:** Motorists are encouraged to use West Frontage Road, 27th Street, and WIS 38 to get around the ramp and crossroad closures
- Central Segment:** Motorists are encouraged to use WIS 20, County G, and the frontage roads to get around the ramp and crossroad closures
- South Segment:** Motorists are encouraged to use WIS 142, WIS 20, and the frontage roads to get around the ramp and crossroad closures

***View Regional Alternate Routes on-line at**
projects.511wi.gov/i94northsouth



HOW DO I GET AROUND THE PROJECT?

PARK & RIDE: The following Park & Ride lots are located along the I-94 North-South project corridor:

- > I-43/894 and Loomis Road
- > I-43/94 and Holt Avenue
- > I-94 and College Avenue
- > I-94 and Ryan Road
- > I-94 and WIS 20
- > I-94 and WIS 11 (*Closed*)
- > Renaissance Boulevard and E. Exploration Court (Sturtevant Train Station)
- > 5413 13th Avenue (Kenosha Metra Train Station)
- > WIS 165 and Terwall Terrace (Pleasant Prairie Rec Plex)

AIRPORT CONNECTION: Transportation service linking Milwaukee's General Mitchell Airport, as well as Chicago's O'Hare and Midway Airports, with all of Southeastern Wisconsin. goriteway.com

AMTRAK HIAWATHA: With seven round-trips daily between Milwaukee and Chicago, you can just sit back and relax and avoid the traffic. amtrakhiawatha.com

MILWAUKEE COUNTY TRANSIT SYSTEM: The Milwaukee County Transit system connects 40 million riders a year with jobs, school, shopping, healthcare and recreation in Milwaukee County. ridemcts.com

RYDE: The Belle Urban System is now RYDE, connecting you to work, school, entertainment and much more throughout Racine. cityofracine.org/Racine-Transit/

COACH USA: Regional transportation provider with service from downtown Milwaukee to many southeast Wisconsin cities, General Mitchell Airport, and O'Hare airport in Chicago. coachusa.com

MEGABUS: The Madison to Chicago routes solve your Midwest travel plans. us.megabus.com



SAFETY

WATCH YOUR SPEED: The speed limit is reduced in the work zone.

STAY OFF YOUR PHONE:

No use of handheld mobile devices in the work zone.

IN CASE OF AN

EMERGENCY: Note that there are limited shoulders to utilize in emergency situations throughout the project (except at WIS 142, WIS 20, and County G).

DON'T GET PULLED OVER: There is increased law enforcement in the project corridor.

IT WILL COST YOU: Fines double in the work zone.



FOLLOW US



projects.511wi.gov/i94northsouth



twitter.com/WisDOTsoutheast



facebook.com/WisconsinPlan94

If you would like to be added to the I-94 North-South distribution list to receive future project updates, contact:

Rachel Andreoli

Construction Public Involvement Lead

(262) 977-0234

Rachel@devorpr.com

You can find additional project information on-line at:

projects.511wi.gov/i94northsouth