

Fall 2018

# GET AROUND GUIDE

## > INTRODUCTION

The Wisconsin Department of Transportation (WisDOT) is accelerating work of the **I-94 North-South corridor in southeast Wisconsin**. This is the fastest-paced Mega Project in WisDOT history. A team is in place to build 18.5 miles of freeway and reopen all lanes of traffic by Memorial Day 2020. The project limits for this work run from College Avenue to WIS 142, broken into three segments (North, Central and South).

The project will reconstruct, expand and modernize the freeway. We're adding a fourth lane in each direction, rebuilding five interchanges and building a new interchange at Elm Road.

## > IMPORTANCE

I-94 North-South is a vital economic corridor linking the Milwaukee and Chicago metro areas. Commuters, tourists and businesses use the freeway every day to reach destinations in southeastern Wisconsin and beyond.

*The federal and state governments are committed to addressing transportation infrastructure needs in this area.*

## > SCHEDULE

This Get Around Guide provides a schedule for the I-94 North-South project for fall 2018.

You can view a complete project schedule on-line at: [projects.511wi.gov/i94northsouth](http://projects.511wi.gov/i94northsouth).

## > SOUTH SEGMENT OVERVIEW

- Construction began in mid-June 2018 and is scheduled to be completed in November 2019.
- 6.5 miles of mainline reconstruction from WIS 142 to WIS 20.
- Freeway will be expanded to four lanes in each direction.
- The work zone staging currently looks as follows:



## > CENTRAL SEGMENT OVERVIEW

- Construction began in mid-July 2018 and is scheduled to be completed in November 2019.
- 4.5 miles of mainline reconstruction from WIS 20 to County G.
- Freeway will be expanded to four lanes in each direction.
- The work zone staging currently looks as follows:



## > NORTH SEGMENT OVERVIEW

- Construction began in September 2018 and is scheduled to be completed in May 2020.
- 7.5 miles of mainline reconstruction from County G to College Avenue.
- Freeway will be expanded to four lanes in each direction.
- A new interchange will be constructed at Elm Road.
- 27th Street has been reconstructed, with permanent closure of entrance/exit ramps at I-94.
- The work zone staging currently looks as follows:

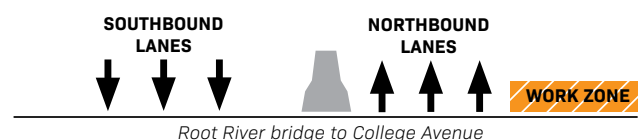
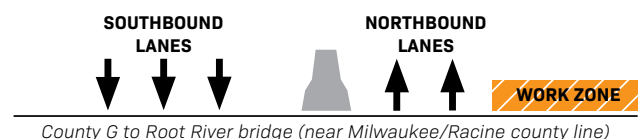

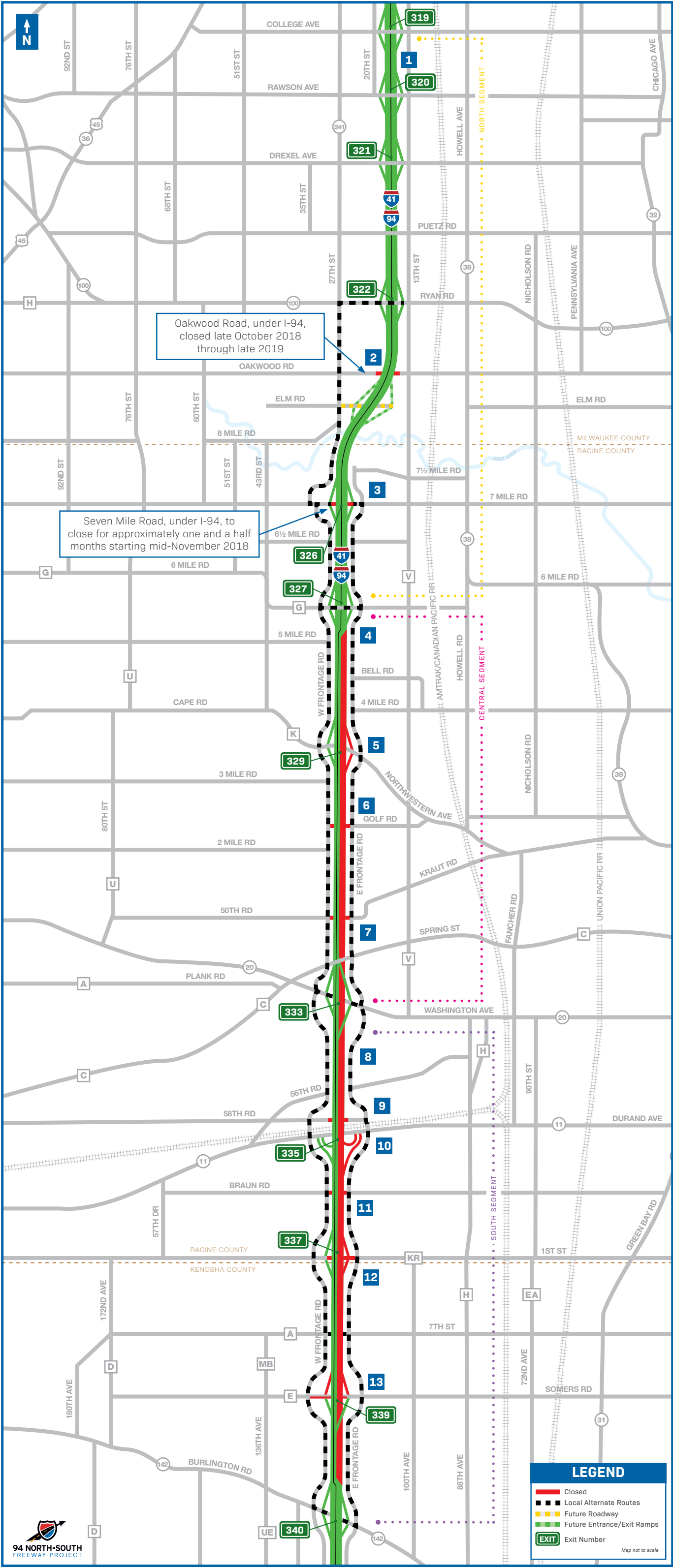

## FALL 2018

### 1 I-94 NORTH-SOUTH (COUNTY G - COLLEGE AVE.)

- Work zone prep on I-94 WEST (NB) shoulders through late 2018
- I-94 WEST (NB) reduced to 2-lanes from County G to just north of the Root River bridge (near Milwaukee/Racine county line) through late 2018

### 2 OAKWOOD ROAD

- Oakwood Road, under I-94, closed late October 2018 through late 2019

### 3 SEVEN MILE ROAD 326

- Seven Mile Road, under I-94, closed for approximately one and a half months starting mid-November 2018

### 4 I-94 NORTH-SOUTH (WIS 20 - COUNTY G)

- I-94 WEST (NB), between WIS 20 and County G, to be reconstructed through late 2018
- Open to 2-lanes of traffic in each direction through late 2018

### 5 COUNTY K 329

- County K entrance ramp to I-94 WEST (NB) closed through late 2018
- I-94 WEST (NB) exit ramp to County K closed through late 2018

### 6 GOLF ROAD

- Golf Road, under I-94, closed through late 2019

### 7 KRAUT ROAD

- Kraut Road, under I-94, closed through late 2018 and again in spring 2019 through late 2019

### 8 I-94 NORTH-SOUTH (WIS 142 - WIS 20)

- I-94 WEST (NB), between WIS 142 and WIS 20, to be reconstructed through late 2018
- Open to 2-lanes of traffic in each direction through late 2018

### 9 58TH ROAD

- 58th Road, under I-94, closed through late 2019

### 10 WIS 11 335

- WIS 11, under I-94, open to one lane of traffic in each direction through late 2019
- WIS 11 entrance ramp to I-94 WEST (NB) closed through winter 2018/2019
- I-94 WEST (NB) exit ramp to WIS 11 closed through late 2018

### 11 BRAUN ROAD

- Braun Road, under I-94, closed through late 2019

### 12 COUNTY KR 337

- County KR, between I-94 EAST (SB) ramps and East Frontage Road, closed through late 2018
- County KR entrance ramp to I-94 WEST (NB) closed through late 2018
- I-94 WEST (NB) exit ramp to County KR closed through late 2018

### 13 COUNTY E 339

- County E eastbound closed between West Frontage Road and northbound ramps through late 2019
- County E entrance ramp to I-94 WEST (NB) closed through late 2019
- I-94 EAST (SB) exit ramp to County E closed through spring 2019

### LOCAL ALTERNATE ROUTES

- North Segment:** Motorists are encouraged to use West Frontage Road, 27th Street, and WIS 38 to get around the ramp and crossroad closures
- Central Segment:** Motorists are encouraged to use WIS 20, County G, and the frontage roads to get around the ramp and crossroad closures
- South Segment:** Motorists are encouraged to use WIS 142, WIS 20, and the frontage roads to get around the ramp and crossroad closures

**\*View Regional Alternate routes on-line at [projects.511wi.gov/i94nouthsouth](https://projects.511wi.gov/i94nouthsouth)**



## HOW DO I GET AROUND THE PROJECT?

**PARK & RIDE:** The following Park & Ride lots are located along the I-94 North-South project corridor:

- > I-43/894 and Loomis Road
- > I-43/94 and Holt Avenue
- > I-94 and College Avenue
- > I-94 and Ryan Road (*Currently closed until late December 2018*)
- > I-94 and WIS 20
- > I-94 and WIS 11 (*Closed*)
- > Renaissance Boulevard and E. Exploration Court (Sturtevant Train Station)
- > 5413 13th Avenue (Kenosha Metra Train Station)
- > WIS 165 and Terwall Terrace (Pleasant Prairie Rec Plex)

**AIRPORT CONNECTION:** Transportation service linking Milwaukee's General Mitchell Airport, as well as Chicago's O'Hare and Midway Airports, with all of Southeastern Wisconsin. [goriteway.com](http://goriteway.com)

**AMTRAK HIAWATHA:** With seven round-trips daily between Milwaukee and Chicago, you can just sit back and relax and avoid the traffic. [amtrakhiawatha.com](http://amtrakhiawatha.com)

**MILWAUKEE COUNTY TRANSIT SYSTEM:** The Milwaukee County Transit system connects 40 million riders a year with jobs, school, shopping, healthcare and recreation in Milwaukee County. [ridemcts.com](http://ridemcts.com)

**RYDE:** The Belle Urban System is now RYDE, connecting you to work, school, entertainment and much more throughout Racine. [cityofracine.org/Racine-Transit/](http://cityofracine.org/Racine-Transit/)

**COACH USA:** Regional transportation provider with service from downtown Milwaukee to many southeast Wisconsin cities, General Mitchell Airport, and O'Hare airport in Chicago. [coachusa.com](http://coachusa.com)

**MEGABUS:** Our Madison to Chicago route solves your Midwest travel plans. [us.megabus.com](http://us.megabus.com)



## OUR MISSION

### We're creating a better I-94

Our top priorities are to:

- Build I-94 safely with our contractors.
- Maximize mobility so you can plan ahead to get to your destination.
- Demonstrate Wisconsin excellence with an experienced local project team.



## FOLLOW US



[projects.511wi.gov/i94northsouth](http://projects.511wi.gov/i94northsouth)



[twitter.com/WisconsinPlan94](https://twitter.com/WisconsinPlan94)



[facebook.com/WisconsinPlan94](https://facebook.com/WisconsinPlan94)

If you would like to be added to the I-94 North-South distribution list to receive future project updates, contact:

**Michael Pyritz**

WisDOT SER Communications Manager

(262) 521-5373

[Michael.Pyritz@dot.wi.gov](mailto:Michael.Pyritz@dot.wi.gov)

You can also sign up to receive project updates and find additional project information on-line at:

[projects.511wi.gov/i94northsouth](http://projects.511wi.gov/i94northsouth)