

Early Summer 2018

GET AROUND GUIDE

> INTRODUCTION

The Wisconsin Department of Transportation (WisDOT) is accelerating work of the **I-94 North-South corridor in southeast Wisconsin**. This is the fastest-paced Mega Project in WisDOT history. A team is in place to build 18.5 miles of freeway and reopen all lanes of traffic by Memorial Day 2020. The project limits for this work run from College Avenue to WIS 142, broken into three segments (North, Central, and South).

The project will reconstruct, expand and modernize the freeway. We're adding a fourth lane in each direction, rebuilding five interchanges and building a new interchange at Elm Road.

Construction on I-94 North-South began in 2009.

> IMPORTANCE

I-94 North-South is a vital economic corridor linking the Milwaukee and Chicago metro areas. Commuters, tourists and businesses use the freeway every day to reach destinations in southeastern Wisconsin and beyond.

The federal and state governments are committed to addressing transportation infrastructure needs in this area.

> SCHEDULE

This Get Around Guide provides a schedule for the I-94 North-South project for early summer 2018. You can view a complete project schedule on-line at projects.511wi.gov.

> SOUTH SEGMENT OVERVIEW

- Construction is scheduled to begin in mid-June 2018 and be completed in late fall 2019.
- 6.5 miles of mainline reconstruction from WIS 142 to WIS 20.
- I-94 North-South Freeway will be expanded to four lanes in each direction with safety and operational improvements.
- Existing bridges over local roadways will be reconstructed.
- Three interchanges and crossroads will be reconstructed as part of this segment:
 - > County E
 - > County KR
 - > WIS 11

Beginning in mid-June 2018, the South Segment work zone staging will look as follows:

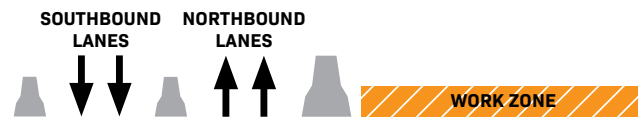

> CENTRAL SEGMENT OVERVIEW

- Construction is scheduled to begin in mid-July 2018 and be completed in late fall 2019.
- 4.5 miles of mainline reconstruction from WIS 20 to County G.
- I-94 North-South Freeway will be expanded to four lanes in each direction with safety and operational improvements.
- Existing bridges over local roadways will be reconstructed.
- County K interchange and crossroad will be reconstructed.

Beginning in mid-July 2018, the Central Segment work zone staging will look as follows:



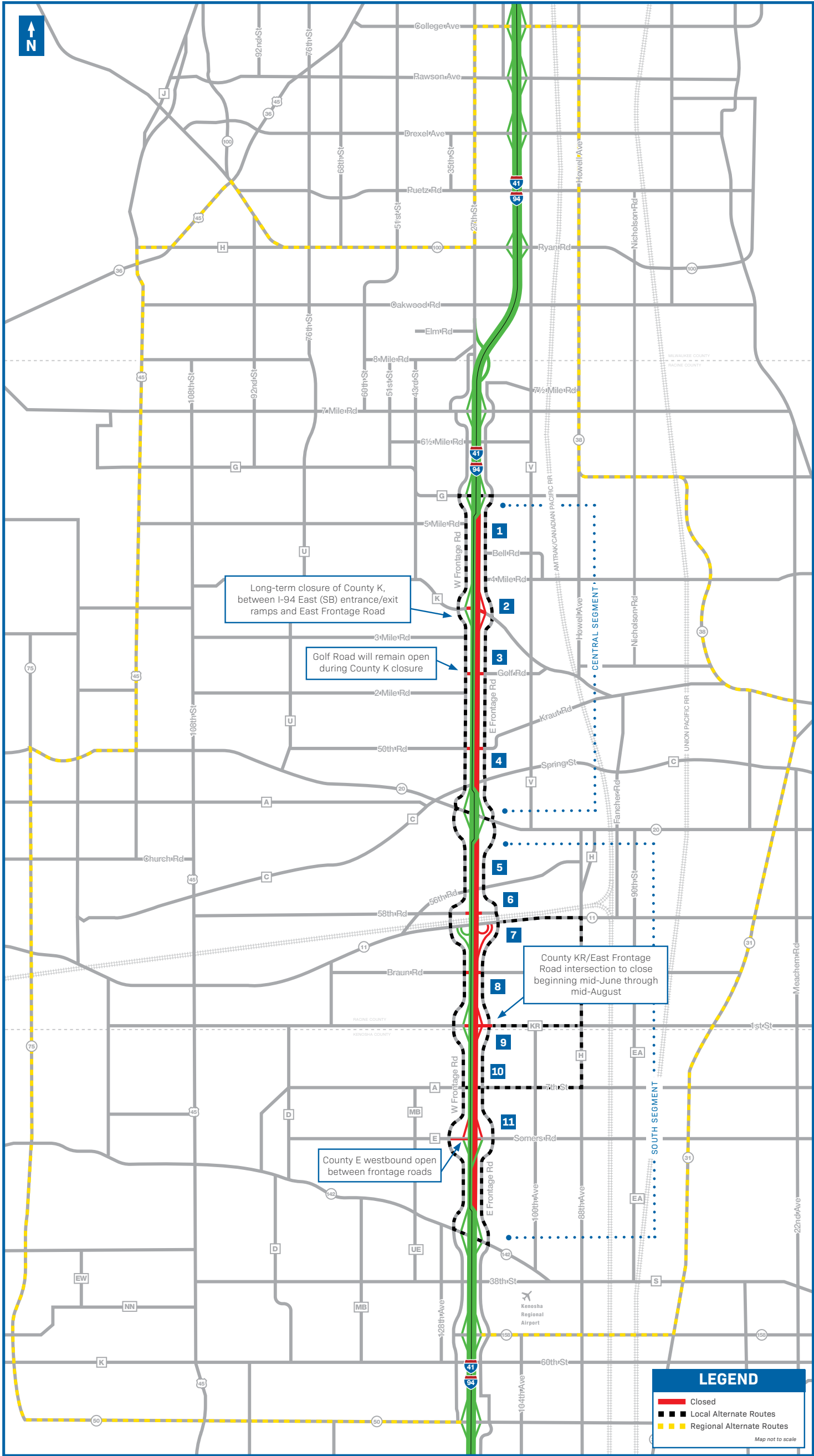

EARLY SUMMER 2018

1 I-94 NORTH-SOUTH (WIS 20 - COUNTY G)

- I-94 West (NB), between WIS 20 and County G, to be reconstructed mid-July through late 2018
- Two lanes of traffic in each direction to be open during daytime hours mid-July through late 2018

2 COUNTY K

- County K, between I-94 East (SB) entrance/exit ramps and East Frontage Road, closed mid-July through late summer 2018
- County K entrance ramp to I-94 West (NB) closed mid-July through late 2018
- I-94 West (NB) exit ramp to County K closed mid-July through late 2018

3 GOLF ROAD

- Golf Road, under I-94, closed mid-July 2018 through late 2019 (except during County K closures)

4 KRAUT ROAD

- Kraut Road, under I-94, closed mid-July 2018 through late 2018 and spring 2019 through late 2019

5 I-94 NORTH-SOUTH (WIS 142 - WIS 20)

- I-94 West (NB), between WIS 142 and WIS 20, to be reconstructed mid-June through late 2018
- Two lanes of traffic in each direction to be open during daytime hours mid-June through late 2018

6 58TH ROAD

- 58th Road, under I-94, closed through late 2019

7 WIS 11

- WIS 11, under I-94, open to one lane of traffic in each direction
- WIS 11 entrance ramp to I-94 West (NB) closed mid-June through winter 2018/2019
- I-94 West (NB) exit ramp to WIS 11 closed mid-June through late 2018

8 BRAUN ROAD

- Braun Road, under I-94, closed through late 2019

9 COUNTY KR

- County KR, under I-94, closed mid-June 2018 through late 2019
- County KR entrance ramp to I-94 West (NB) closed mid-June through late 2018
- I-94 West (NB) exit ramp to County KR closed mid-June through late 2018
- County KR/East Frontage Road intersection to close beginning mid-June through mid-August

10 EAST FRONTAGE ROAD

- Intermittent short-term closures of East Frontage Road, between County A and County KR, mid-August

11 COUNTY E

- County E eastbound, under I-94, closed between West Frontage Road and northbound ramps mid-June 2018 through late 2019
- County E entrance ramp to I-94 West (NB) closed mid-June 2018 through late 2019
- I-94 East (SB) exit ramp to County E closed mid-June 2018 through spring 2019

LOCAL AND REGIONAL ALTERNATE ROUTES

LOCAL ALTERNATE ROUTES:

- Central Segment: Motorists are encouraged to use WIS 20, County G, and the frontage roads to get around the ramp and crossroad closures
- South Segment: Motorists are encouraged to use WIS 142, WIS 20, and the frontage roads to get around the ramp and crossroad closures

REGIONAL ALTERNATE ROUTES:

- Motorists are encouraged to use the signed alternate route west of I-94: College Avenue, 27th Street, WIS 100, WIS 20, WIS 75, and WIS 50 to get around the closures
- Motorists are encouraged to use the signed alternate route east of I-94: WIS 158, WIS 31, Meachem Road, WIS 38, and College Avenue to get around the closures



HOW DO I GET AROUND THE PROJECT?

RIDESHARE PROGRAM: RIDESHARE is a free service provided by the state of Wisconsin. The RIDESHARE matches potential carpoolers and bike poolers based on origins, destinations and work times.

rideshare.wisconsin.gov

PARK & RIDE: The following Park & Ride lots are located along the I-94 North-South project corridor:

- > I-43/894 and Loomis Road
- > I-43/94 and Holt Avenue
- > I-94 and College Avenue
- > I-94 and Ryan Road (*Currently Closed*)
- > I-94 and WIS 20
- > I-94 and WIS 11 (*Currently Closed*)
- > Renaissance Boulevard and E. Exploration Court (Sturtevant Train Station)
- > 5413 13th Avenue (Kenosha Metra Train Station)
- > WIS 165 and Terwall Terrace

AIRPORT CONNECTION: Transportation service linking Milwaukee's General Mitchell Airport, as well as Chicago's O'Hare and Midway Airports, with all of Southeastern Wisconsin. goriteway.com

AMTRAK HIAWATHA: With seven round-trips daily between Milwaukee and Chicago, you can just sit back and relax and avoid the traffic. amtrakhiawatha.com

MILWAUKEE COUNTY TRANSIT SYSTEM: The Milwaukee County Transit system connects 40 million riders a year with jobs, school, shopping, healthcare and recreation in Milwaukee County. ridemcts.com

RYDE: The Belle Urban System is now RYDE, connecting you to work, school, entertainment and much more throughout Racine. cityofracine.org/Racine-Transit/

WISCONSIN COACH LINES: Regional transportation provider with service from downtown Milwaukee to many southeast Wisconsin cities, General Mitchell Airport, and O'Hare airport in Chicago. coachusa.com



OUR MISSION

We're creating a better I-94

Our top priorities are to:

- Build I-94 safely with our contractors.
- Maximize mobility so you can plan ahead to get to your destination.
- Demonstrate Wisconsin excellence with an experienced local project team.



FOLLOW US



projects.511wi.gov



twitter.com/WisconsinPlan94



facebook.com/WisconsinPlan94

If you would like to be added to the I-94 North-South distribution list to receive future project updates, contact:

Michael Pyritz

WisDOT SER Communications Manager

(262) 521-5373

Michael.Pyritz@dot.wi.gov

You can also sign up to receive project updates and find additional project information on-line at:

projects.511wi.gov