

*MAP NOT TO SCALE

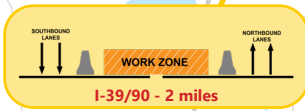

SOUTHBOUND LANES
WORK ZONE
NORTHBOUND LANES

I-39/90 - 2 miles

Stoughton

E. Church Rd.

Cambridge

DANE COUNTY

JEFFERSON COUNTY

ROCK COUNTY

Edgerton



WIS 26 - 1 mile

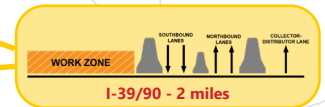

I-39/90 - 2 miles



How to Use this Map



This interactive map shows the type of lane configurations motorists will encounter on most of I-39/90, between the Illinois state line and Madison, during the 2021 construction season.

CLICK on the interactive lane staging diagrams to view photos of the configuration along that section of the Interstate.

WisDOT has designated alternate routes to facilitate major congestion and incident management on the Interstate. View the [alternate route map](#).

LEGEND

Interchange Exit Numbers 142
Lane Crossovers
Rest Area

Janesville

Avalon Rd.

Clinton

Hart Rd/County X

Beloit

Wisconsin/Illinois state line