

I-39/90 Expansion Project



**Business meeting for I-39/90 expansion
between Beloit and Janesville**

August 22, 2017

Overview

- Interstate and segment overview
- I-39/90 expansion between Beloit and Janesville
 - Construction staging
 - Noise barriers: schedule/location
- US 14 and WIS 26 interchange overview
- *In This Together* program
- How to stay informed & involved



Interstate improvements

- Reconstruct and expand 45 miles of I-39/90 from four to six lanes.
- Reconfigure 11 interchanges.
- Replace nearly 100 bridges.
- Expand from four to eight lanes from WIS 11 (Avalon Rd.) to the WIS 26 interchange in Janesville.



Central Segment improvements

- Eight lanes County O to WIS 26
- Six lanes WIS 26 to Dane/Rock Co. Line
- Collector/Distributor lanes at US 14 and WIS 26 interchanges
- Bridges reconstructed
- Bicycle and pedestrian accommodations
- US 14/US 51 alternate route
- Noise barriers
- Construction 2015 through 2022

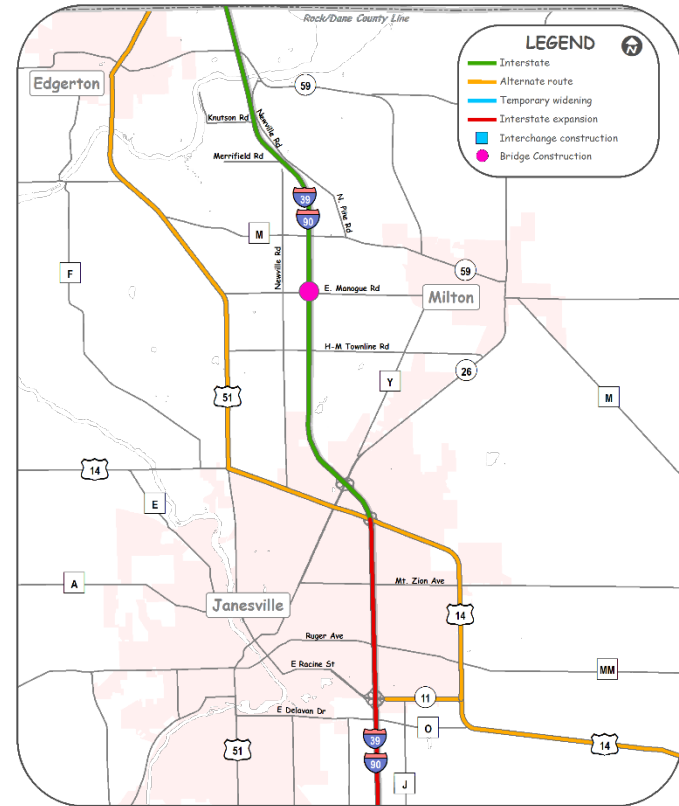

South Segment improvements

- 12 miles from Illinois state line to County O
 - Six lanes from Illinois state line to WIS 11 (Avalon Road)
 - Eight lanes from WIS 11 to County O
- Interchanges reconstructed
- Roadway deficiencies addressed
- To be completed in 2022

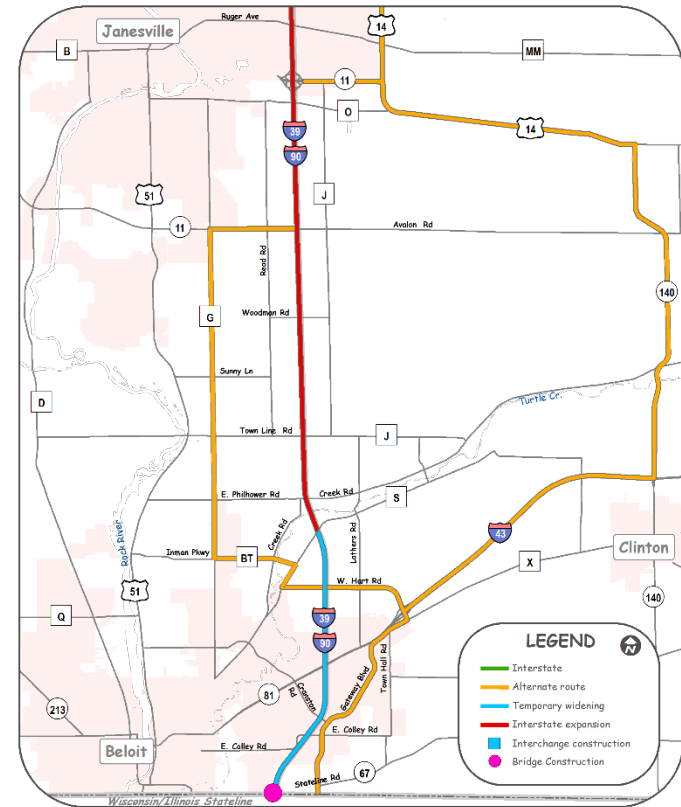

I-39/90 expansion – 2017-2020

Project Overview Map of Construction Area

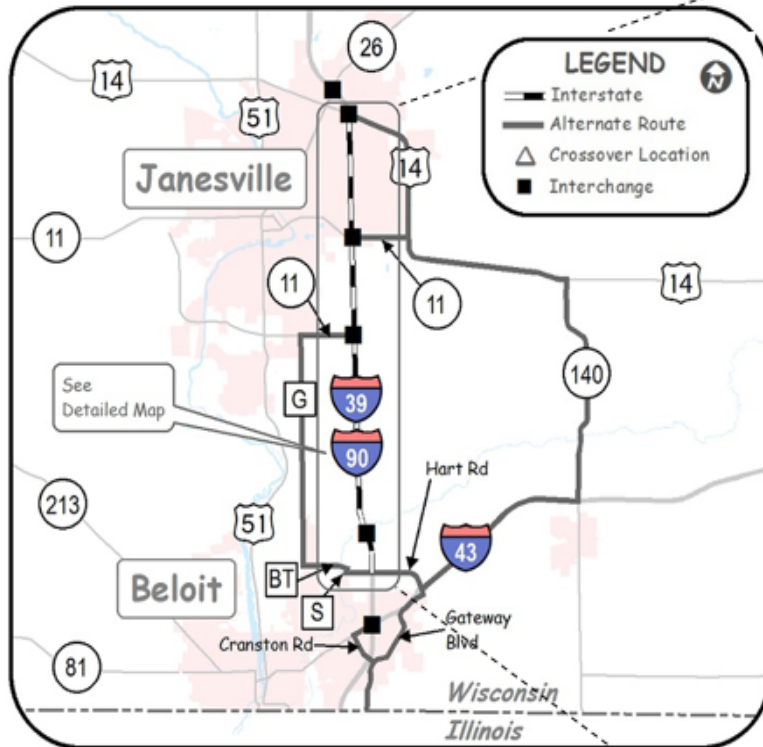

Detailed Map

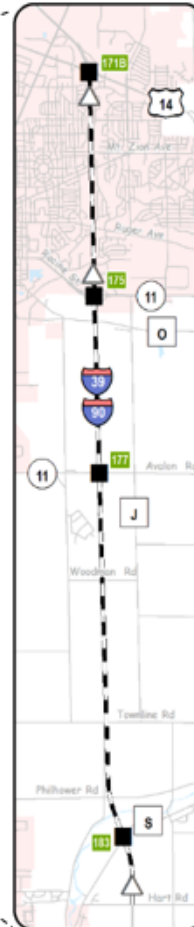

- 12-mile stretch from Hart Road near Beloit to US 14 interchange
- Interstate to be reconstructed and expanded
- Alternate routes available
- This section of work to be completed by 2020

I-39/90 traffic configuration during construction

- Two lanes open in each direction on I-39/90, separated by a temporary median barrier wall.
- Periodic nighttime ramp closures at I-39/90 and WIS 11/Racine Street interchange.
- Crossovers for northbound traffic to occur near Racine Street in fall 2017, and move south to Hart Road in spring 2018.
- All I-39/90 northbound traffic to return to original lanes at US 14 interchange in Janesville.

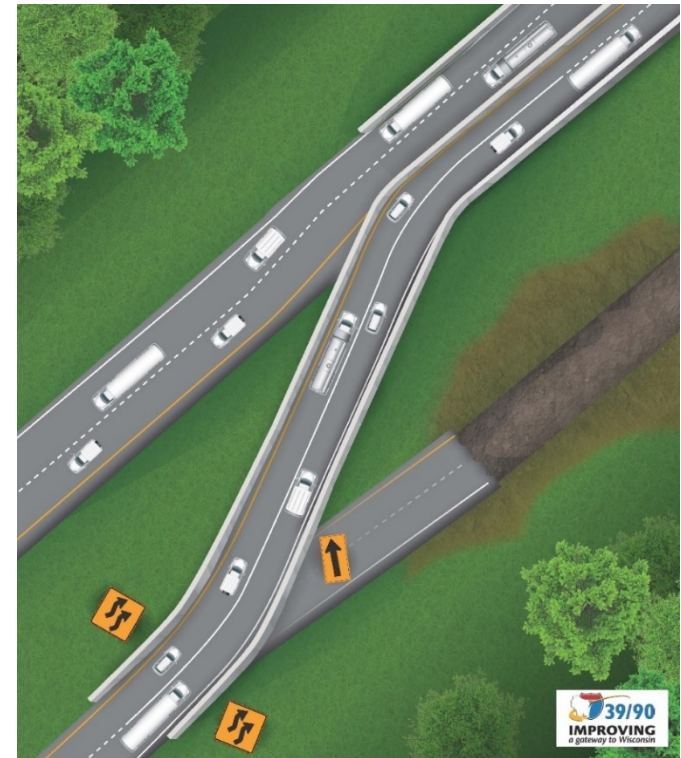

Construction Staging: September – mid-October 2017

**I-39/90 from WIS 11 (Racine St.) interchange
to just south of US 14 (Humes Road) interchange**

Nighttime only

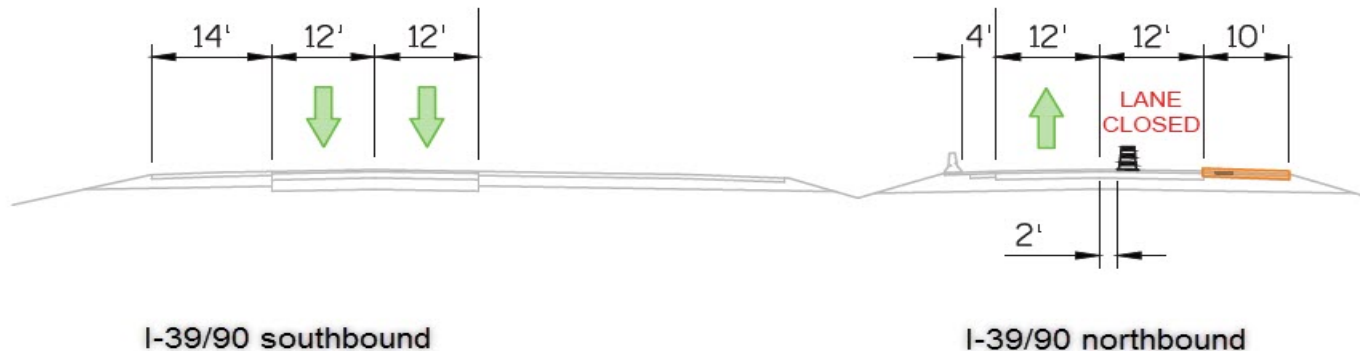

Note: Dates are subject to change.



Construction Staging: Mid-October 2017 – Fall 2018

**I-39/90 from WIS 11 (Racine St.) interchange*
to just south of
US 14 (Humes Road) interchange**

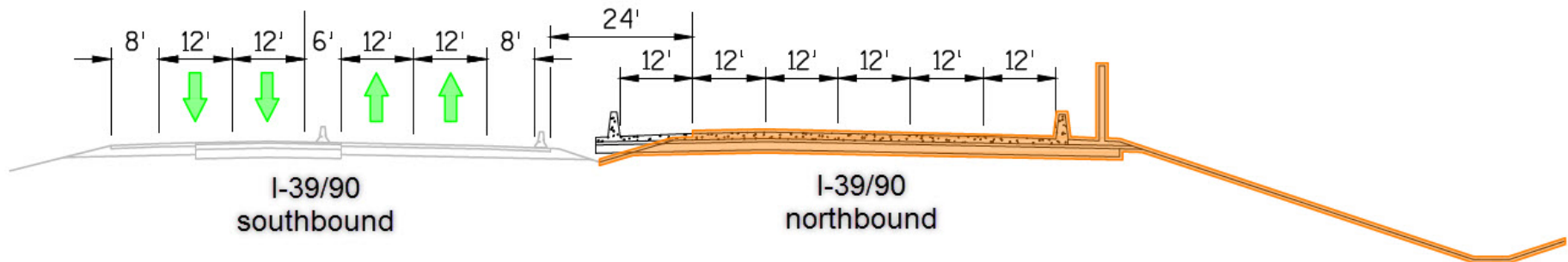

***In spring 2018, northbound crossover to occur
at Hart Road near Beloit**

Note: Dates are subject to change.



Construction Staging: Fall 2018 – Spring 2019

**I-39/90 from Hart Road near Beloit north
to US 14 (Humes Road) interchange**

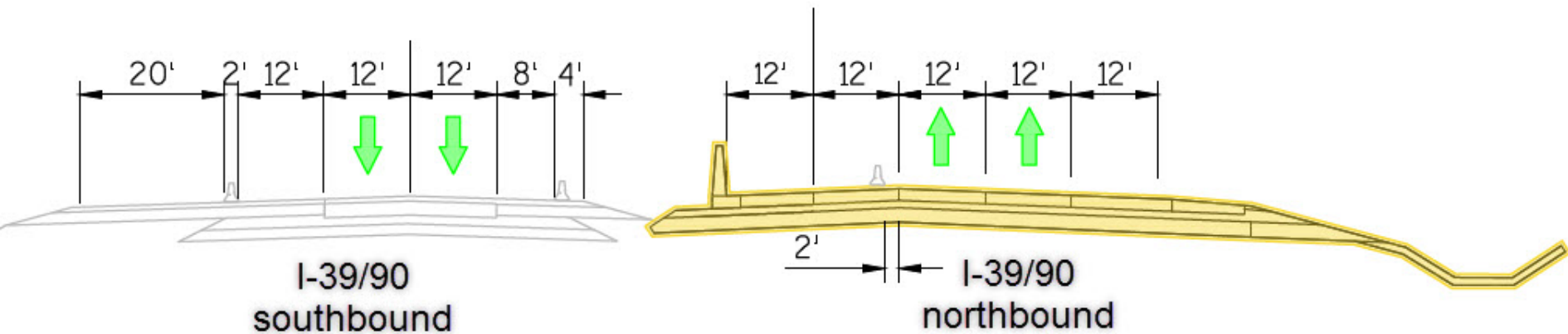

Note: Dates are subject to change.

Construction Staging: Spring 2019 – Fall 2019

**I-39/90 from Hart Road near Beloit north
to US 14 (Humes Road) interchange**

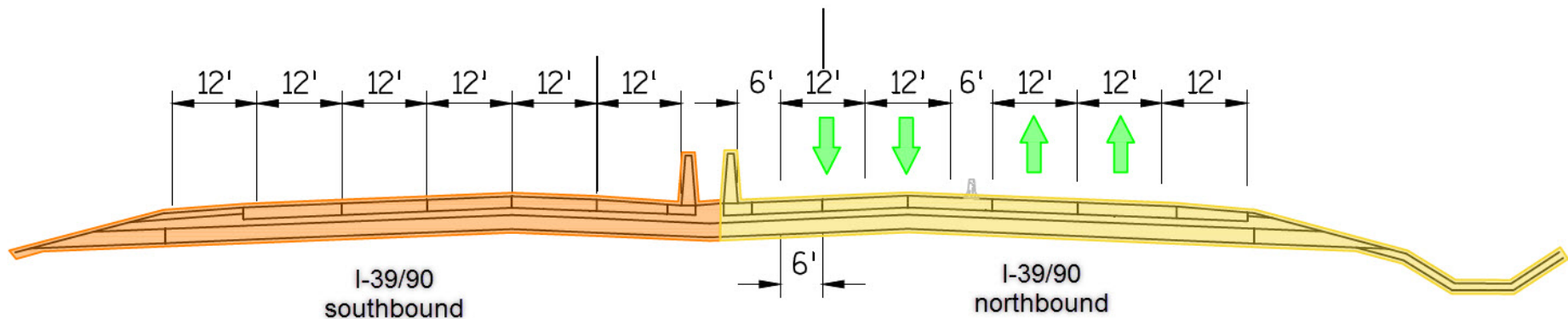

Note: Dates are subject to change.

Construction Staging: Fall 2019 – Spring 2020

**I-39/90 from Hart Road near Beloit north
to US 14 (Humes Road) interchange**

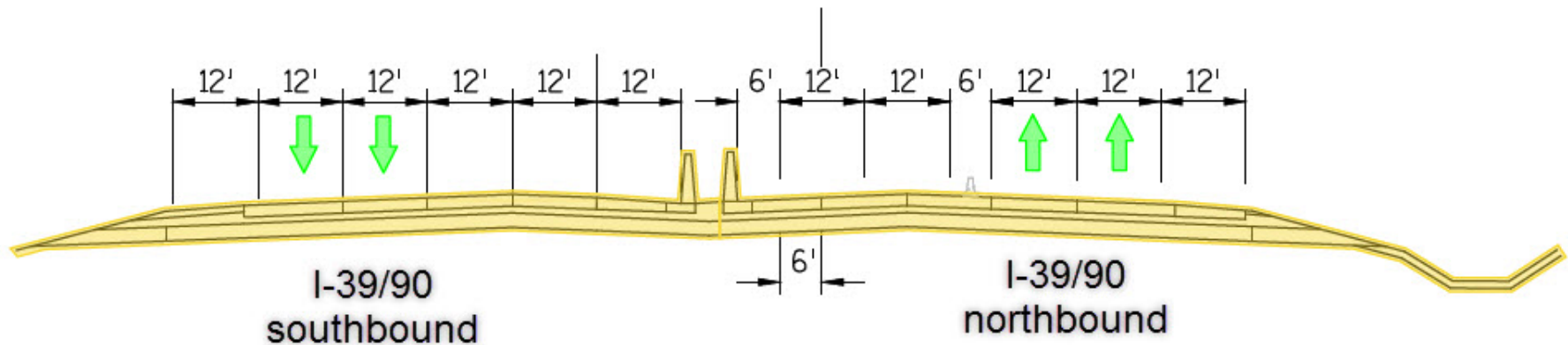

Note: Dates are subject to change.

Construction Staging: Summer 2019 – Summer 2020

I-39/90 just south of US 14 (Humes Rd.) interchange

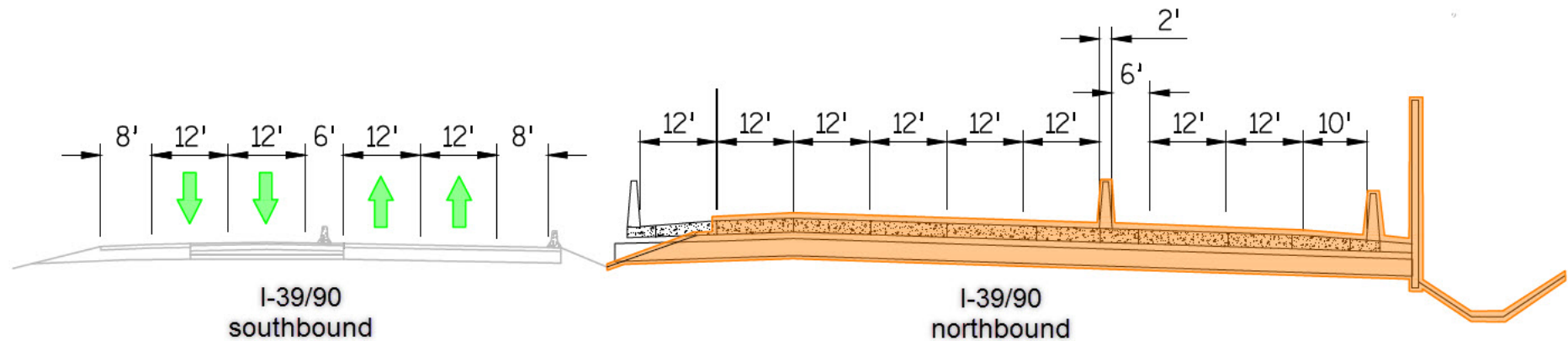

Crossover for all I-39/90 traffic from northbound side to southbound side, just south of US 14 interchange.

Note: Dates are subject to change.

Noise barrier locations



— Noise barrier locations

Noise barriers will not be constructed on bridges

Anticipated schedule of noise barriers (subject to change)

Newville:

- Spring 2018

Janesville:

- I-39/90 northbound: spring/summer 2018
- I-39/90 southbound: summer 2019

Noise Barrier – style and color

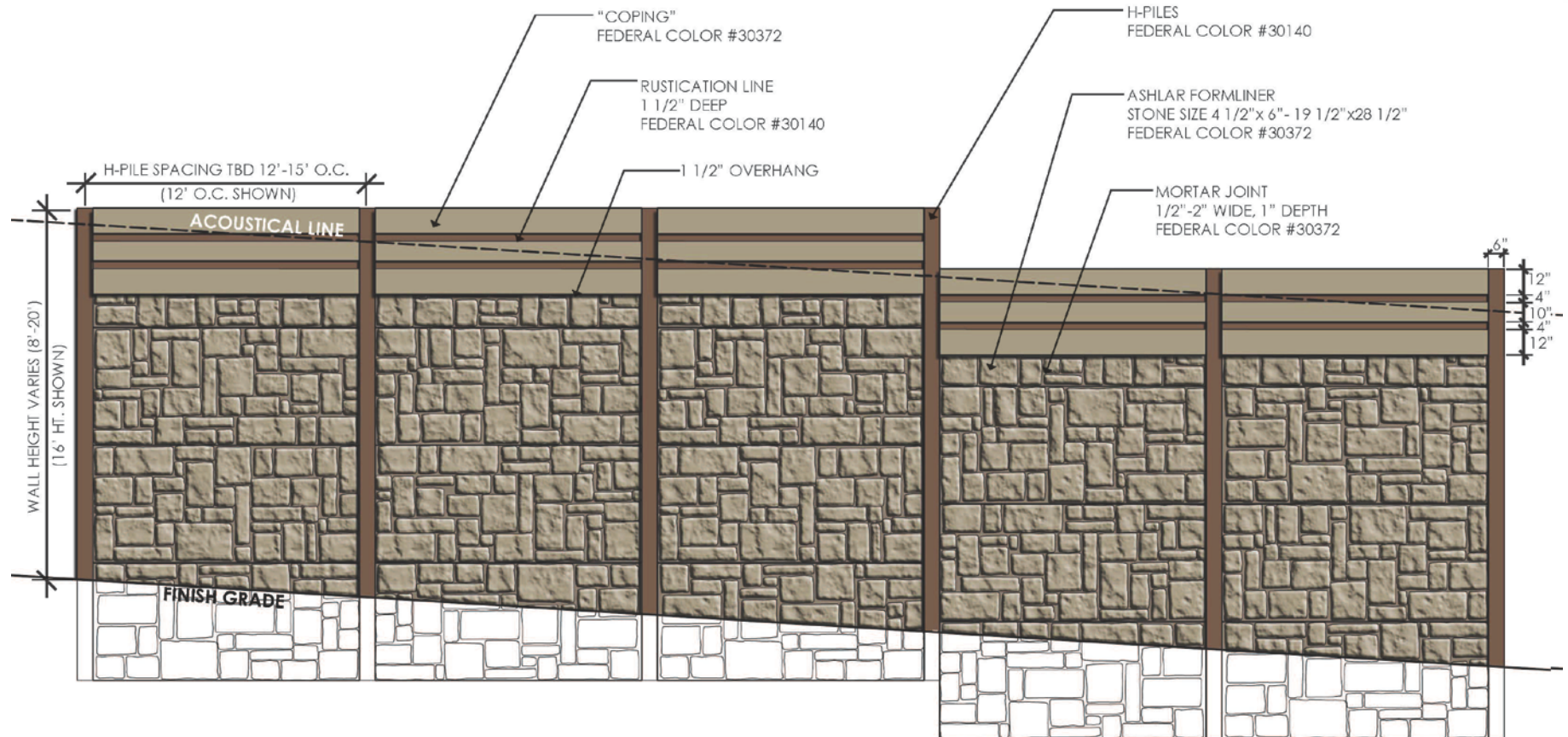

**NOISE WALL CONCEPT 2-1:
BRICK**

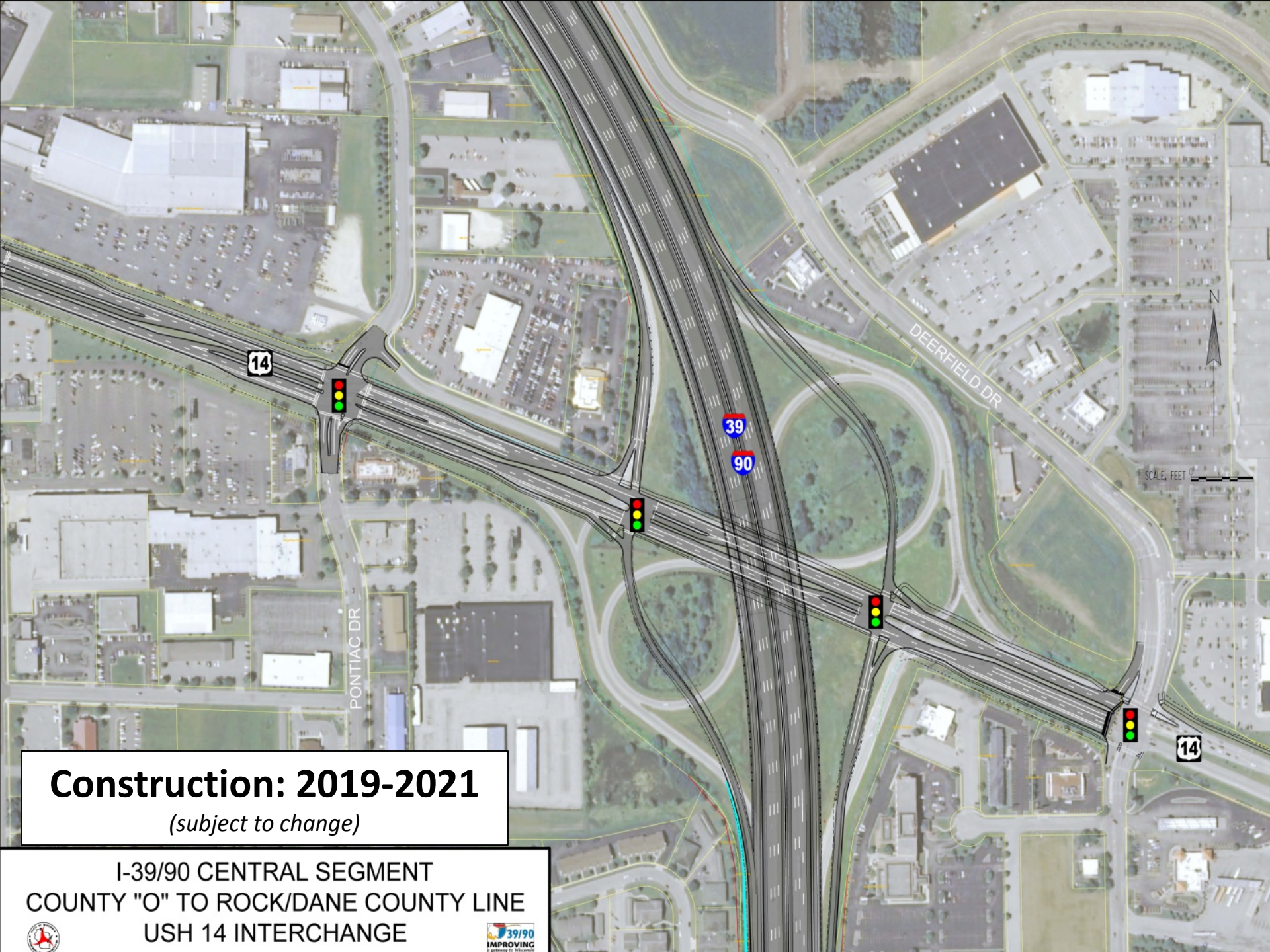

Construction: 2019-2021

(subject to change)

I-39/90 CENTRAL SEGMENT
COUNTY "O" TO ROCK/DANE COUNTY LINE
USH 14 INTERCHANGE



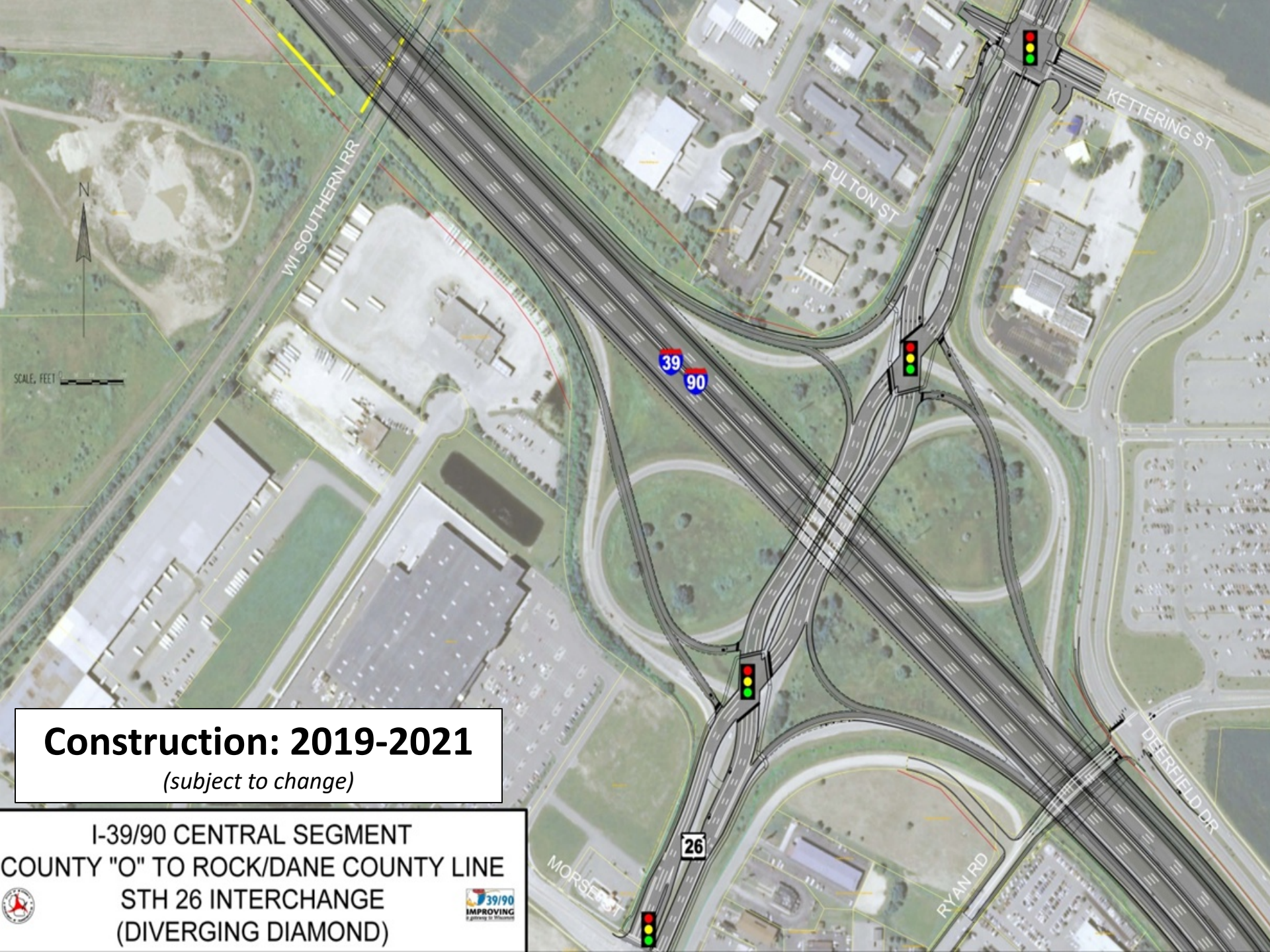

Construction: 2019-2021

(subject to change)

I-39/90 CENTRAL SEGMENT
COUNTY "O" TO ROCK/DANE COUNTY LINE
STH 26 INTERCHANGE
(DIVERGING DIAMOND)





In This Together program

WisDOT recognizes businesses located in or near construction zones are faced with special challenges.

It's critical that customers, employees and delivery vehicles have access to businesses and places of work, regardless of any roadwork inconvenience.



I-39/90 Project website



I-39/90 Expansion Project

Illinois state line to Madison, Dane and Rock Counties

OVERVIEW	SCHEDULE	PROJECT SEGMENTS ▾	MAP	CLOSURES	NEWS	RESOURCES	SIGN UP FOR UPDATES	CONTACTS
----------	----------	--------------------	-----	----------	------	-----------	---------------------	----------

"In This Together" program

The **"In This Together" program** is sponsored by the Wisconsin Department of Transportation (WisDOT) and targets businesses facing road construction in their community. The program's goal is to help businesses maintain daily operations while construction is underway.

WisDOT recognizes that businesses located in or near construction zones have special needs. It is critical that customers, employees and delivery vehicles have access to businesses and places of work, regardless of any roadwork inconvenience.

This program supports economic development in a number of ways:

- Encourages businesses to become proactive in attracting business during construction and working together with WisDOT;
- Provides owners with positive strategies and successful techniques to draw in customers;
- Reduces the fears and frustrations of business owners associated with construction disruptions, delays and detours; and
- Demonstrates that WisDOT wants to help businesses succeed and promote economic development.

Download the **I-39/90 Project, "In This Together" workbook** for other tips and tools.

PROMOTE YOUR BUSINESS DURING CONSTRUCTION

Is your business located within a current work zone related to the I-39/90 Expansion Project? If so, help your business not only survive, but thrive, during construction. Promote your business by uploading your business information to our website. (Please allow 1-3 business days for information to be added.)

- [Submit your business information.](#)

Contact the **I-39/90 Project Team** with any questions regarding your business, including temporary business signage options.

RESOURCES

- **"In This Together" program**
 - Businesses in the work zone
- Brochures and newsletters
- Rock County Stakeholder Advisory Committee
- **Diverging Diamond Interchange**
 - WIS 26 Interchange
 - WIS 11 (Avalon Road) Interchange
- **Roundabouts**
 - County N Interchange
 - WIS 59 Interchange
 - WIS 11 (Racine St.) Interchange
- **Environmental**
 - US 12/18 (Beltline) Interchange
 - I-43/WIS 81 Interchange
 - Noise barriers

Business info at www.i39-90.wi.gov under the Resources tab



Business promotion on WisDOT website



I-39/90 Expansion Project

Illinois state line to Madison, Dane and Rock Counties

OVERVIEW	SCHEDULE	PROJECT SEGMENTS ▾	MAP	CLOSURES	NEWS	RESOURCES	SIGN UP FOR UPDATES	CONTACTS
----------	----------	--------------------	-----	----------	------	-----------	---------------------	----------

Businesses in the work zone

PROMOTE YOUR BUSINESS DURING CONSTRUCTION

Is your business located within a current project work zone related to the I-39/90 Expansion Project? If so, help your business not only survive, but thrive, during construction. Promote your business by uploading your business information to our website. (Please allow 1-3 business days for information to be added.)

- [Submit your business information.](#)
- Download the ["In This Together" workbook](#) for tips and tools to help your business during construction.



BUSINESSES LOCATED ALONG I-39/90 AND RELATED PROJECTS' WORK ZONES

Regardless of any roadwork inconvenience, please continue to patronize area businesses in all work zones.

NOTE: All external hyperlinks are provided for your information and for the benefit of the general public. The Wisconsin Department of Transportation does not testify to, sponsor or endorse the accuracy of the information provided on externally linked pages.

RESOURCES

- ["In This Together" program](#)
 - [Businesses in the work zone](#)
- [Brochures and newsletters](#)
- [Rock County Stakeholder Advisory Committee](#)
- [Diverging Diamond Interchange](#)
 - [WIS 26 Interchange](#)
 - [WIS 11 \(Avalon Road\) Interchange](#)
- [Roundabouts](#)
 - [County N Interchange](#)
 - [WIS 59 Interchange](#)
 - [WIS 11 \(Racine St.\) Interchange](#)
- [Environmental](#)
 - [US 12/18 \(Beltline\) Interchange](#)
 - [I-43/WIS 81 Interchange](#)
 - [Noise barriers](#)



Be proactive

Businesses can take basic actions to not only survive, but thrive, during road construction.



I-39/90 and WIS 73/US 51 interchange near Edgerton, WI



Stay informed

- Meet the on-site project manager – keep his/her telephone number in a handy place.
- Attend public meetings to increase your knowledge of the project.
- **Sign up for project email updates.** Also provide names and emails for others within your organization!



Stay involved

- For any special concerns, coordinate and hold a pre-construction meeting with WisDOT and the contractor.
 - Find out the construction staging, etc.
 - Learn what to expect (i.e., dirt, mud, ground shaking, etc.)
- Participate in project update meetings.



Tips

- Get involved early. Advanced planning and organization pays off.
- Form an alliance with other businesses in your area.
 - Pool resources to purchase group advertising.
- Hold regular, frequent meetings with other businesses to share strategies and support.



Recipe for success

- Partner with neighboring businesses, your local chamber and community leadership.
- Keep your customers informed – update website and social media sites often.
- Provide superior service.
- Stay positive! Customers do notice.

Promotion examples: Partnering and Advertising





Promotion examples: Street Signage





Promotion examples: Websites and social media

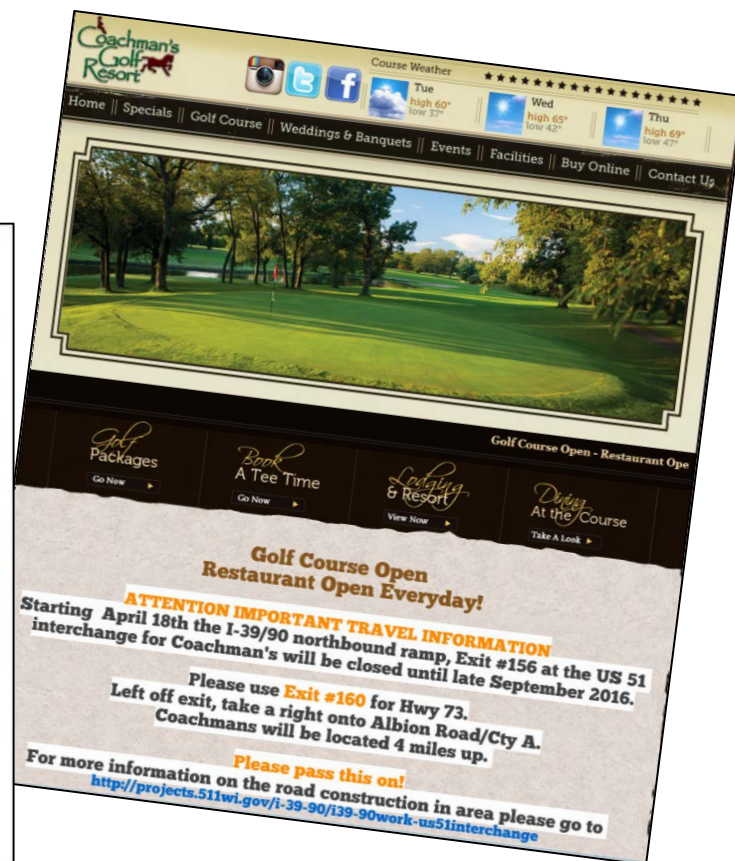
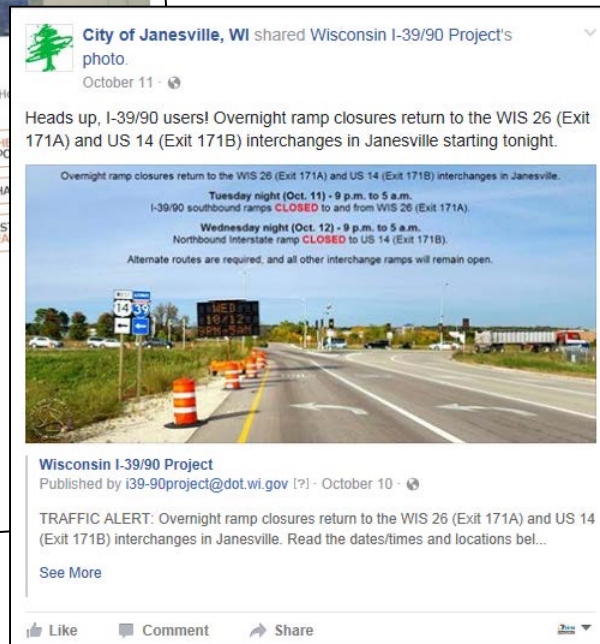
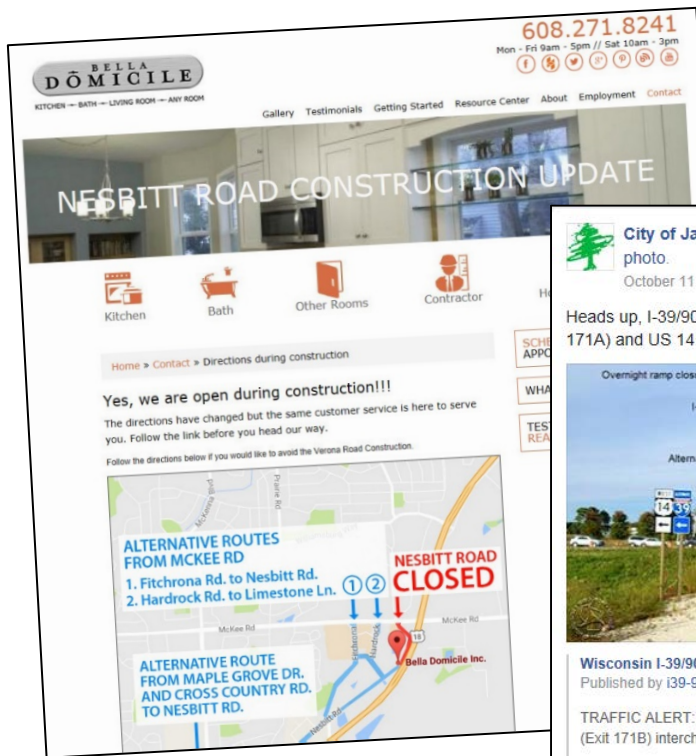

Stay informed and involved!

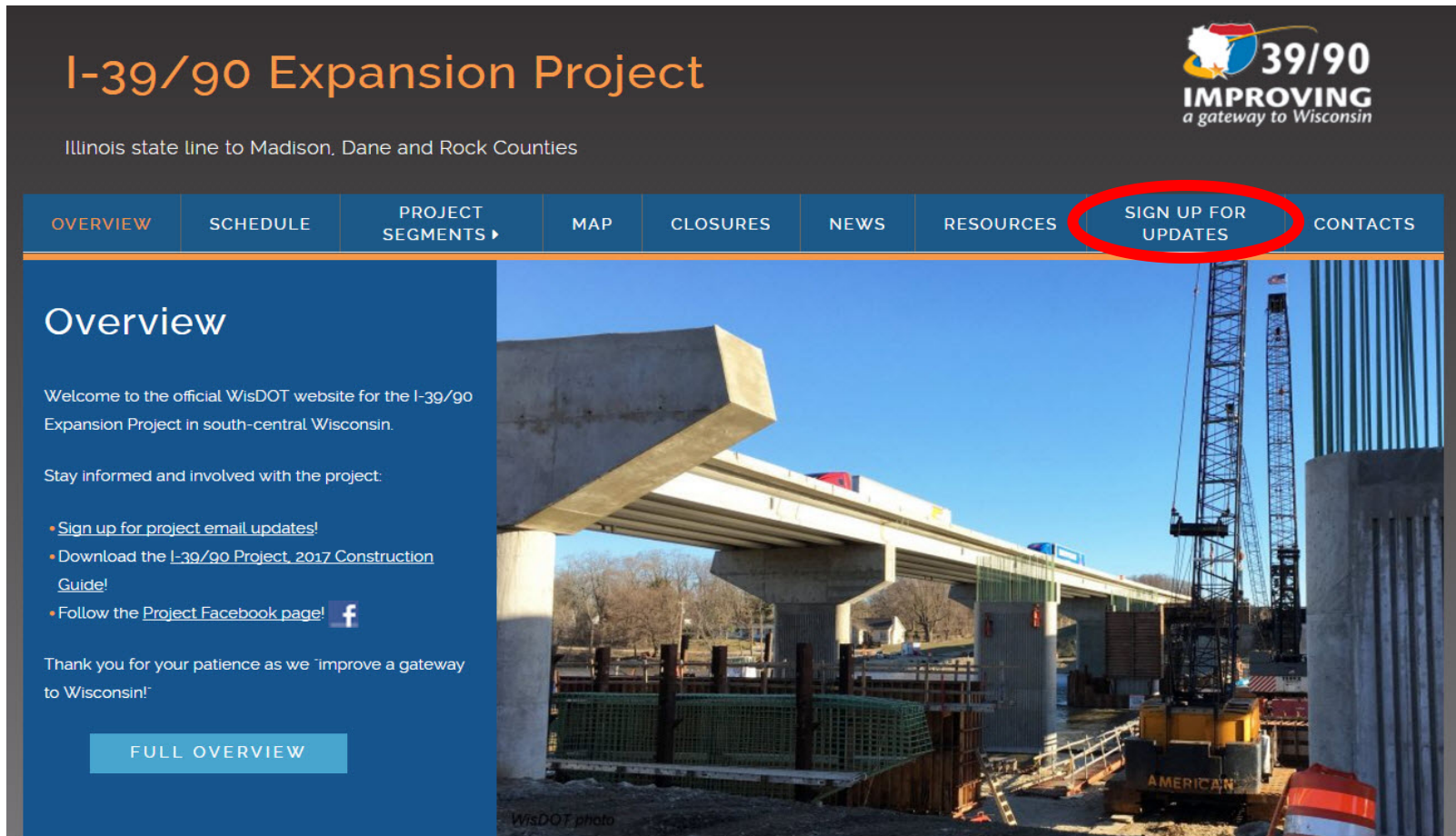

The screenshot shows the official WisDOT website for the I-39/90 Expansion Project. The header features the project title and the I-39/90 logo. A navigation bar includes links for Overview, Schedule, Project Segments, Map, Closures, News, Resources, Sign Up for Updates (highlighted with a red circle), and Contacts. The Overview section on the left welcomes visitors and lists links for email updates, a construction guide, and a Facebook page. A large photograph on the right shows a bridge under construction with cranes and concrete pillars.

I-39/90 Expansion Project

Illinois state line to Madison, Dane and Rock Counties

OVERVIEW | SCHEDULE | PROJECT SEGMENTS ▶ | MAP | CLOSURES | NEWS | RESOURCES | **SIGN UP FOR UPDATES** | CONTACTS

Overview

Welcome to the official WisDOT website for the I-39/90 Expansion Project in south-central Wisconsin.

Stay informed and involved with the project:

- Sign up for project email updates!
- Download the [I-39/90 Project, 2017 Construction Guide!](#)
- Follow the [Project Facebook page!](#) 

Thank you for your patience as we "improve a gateway to Wisconsin!"

[FULL OVERVIEW](#)

WisDOT photo

Register for project email updates at www.i39-90.wi.gov.

Questions?

www.i39-90.wi.gov

i39-90Project@dot.wi.gov

Facebook.com/WisconsinI3990Project

(608) 884-1234