



Wisconsin Department of Transportation

2101 Wright Street Madison, WI 53704-2583 (608) 246-3800 FAX (608) 246-7996 www.dot.wisconsin.gov



I-39/90 & WIS 11 (Racine Street) Interchange Public Information Meeting

May 30, 2012, 4:30 p.m. to 6:30 p.m.

City of Janesville, Municipal Building

Project ID 1001-03-04

Rock County

I-39/90 Central Segment Project Team

John Vesperman, WisDOT I-39/90 Corridor Project Manager

John Steiner, WisDOT I-39/90 Corridor Project Supervisor

James Oettinger, WisDOT I-39/90 Central Segment Project Manager

Todd Hertz, KL Engineering, Inc., I-39/90 Central Segment Consultant Project Manager

Project Information and Schedule

The I-39/90 Corridor Team is preparing plans for the I-39/90 and WIS 11 (Racine Street) interchange reconstruction in Rock County. The selected alternative is a diamond interchange with roundabouts. This alternative was selected based on the following intersection control criteria:

- Lower driver delay
- Reduction of severe crashes
- Lower construction cost

Interchange reconstruction is scheduled for 2013. This project is in the preliminary design stages, but has an accelerated schedule with final plans due in November 2012.

Purpose of the meeting

Present the interchange design plans, answer questions, and to gather the public's input.

We encourage you to review the displays, visit with the project representatives and ask any questions regarding the project. A comment form is attached to this handout for providing written comments. You may leave your comment form at today's meeting or mail it before June 8, 2012.

If you have questions or would like more information, contact WisDOT I-39/90 Central Segment Project Manager James Oettinger at (608) 246-3879 or James.Oettinger@dot.wi.gov. Or visit us online at www.i39-90.wi.gov.



Wisconsin Department of Transportation

2101 Wright Street Madison, WI 53704-2583 (608) 246-3800 FAX (608) 246-7996 www.dot.wisconsin.gov

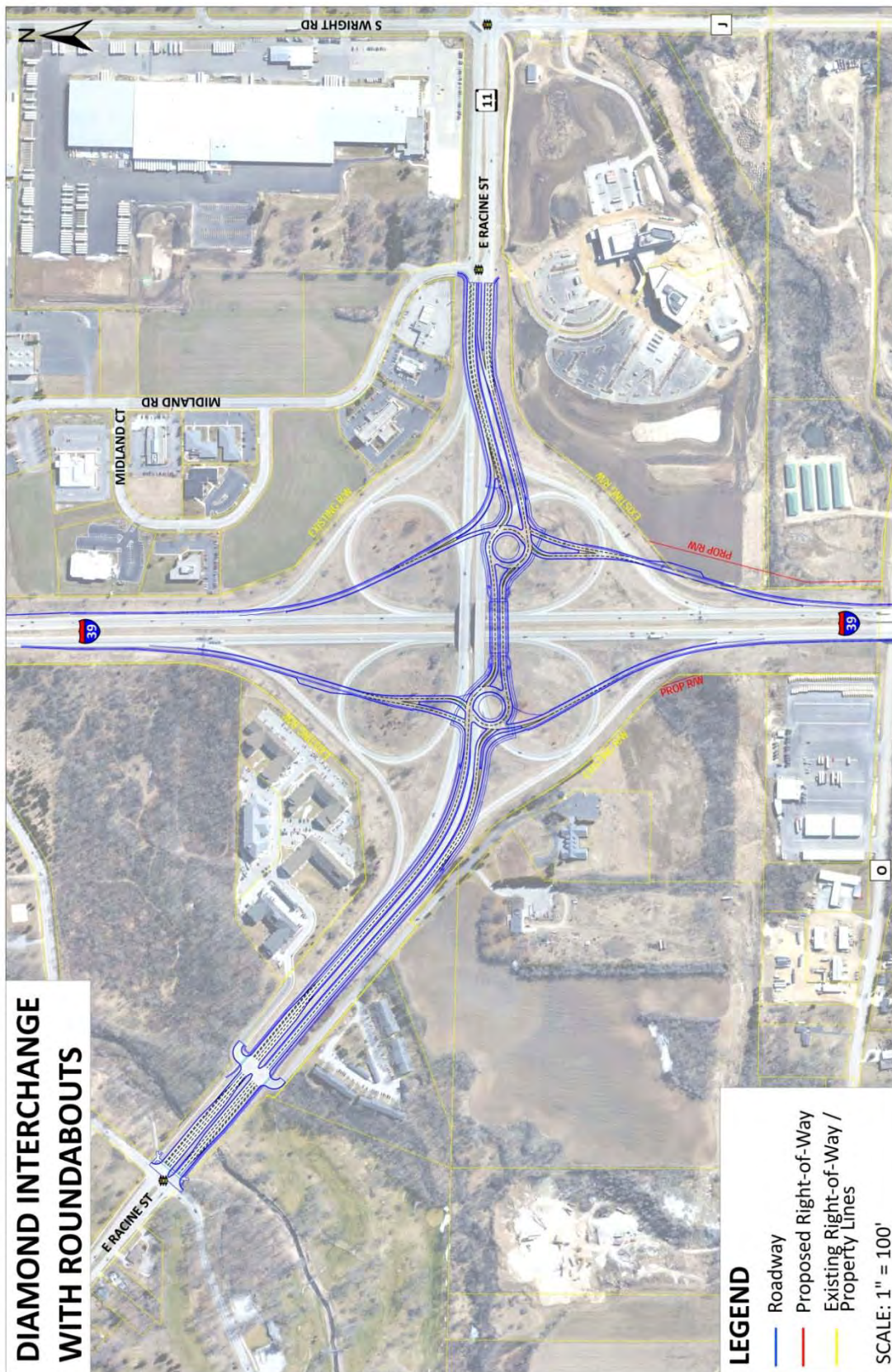

COMMENT SHEET

I-39/90 Central Segment

WIS 11 (Racine Street) Interchange

Public Informational Meeting

Wednesday, May 30, 2012, City of Janesville Municipal Building

Name:
Address:
Representing:

Your input is very important to the **Wisconsin Department of Transportation**. In the space below, please provide your comments regarding the I-39/90 / WIS 11 Interchange. (Please attach another sheet if needed.)

[illegible]

Your comments are important. Please provide all comments by June 8, 2012.

FOLD HERE



Wisconsin Department of Transportation
Southwest Region Office
2101 Wright Street
Madison, WI 53704-2583



Place
Stamp
Here

Attn: James Oettinger
Wisconsin Department of Transportation
WisDOT SW Region Office
2101 Wright Street
Madison, WI 53704-2583

FOLD HERE