

REGIONAL ROUTES to FOXCONN

June 1-June 17, 2018

WisDOT

- » Freeway work zone prep complete on June 9, 2018
- » Frontage roads between KR and WIS 20 complete or very near completion
- » WIS 20, CTH H, and CTH A resurfacing complete

Foxconn

- » Continued mobilization
- » Site work, Phase 1a
- » LCM construction, Phase 1b

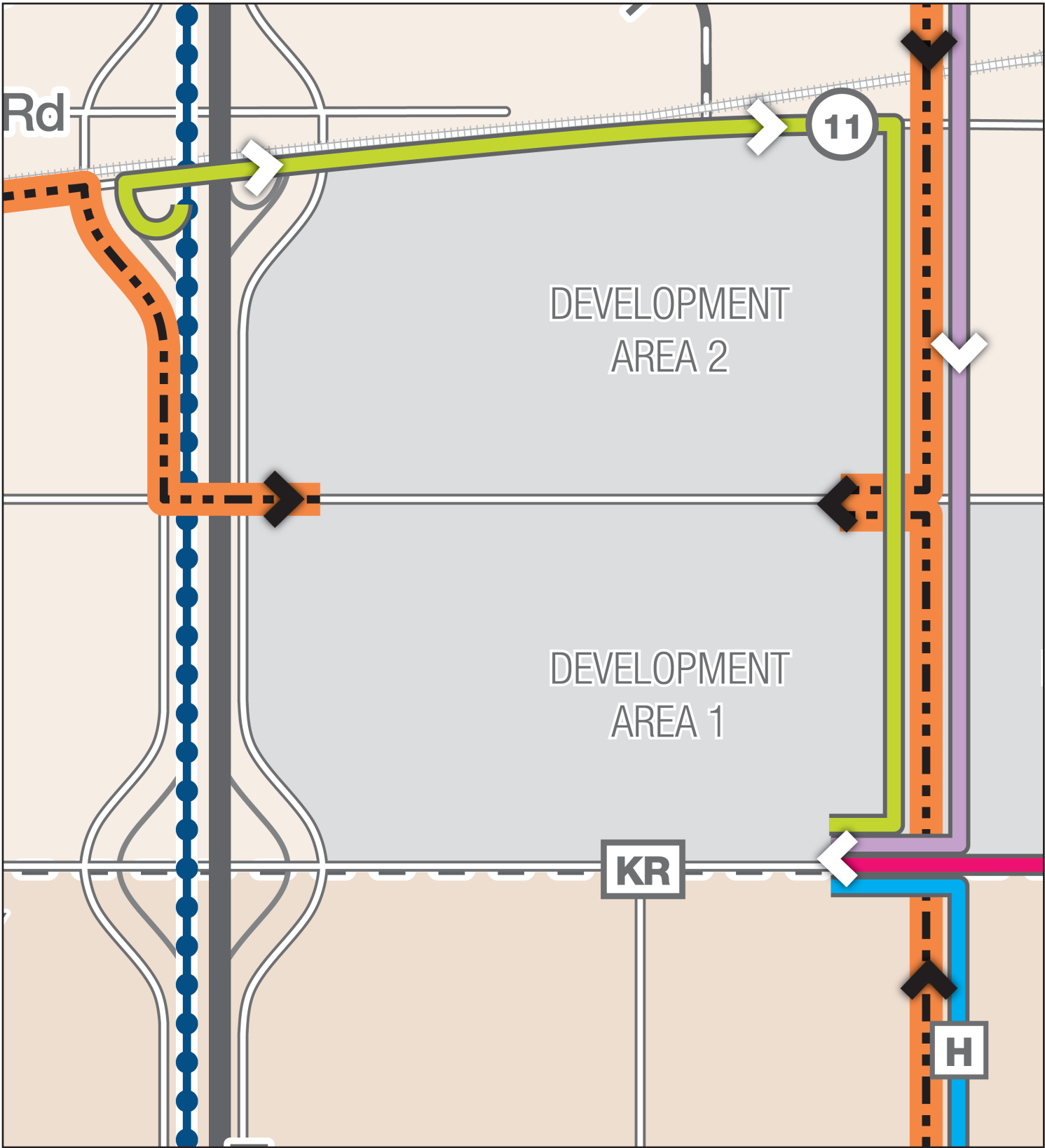

LEGEND

Freeway or development road construction

ACCESS ROUTES

General access route (workers)

Haul route
Return trips to the west shall use the controlled intersection at County H/WIS 11

CLOSURES

Roadway closed (under I-94 mainline)

Ramp closed (I-94 entrance/exit)

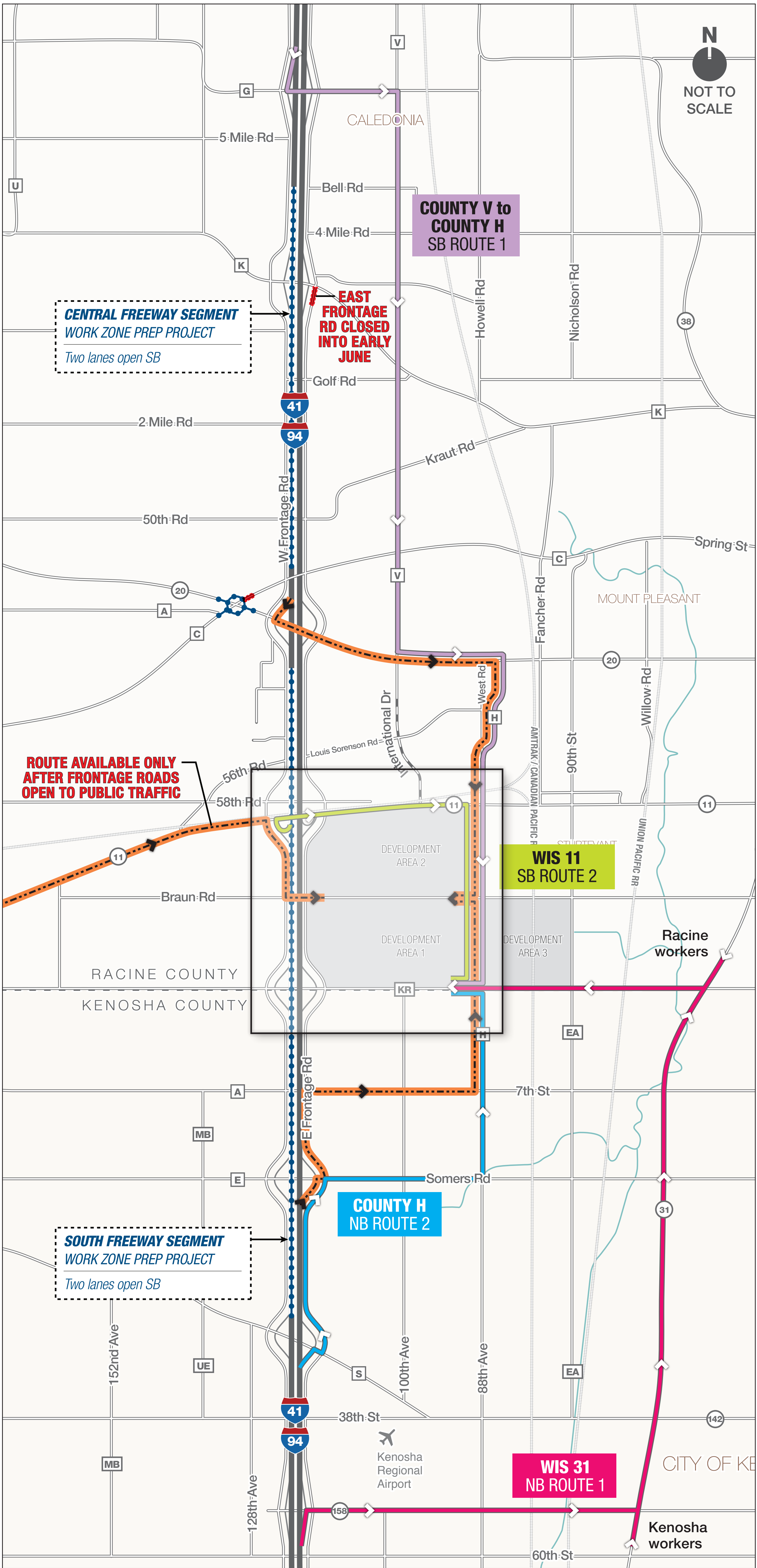

REGIONAL ROUTES to FOXCONN

June 18-July 31, 2018

WisDOT

- » Freeway NB reconstruction
- » Braun Rd EB reconstruction
- » International Dr NB construction

Foxconn

- » Continued mobilization
- » Site work, Phase 1a
- » LCM construction, Phase 1b

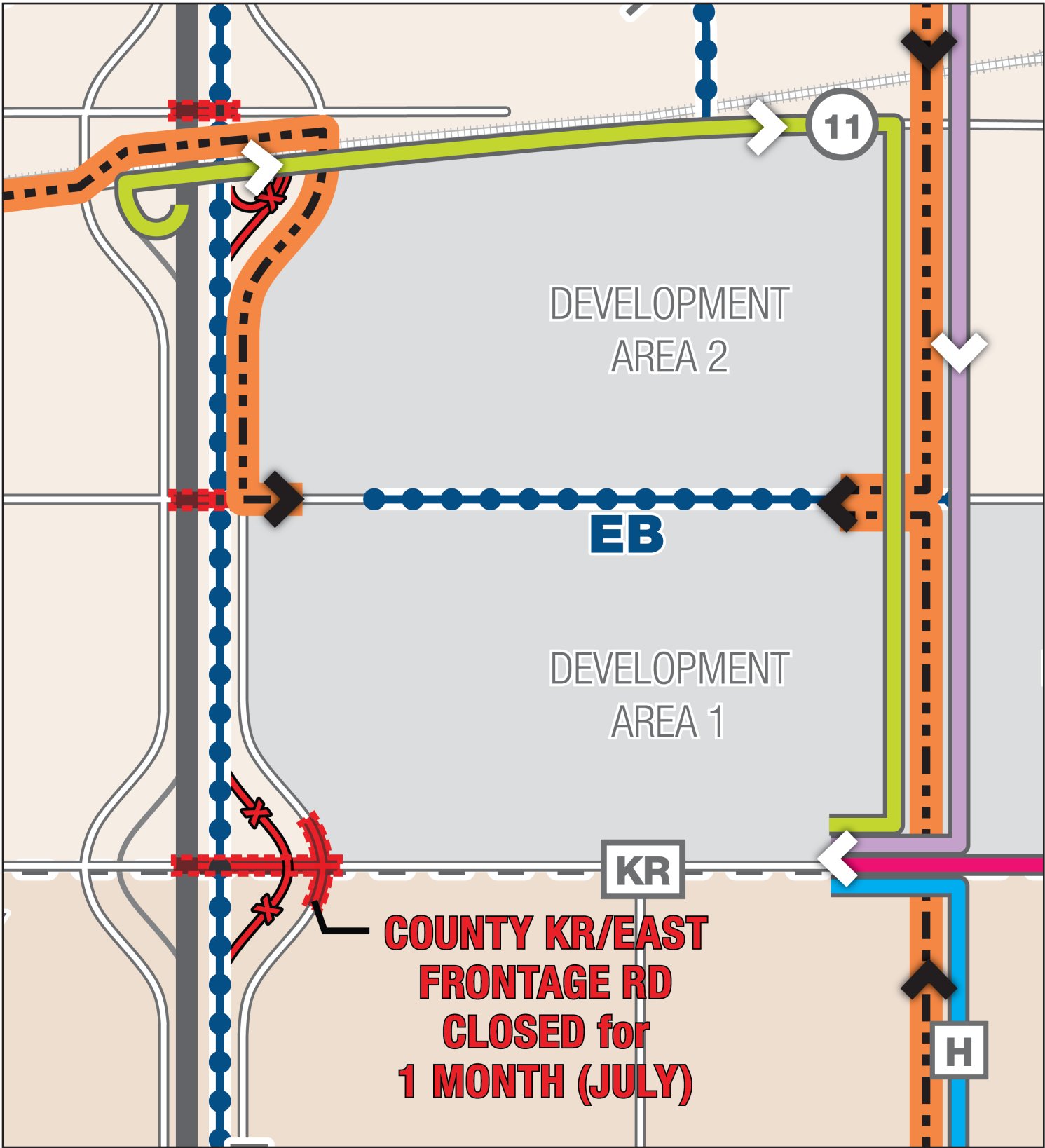

LEGEND

Freeway or development road construction

ACCESS ROUTES

General access route (workers)

Haul route
Return trips to the west shall use the controlled intersection at County H/WIS 11

CLOSURES

Roadway closed (under I-94 mainline)

Ramp closed (I-94 entrance/exit)



REGIONAL ROUTES to FOXCONN

August 1-August 30, 2018

WisDOT

- » Freeway NB reconstruction
- » Braun Rd box culvert reconstruction
- » Braun Rd EB reconstruction
- » International Dr NB construction

Foxconn

- » Continued mobilization
- » Site work, Phase 1a
- » LCM construction, Phase 1b

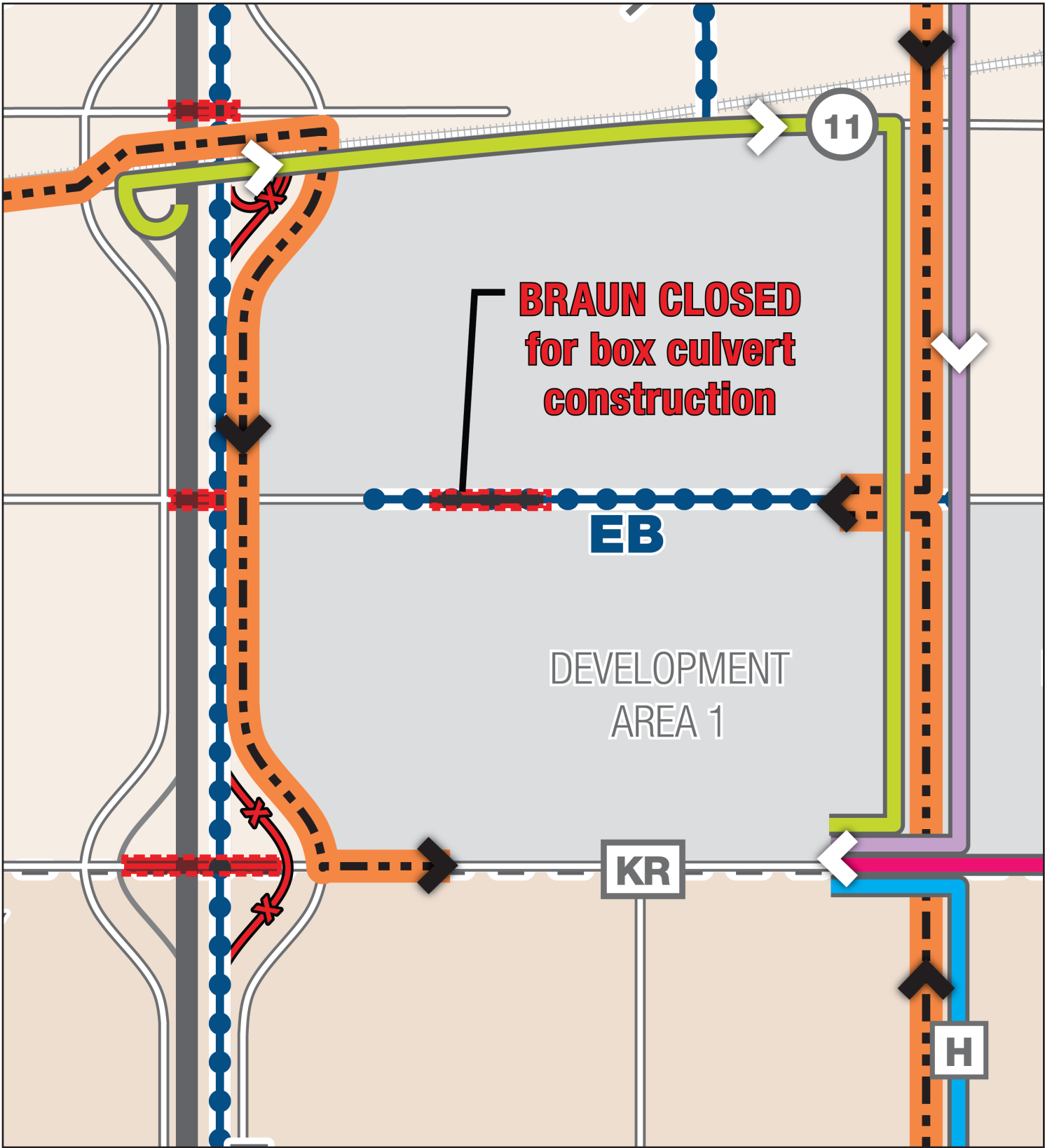

LEGEND

Freeway or development road construction

ACCESS ROUTES

- General access route (workers)
- Haul route
Return trips to the west shall use the controlled intersection at County H/WIS 11

CLOSURES

- Roadway closed (under I-94 mainline)
- Ramp closed (I-94 entrance/exit)

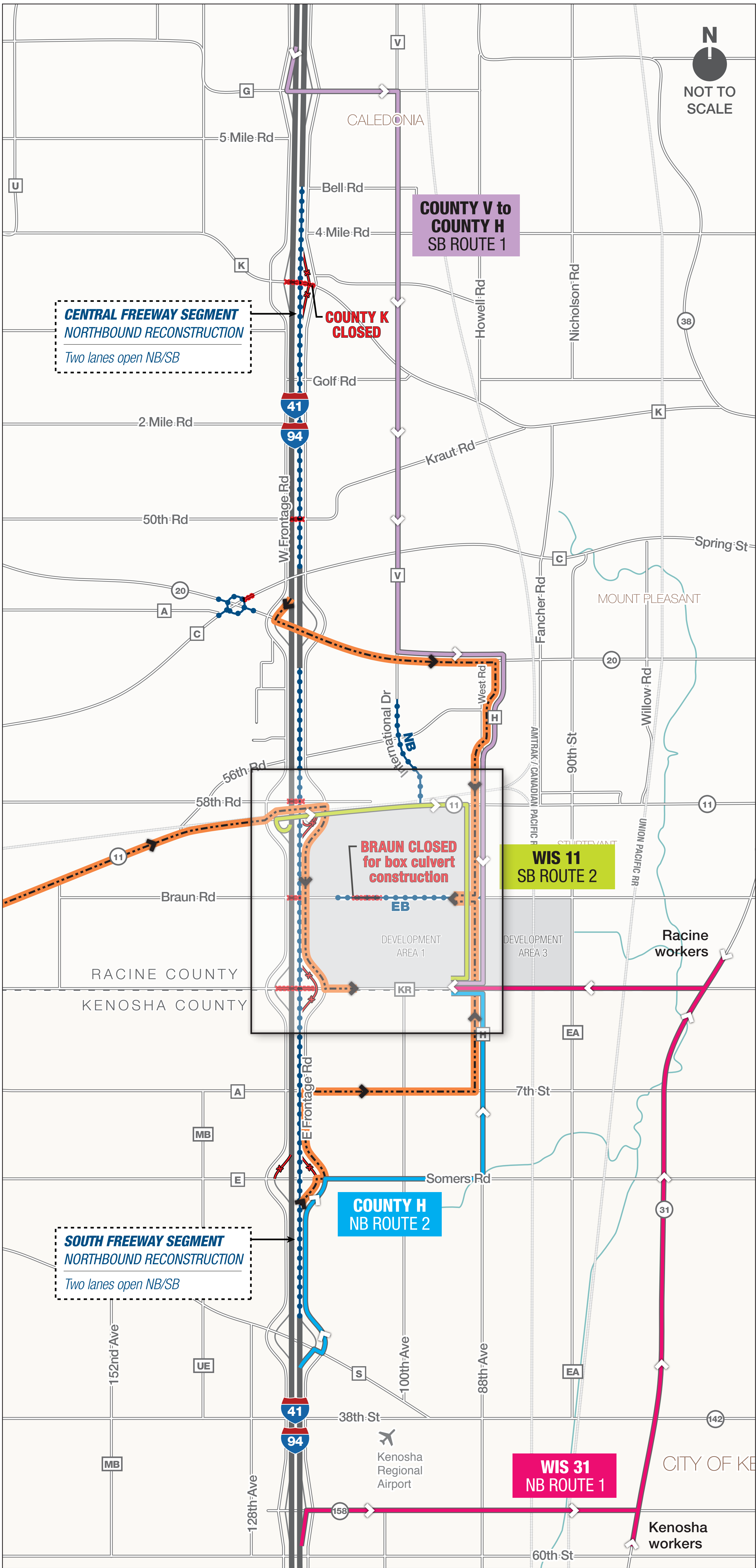

REGIONAL ROUTES to FOXCONN

September-November 2018

WisDOT

- » Freeway NB reconstruction
- » County KR box culvert construction
- » Braun Rd EB reconstruction
- » International Dr NB construction

Foxconn

- » Continued mobilization
- » Site work, Phase 1a
- » LCM construction, Phase 1b
- » Batch plant construction

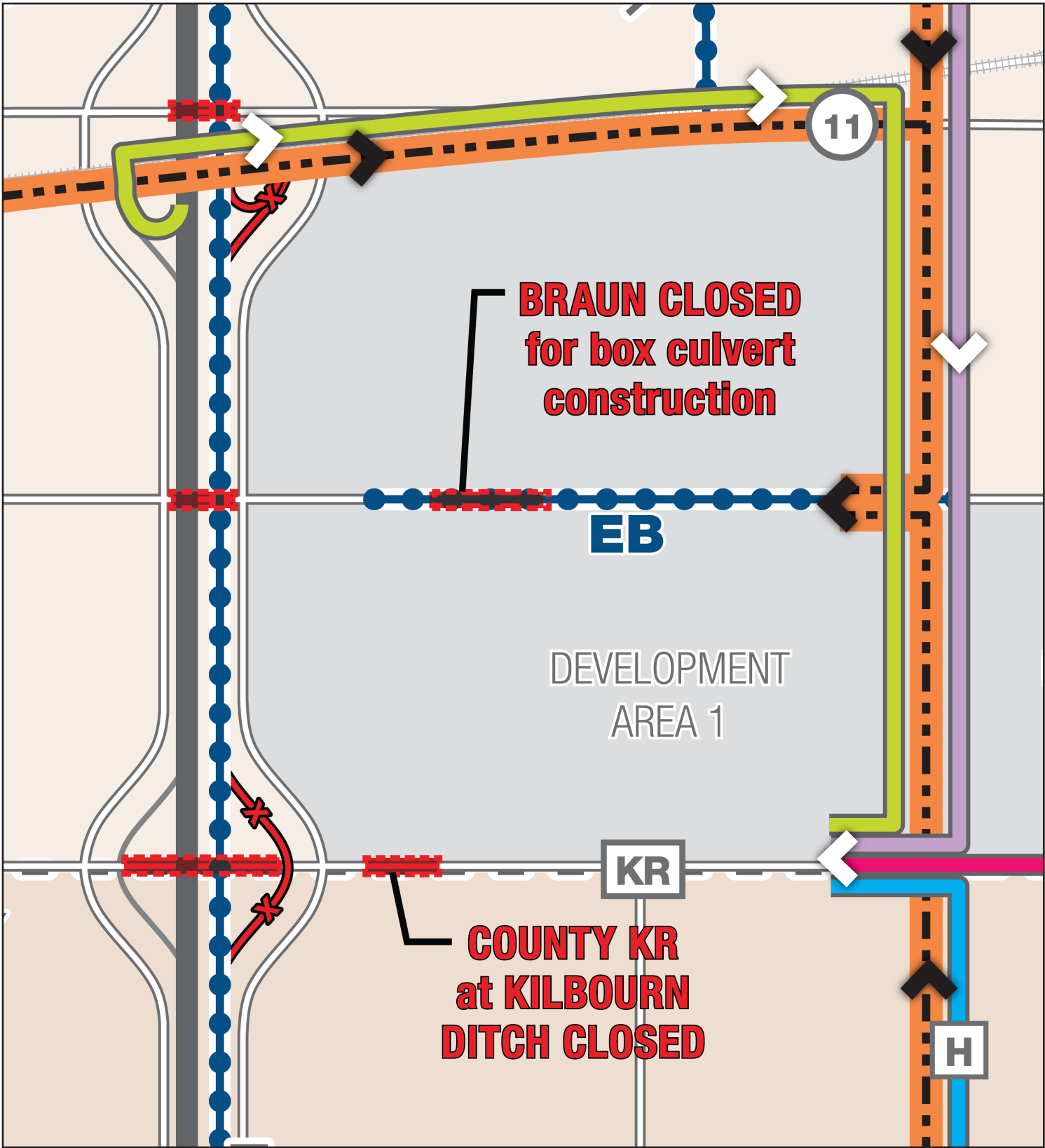

LEGEND

Freeway or development road construction

ACCESS ROUTES

General access route (workers)

Haul route
Return trips to the west shall use the controlled intersection at County H/WIS 11

CLOSURES

Roadway closed (under I-94 mainline)

Ramp closed (I-94 entrance/exit)

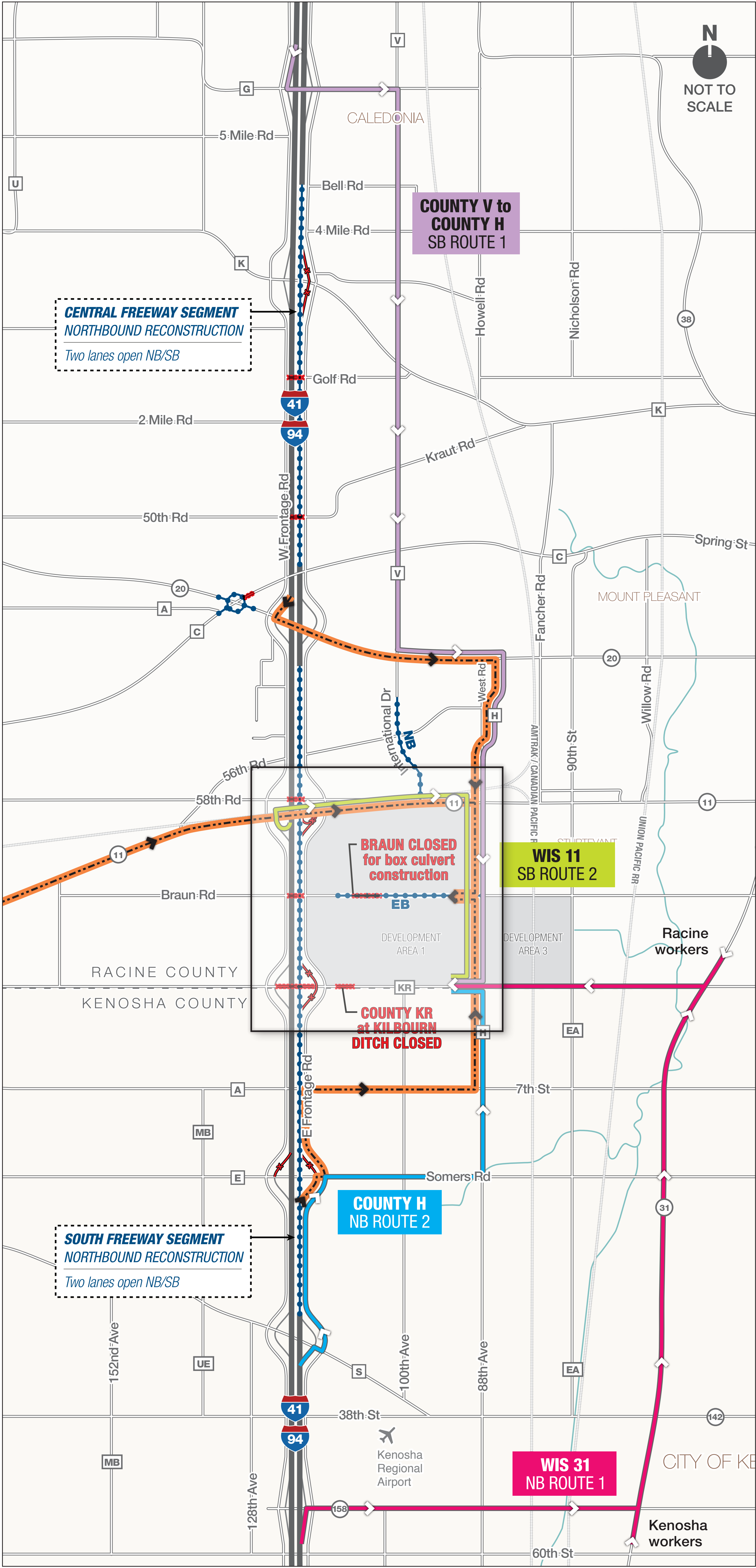

MAY 2018 | DRAFT

REGIONAL ROUTES to FOXCONN – PHASE 3

Winter 2018-Spring 2019 (December-May)

WisDOT

- » Freeway median reconstruction
- » Braun Rd EB & WB reconstruction
- » County KR EB & WB reconstruction
- » International Dr NB & SB construction

Foxconn

- » Permanent trucking LCM roadways (Q4 2018)
- » LCM ready for equipment (Q1 2019)
- » LCD manufacturing, Phase 1 (Q1 2019, foundations start)

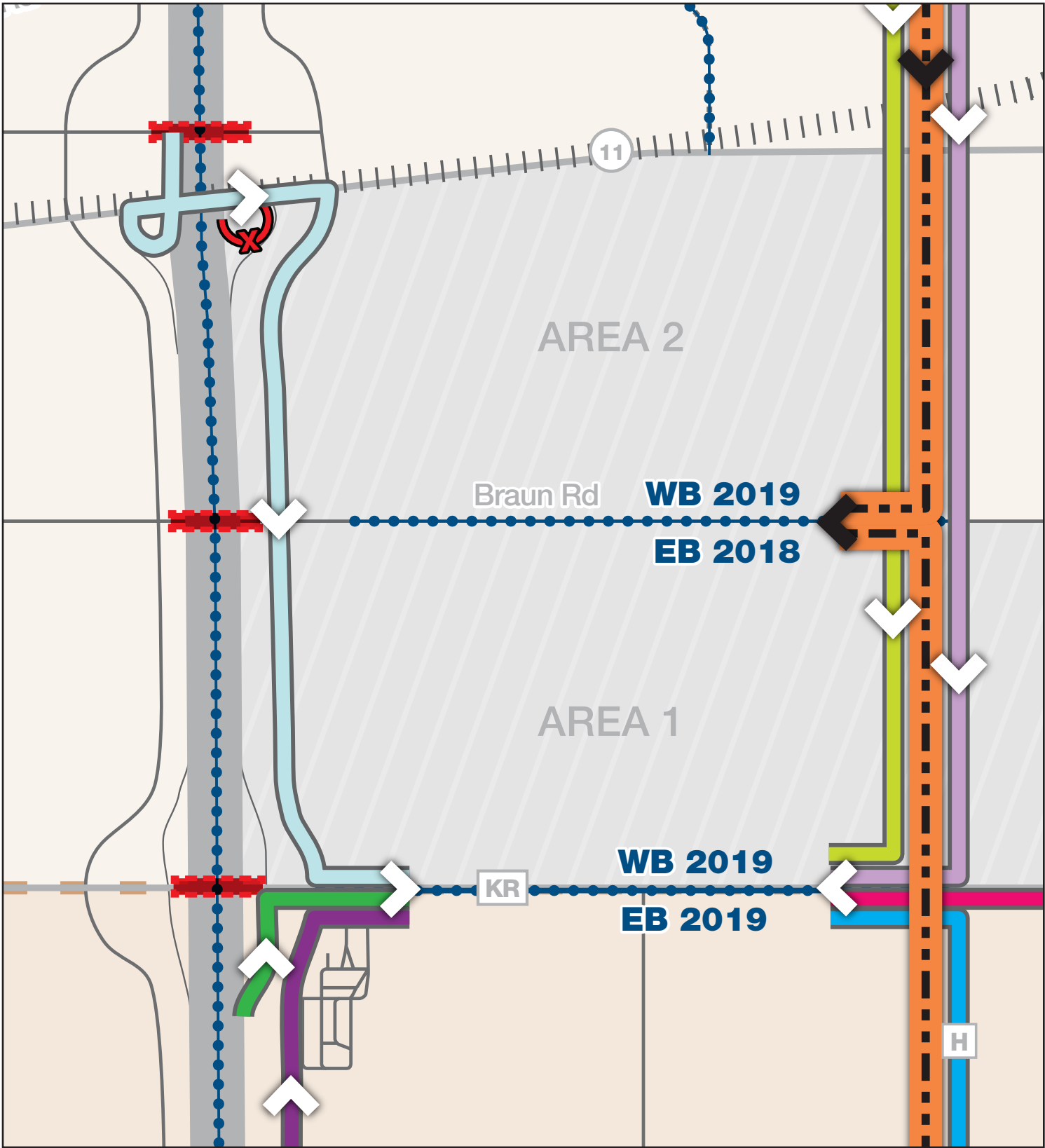

LEGEND

Freeway or development road construction

ACCESS ROUTES

- General access route (workers)
- Haul route
Return trips to the west shall use the controlled intersection at County H/WIS 11

CLOSURES

- Roadway closed (under I-94 mainline)
- Ramp closed (I-94 entrance/exit)

