

REGIONAL ROUTES to WISCONN VALLEY

November-December 2019

WisDOT

- » Mainline median reconstruction
- » County H reconstruction
- » WIS 11 reconstruction
- » Braun Rd reconstruction
- » County KR reconstruction
- » Wisconn Valley Way construction

Wisconn Valley

- » Internal roadways construction
- » Advanced display manufacturing facilities, Phase 1

LEGEND

- Freeway or development road construction (open to traffic)
- Roadway construction (closed to traffic)
- Ramp closed (I-94 entrance/exit)

ACCESS ROUTES

- General access route (Wisconn Valley workers)
- Wisconn Valley haul route
Includes but is not limited to all Wisconn Valley development hauling for aggregate, raw materials, construction equipment and manufacturing equipment.
- Open to traffic; closed to Wisconn Valley trucks

Requests for Wisconn Valley hauling on new routes require WisDOT approval. Click [HERE](#) for the request form.

UTILITY CONSTRUCTION (estimated timeframe)

- Sanitary sewer
- Water main
- Electric
- Communication
- Gas

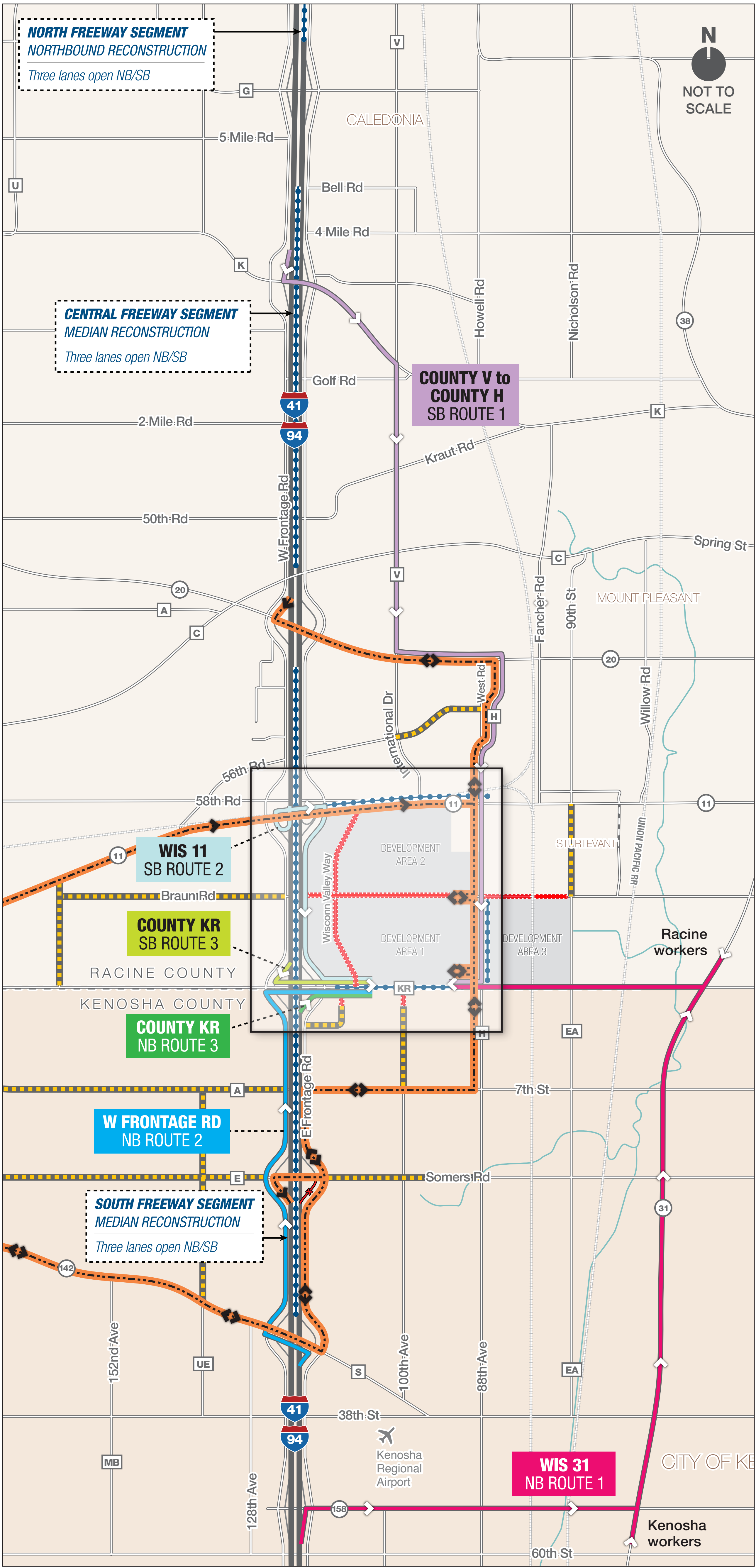
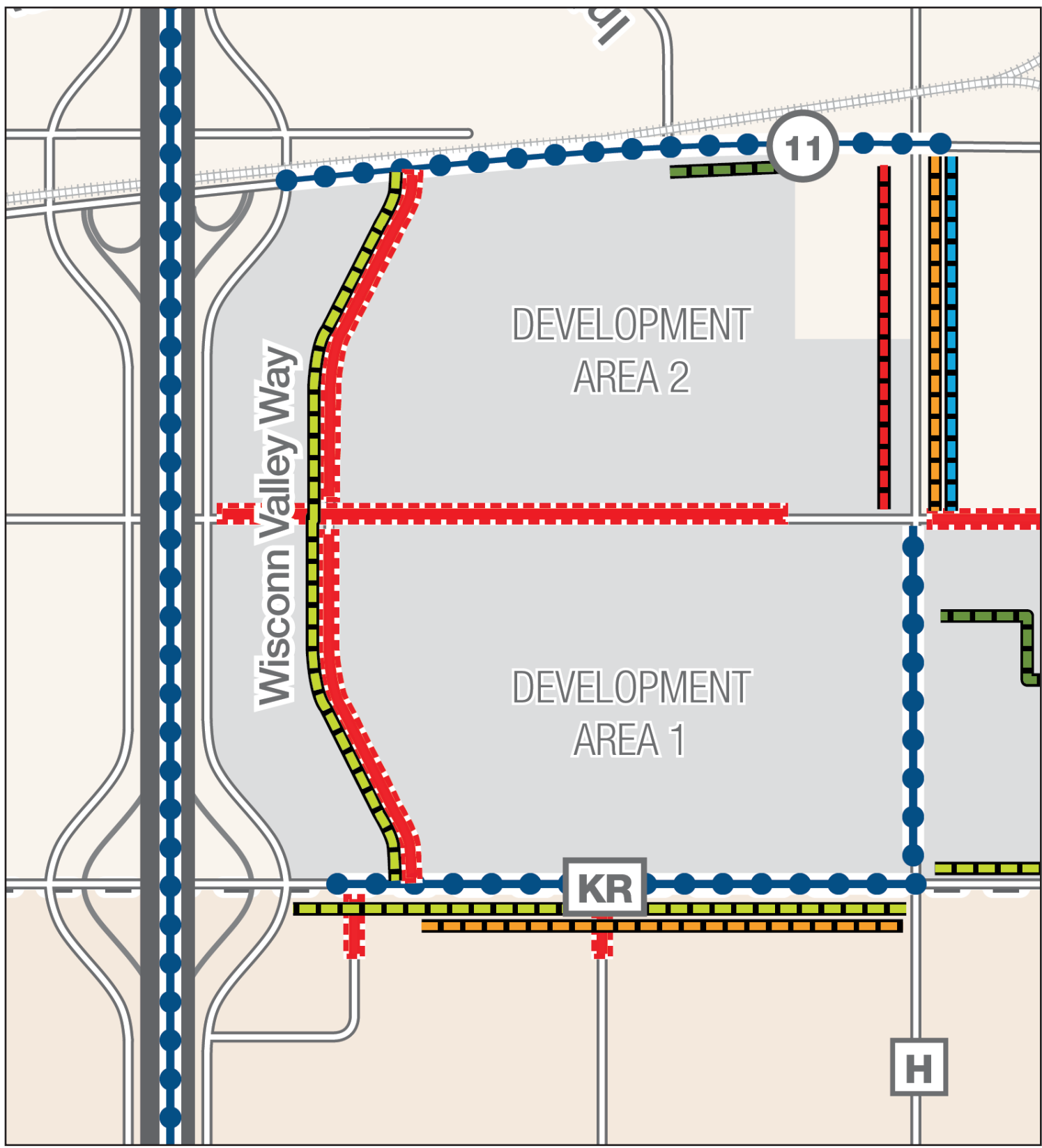

REGIONAL ROUTES to WISCONN VALLEY

January-August 2020

WisDOT

- » County H reconstruction
- » WIS 11 reconstruction
- » Braun Rd reconstruction
- » WIS 20 reconstruction

Wisconn Valley

- » Advanced display manufacturing facilities, Phase 1

LEGEND

- Freeway or development road construction (open to traffic)
- Roadway construction (closed to traffic)
- Ramp closed (I-94 entrance/exit)

ACCESS ROUTES

- General access route (Wisconn Valley workers)
- Wisconn Valley haul route
Includes but is not limited to all Wisconn Valley development hauling for aggregate, raw materials, construction equipment and manufacturing equipment.
- Open to traffic; closed to Wisconn Valley trucks

Requests for Wisconn Valley hauling on new routes require WisDOT approval. Click [HERE](#) for the request form.

UTILITY CONSTRUCTION (estimated timeframe)

- Sanitary sewer
- Water main
- Electric
- Communication
- Gas

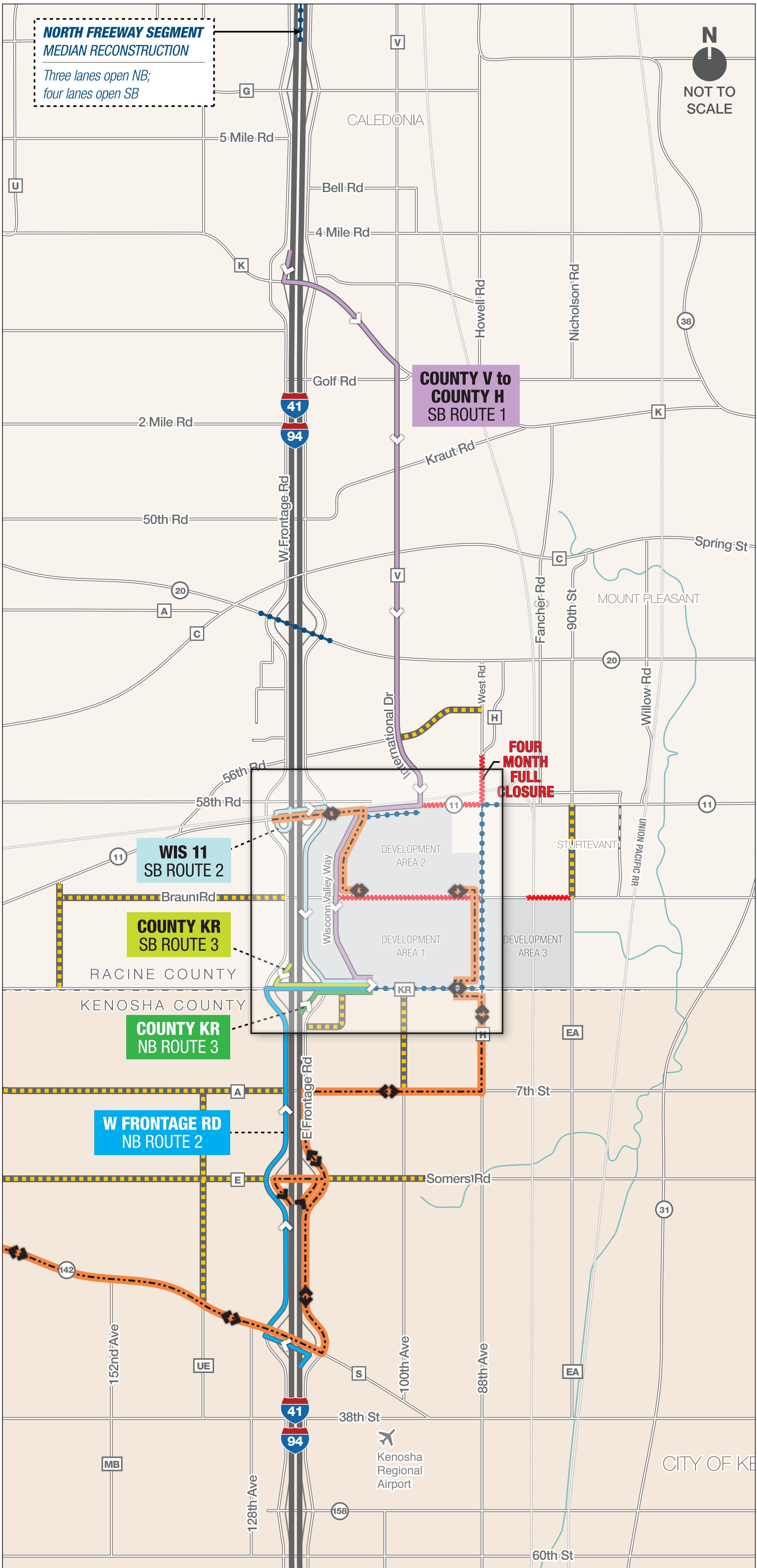
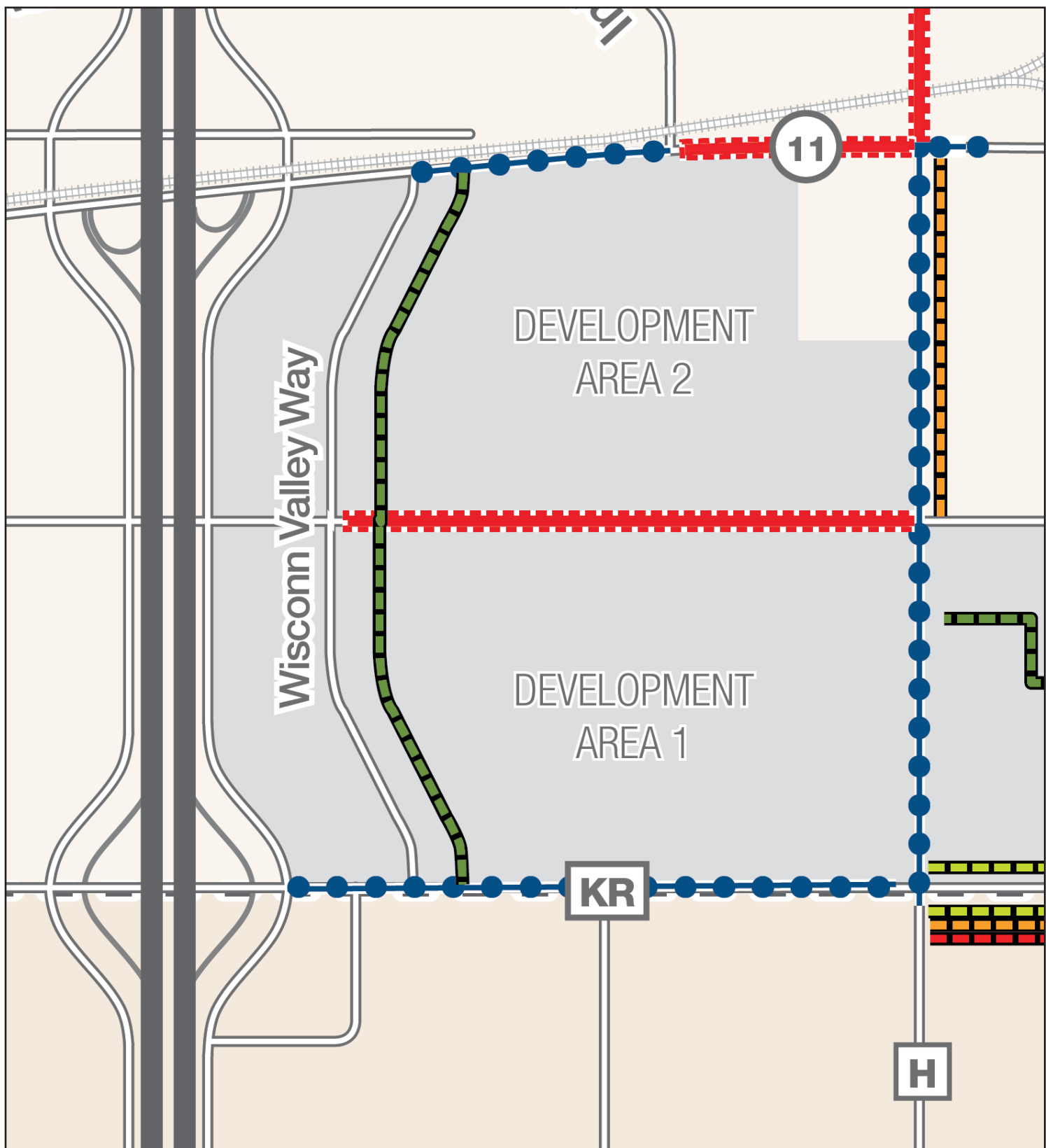

REGIONAL ROUTES to WISCONN VALLEY

September-December 2020

WisDOT

- » County H reconstruction
- » County KR reconstruction

Wisconn Valley

- » Advanced display manufacturing facilities, Phase 1

LEGEND

- Freeway or development road construction (open to traffic)
- Roadway construction (closed to traffic)
- Ramp closed (I-94 entrance/exit)

ACCESS ROUTES

- General access route (Wisconn Valley workers)
- Wisconn Valley haul route
Includes but is not limited to all Wisconn Valley development hauling for aggregate, raw materials, construction equipment and manufacturing equipment.
- Open to traffic; closed to Wisconn Valley trucks

Requests for Wisconn Valley hauling on new routes require WisDOT approval. Click [HERE](#) for the request form.

UTILITY CONSTRUCTION (estimated timeframe)

- Sanitary sewer
- Water main
- Electric
- Communication
- Gas

