

REGIONAL ROUTES to WISCONN VALLEY

August 1-August 30, 2018

WisDOT

- » Freeway NB reconstruction
- » Braun Rd box culvert reconstruction
- » Braun Rd EB reconstruction
- » International Dr NB construction

Wisconn Valley

- » Multipurpose building construction
- » Mass excavation and stormwater management

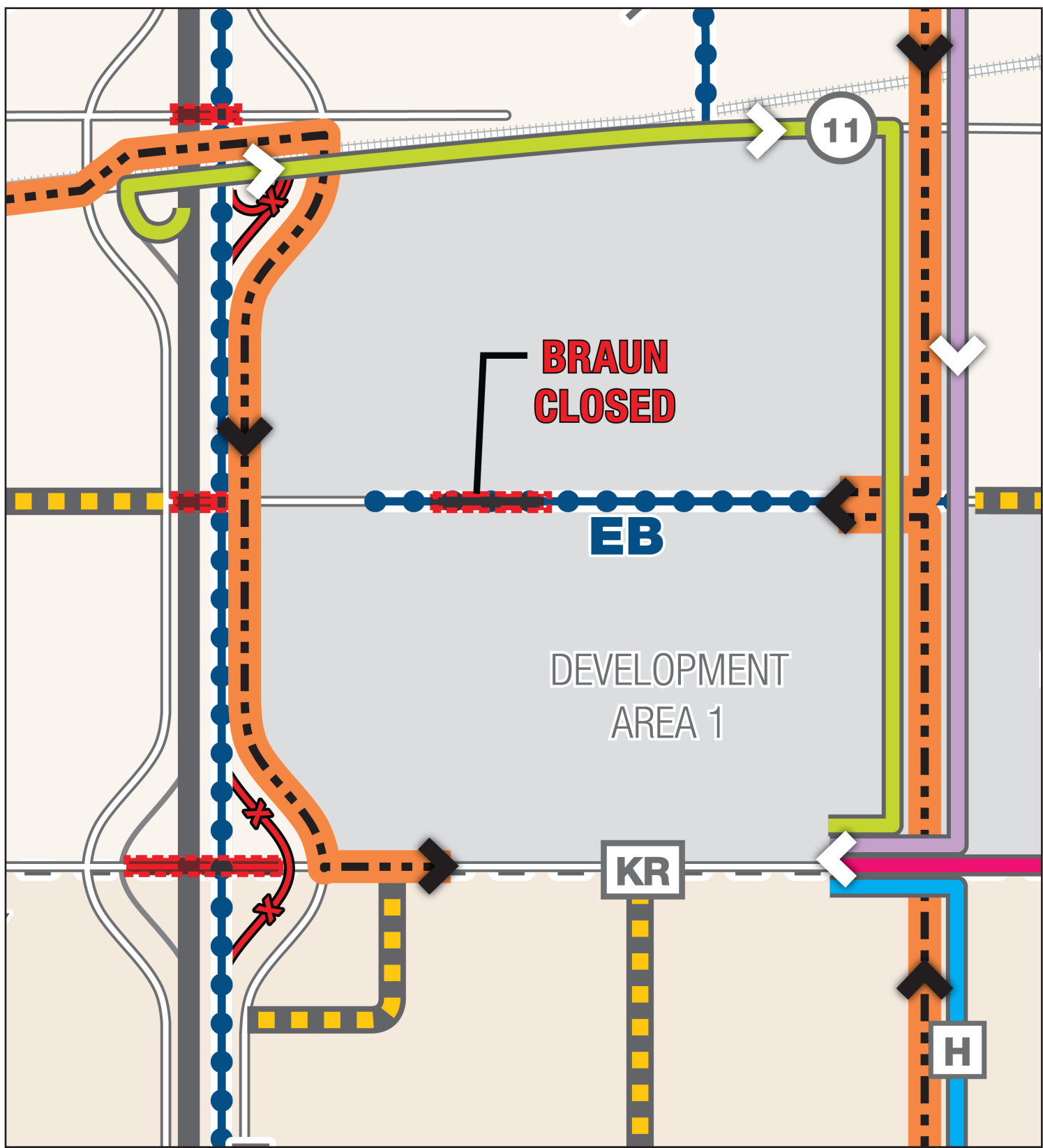

LEGEND

●●● Freeway or development road construction

ACCESS ROUTES

➡ General access route (Wisconn Valley workers)

➡ Wisconn Valley haul route
Return trips to the west shall use the controlled intersection at County H/WIS 11

▬ Open to traffic; closed to Wisconn Valley trucks

CLOSURES

▬ Roadway closed (under I-94 mainline)

▬ Ramp closed (I-94 entrance/exit)



AUGUST 3, 2018 | DRAFT

REGIONAL ROUTES to WISCONN VALLEY

September-November 2018

WisDOT

- » Freeway NB reconstruction
- » County KR box culvert construction
- » Braun Rd EB reconstruction
- » International Dr NB construction

Wisconn Valley

- » Multipurpose building construction
- » Mass excavation and stormwater management

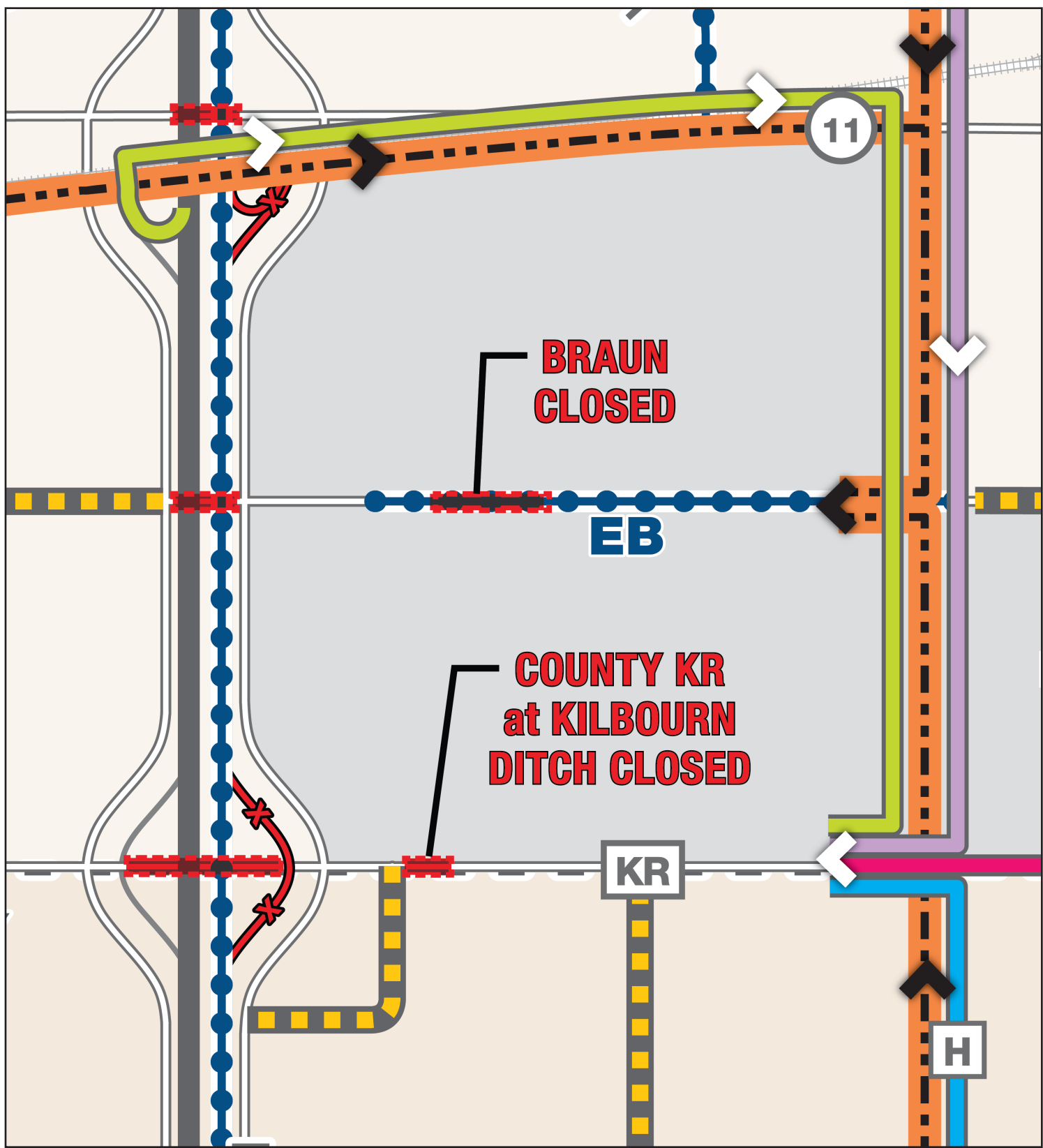

LEGEND

Freeway or development road construction

ACCESS ROUTES

General access route (Wisconn Valley workers)

Wisconn Valley haul route
Return trips to the west shall use the controlled intersection at County H/WIS 11

Open to traffic; closed to Wisconn Valley trucks

CLOSURES

Roadway closed (under I-94 mainline)

Ramp closed (I-94 entrance/exit)

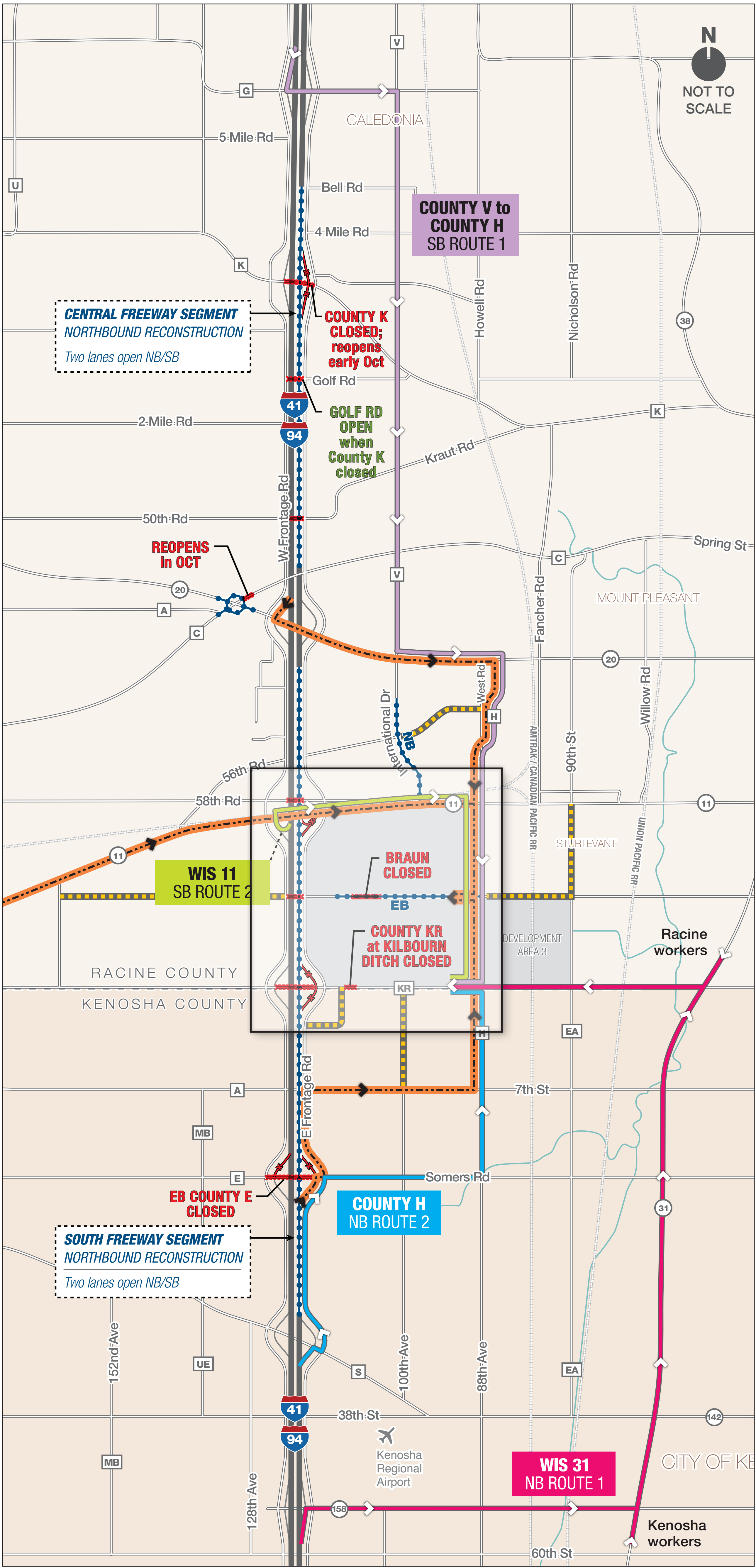

AUGUST 3, 2018 | DRAFT

REGIONAL ROUTES to WISCONN VALLEY

December 2018-January 2019

WisDOT

- » Freeway median reconstruction
- » Braun Rd EB & WB reconstruction
- » International Dr NB & SB construction

Wisconn Valley

- » Multipurpose building construction
- » Mass excavation and stormwater management

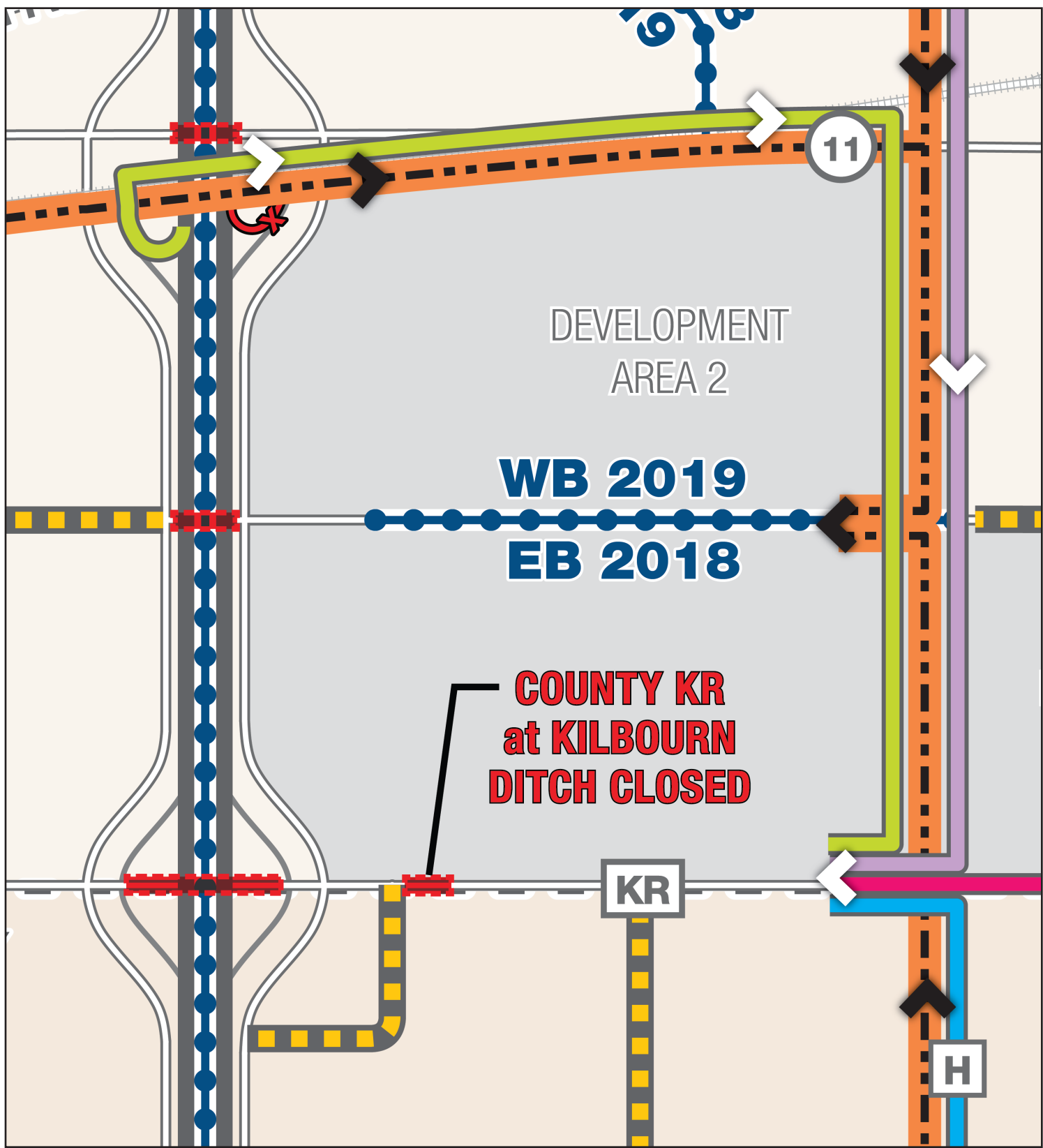

LEGEND

Freeway or development road construction

ACCESS ROUTES

- General access route (Wisconn Valley workers)
- Wisconn Valley haul route
Return trips to the west shall use the controlled intersection at County H/WIS 11
- Open to traffic; closed to Wisconn Valley trucks

CLOSURES

- Roadway closed (under I-94 mainline)
- Ramp closed (I-94 entrance/exit)

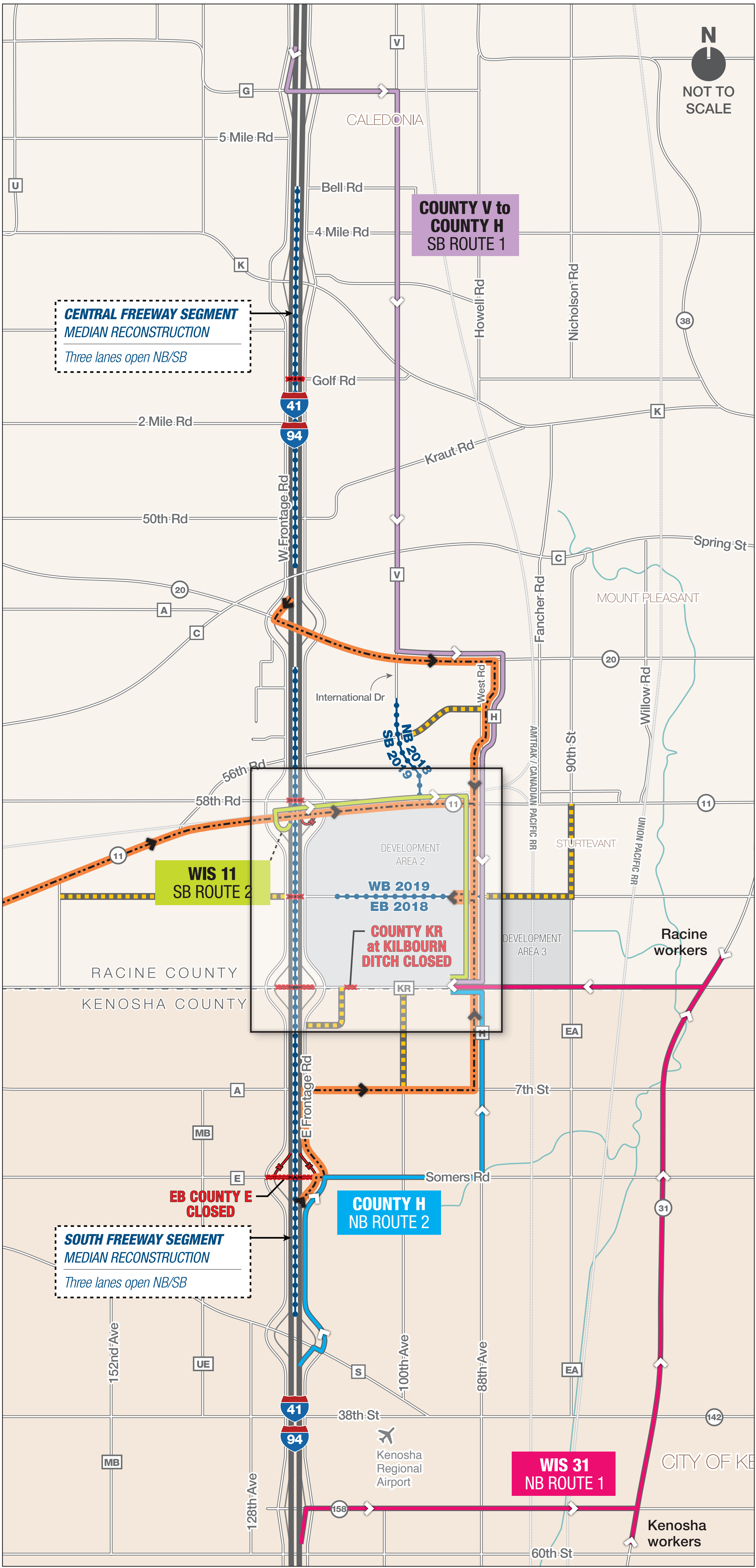

AUGUST 3, 2018 | DRAFT

REGIONAL ROUTES to WISCONN VALLEY

February-April 2019

WisDOT

- » Freeway median reconstruction
- » WIS 11 EB reconstruction
- » Braun Rd EB & WB reconstruction
- » County KR EB & WB reconstruction
- » International Dr NB & SB construction
- » Wisconn Valley Way construction

Wisconn Valley

- » Multipurpose building construction
- » Mass excavation and stormwater management
- » Advanced display manufacturing facilities, Phase 1

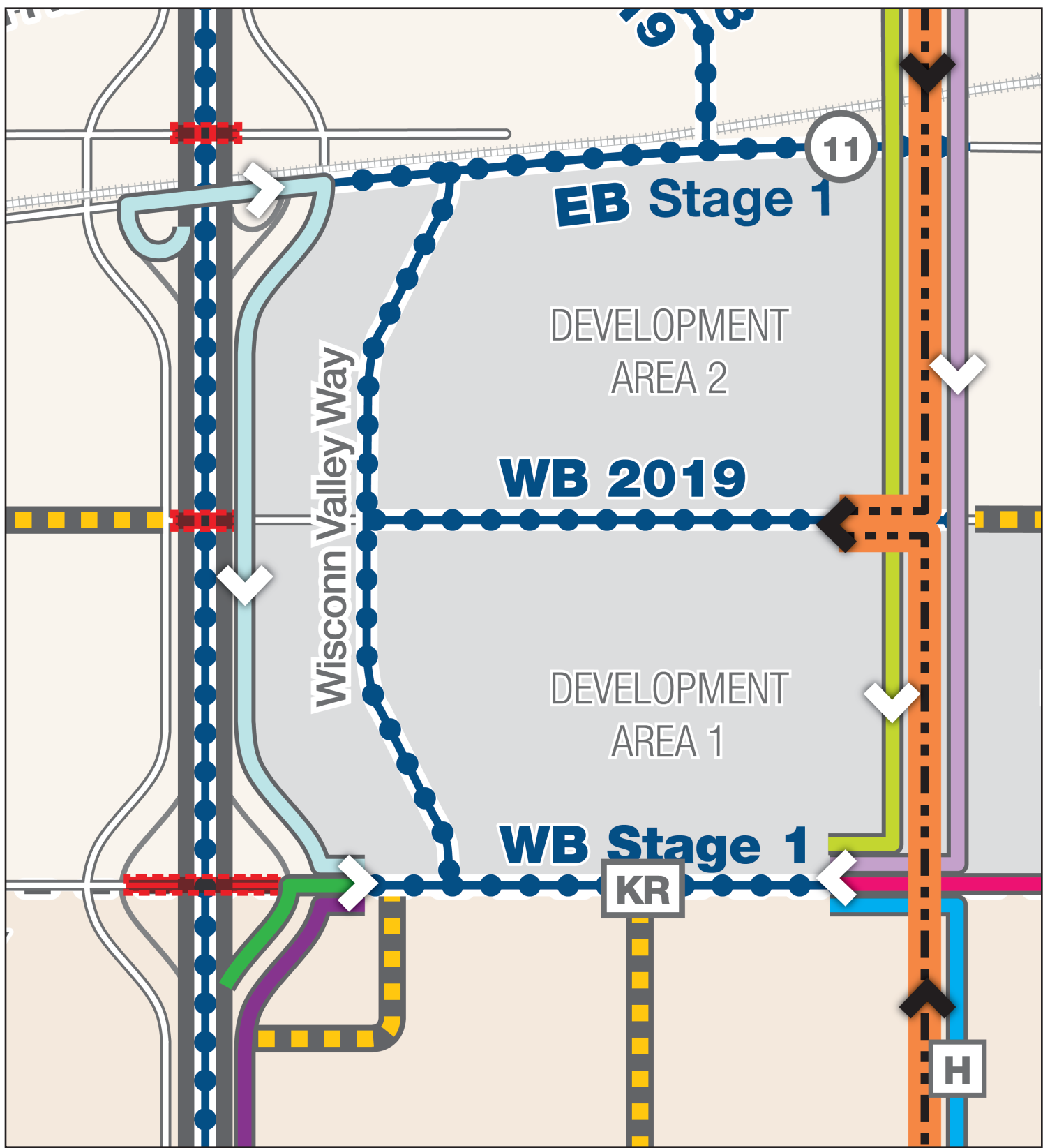

LEGEND

Freeway or development road construction

ACCESS ROUTES

- General access route (workers)
- Haul route
Return trips to the west shall use the controlled intersection at County H/WIS 11
- Open to traffic; closed to trucks

CLOSURES

- Roadway closed (under I-94 mainline)
- Ramp closed (I-94 entrance/exit)



AUGUST 3, 2018 | DRAFT

REGIONAL ROUTES to WISCONN VALLEY

May-November 2019

WisDOT

- » Mainline SB reconstruction
- » WIS 11 EB & WB reconstruction
- » Braun Rd WB reconstruction
- » County KR EB/WB reconstruction
- » Wisconn Valley Way construction

Wisconn Valley

- » Mass excavation and stormwater management
- » Advanced display manufacturing facilities, Phase 1

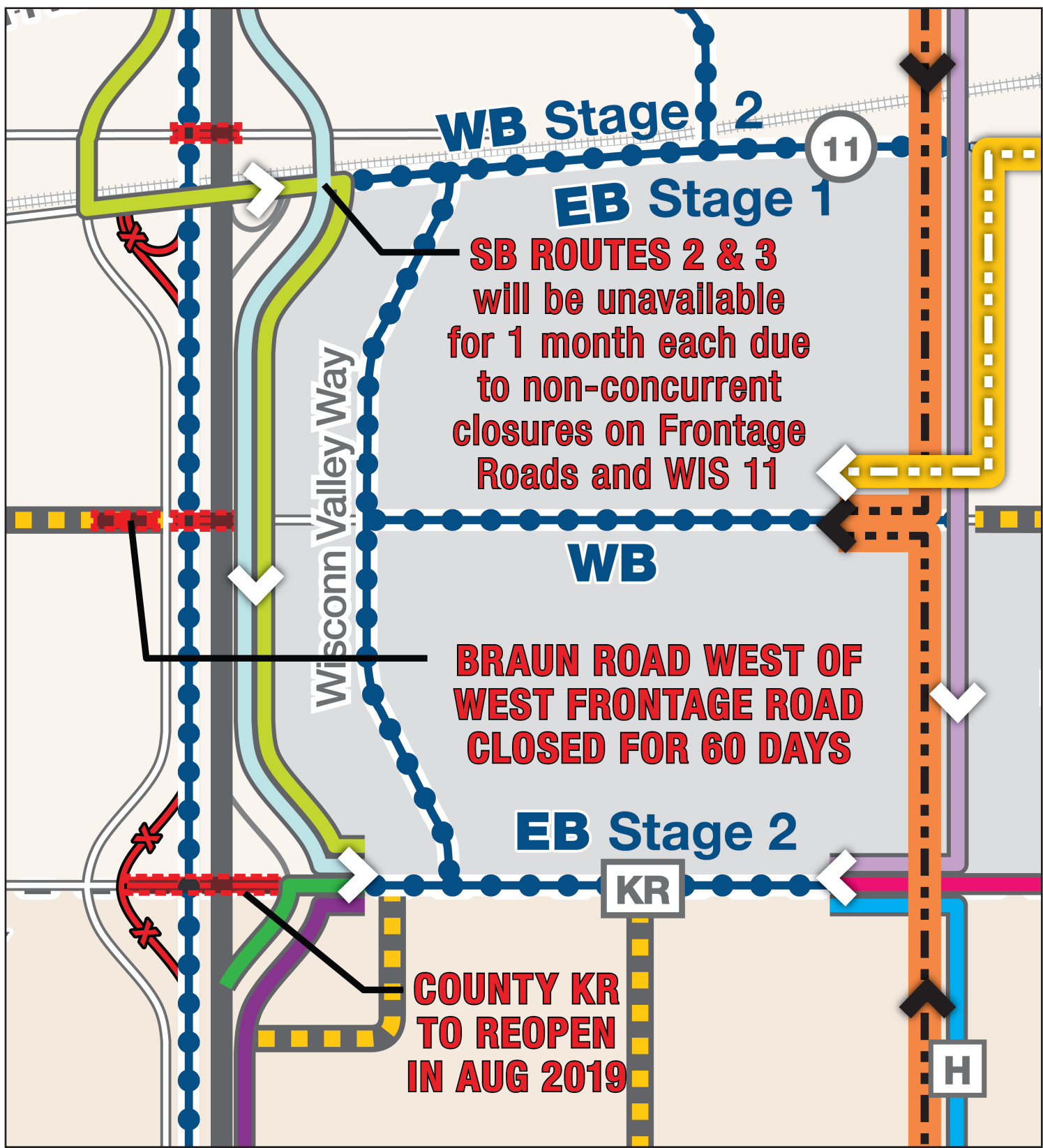

LEGEND

Freeway or development road construction

ACCESS ROUTES

General access route (Wisconn Valley workers)

Wisconn Valley haul route

Overheight route

Open to traffic; closed to Wisconn Valley trucks

CLOSURES

Roadway closed (under I-94 mainline)

Ramp closed (I-94 entrance/exit)

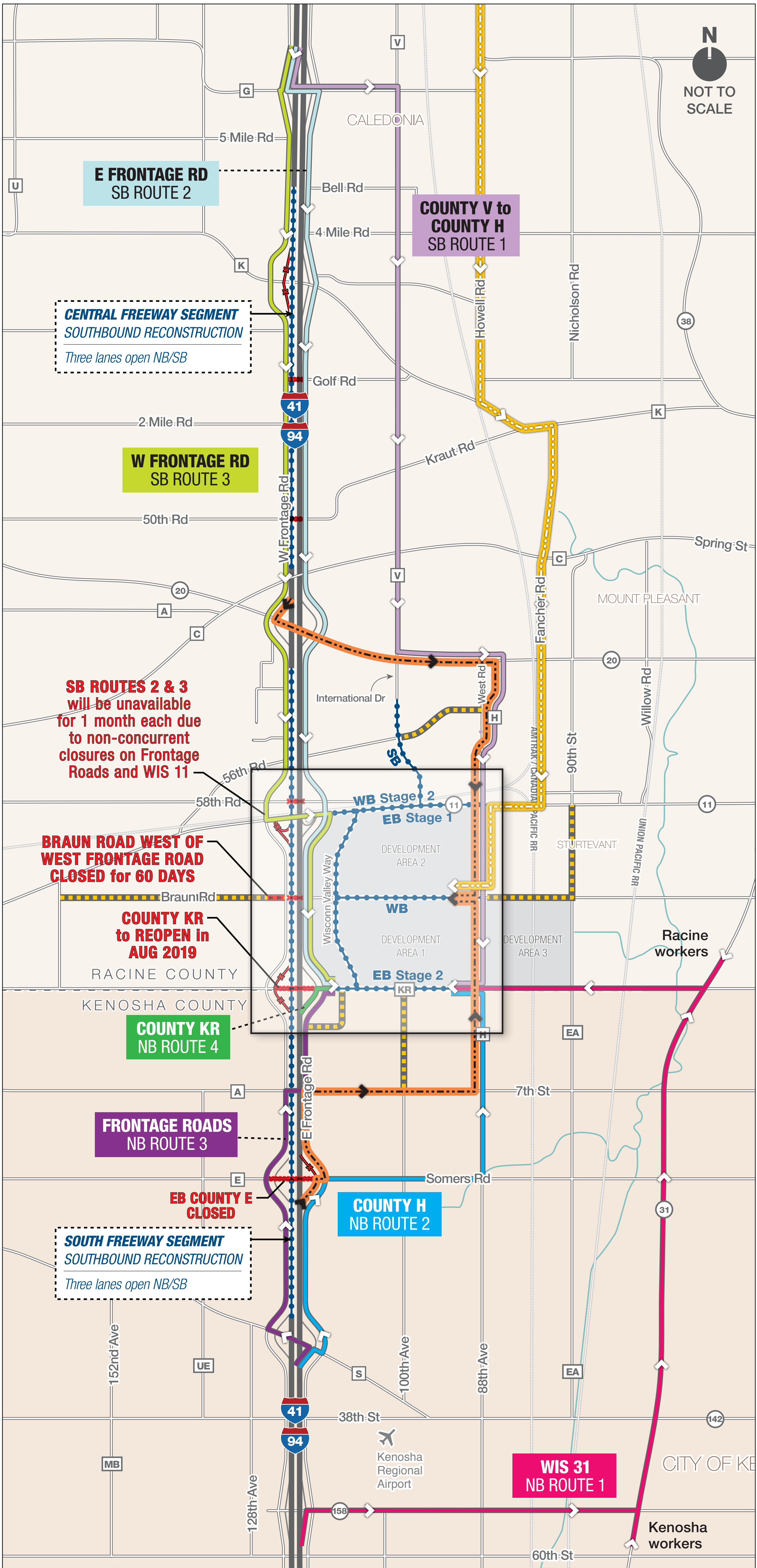

AUGUST 3, 2018 | DRAFT



projects.511wi.gov/fdr/

